

PHILIPS ADVANCE

Metal
Halide
Lamp Ballast

Catalog Number 78E6041
For 400W M59
60 Hz CWA
Status: Active

DIMENSIONS AND DATA

78E
INDOOR
ENCLOSED
DIMENSIONS

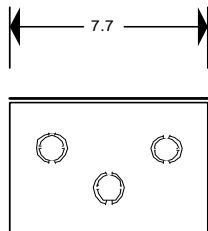

Top view
3 double
7/8" and 1 1/8"
knockouts

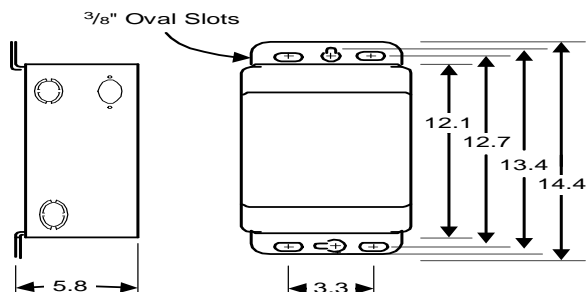

Capacitor:

The capacitor is included as
part of the potted assembly.

Ignitor: NA

This ballast does not
require the use of an ignitor.

INPUT VOLTS	480				
CIRCUIT TYPE	CWA				
POWER FACTOR (min)	90%				
REGULATION					
Line Volts	±10%				
Lamp Watts	±10%				
LINE CURRENT (Amps)					
Operating.....	1.00				
Open Circuit.....	0.75				
Starting.....	0.90				
UL TEMPERATURE RATINGS					
Insulation Class	H(180°C)				
Coil Temperature Code	1029				
MIN. AMBIENT STARTING TEMP.	-20°F or -30°C				
NOM. OPEN CIRCUIT VOLTAGE	300				
INPUT VOLTAGE AT LAMP DROPOUT.....	240				
INPUT WATTS	462				
RECOMMENDED FUSE (Amps).....	3				
CORE and COIL					
Dimension (A)					
Dimension (B)					
Weight (lbs.)	26				
Lead Lengths	12"				
CAPACITOR REQUIREMENT					
Microfarads					
Volts (min.)					
Fault Current Withstand (amps)					
60 Hz TEST PROCEDURES (Refer to Advance Test Procedure for HID Ballasts - Form 1270)					
High Potential Test (Volts)					
1 minute	2000				
2 seconds	2500				
Open Circuit Voltage Test (Volts)	270-330				
Short-Circuit Current Test (Amps)					
Secondary Current	3.50-4.30				
Input Current.....	0.60-0.95	-	-	-	-



Wiring Diagram:

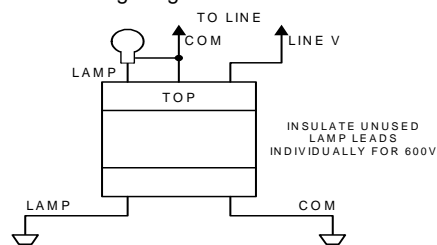

Fig. IE -1

Ordering Information

Order Suffix

Description

Data is based upon tests performed by Philips Lighting Electronic N.A. in a controlled environment and representative of relative performance. Actual performance can vary depending on operating conditions. Specifications are subject to change without notice.

Philips Lighting Electronic N.A.

10275 West Higgins Road · Rosemont, IL 60018 · Tel:800-322-2086 Fax:888-432-1882
Customer Support/ Technical Service:800-372-3331 · OEM Support: 866-915-5886

03/19/98