

**PHILIPS  
ADVANCE**

**Metal  
Halide  
Lamp Ballast**

**Catalog Number 73B6091A  
For 400W M59  
60 Hz CWA  
Status: Active**

**DIMENSIONS AND DATA**

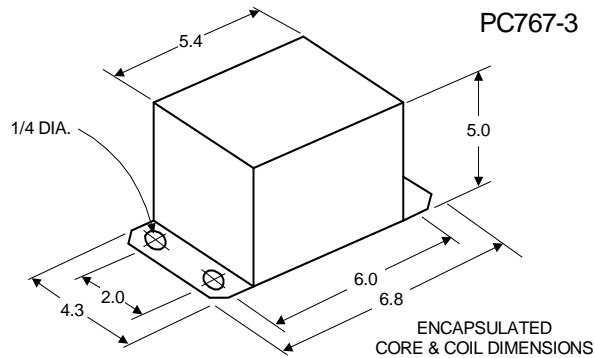

INPUT VOLTS	120	208	240	277	
CIRCUIT TYPE	CWA				
POWER FACTOR (min)	90%				
REGULATION					
Line Volts	±10%				
Lamp Watts	±10%				
LINE CURRENT (Amps)					
Operating.....	4.00	2.30	2.00	1.75	
Open Circuit.....	3.00	1.80	1.50	1.30	
Starting.....	3.25	1.90	1.65	1.45	
UL TEMPERATURE RATINGS					
Insulation Class	H(180°C)				
Coil Temperature Code	1029				
	D	E	D	E	
MIN. AMBIENT STARTING TEMP.	-20°F or -30°C				
NOM. OPEN CIRCUIT VOLTAGE	305				
INPUT VOLTAGE AT LAMP DROPOUT.....	50	85	100	120	
INPUT WATTS	455				
RECOMMENDED FUSE (Amps).....	10	7	5	5	
CORE and COIL					
Dimension (A)					
Dimension (B)					
Weight (lbs.)	18				
Lead Lengths	12"				
CAPACITOR REQUIREMENT					
Microfarads	24.0				
Volts (min.)	400				
Fault Current Withstand (amps)					
60 Hz TEST PROCEDURES (Refer to Advance Test Procedure for HID Ballasts - Form 1270)					
High Potential Test (Volts)					
1 minute	2000				
2 seconds	2500				
Open Circuit Voltage Test (Volts)	275-335				
Short-Circuit Current Test (Amps)					
Secondary Current	3.40-4.20				
Input Current.....	2.55-3.80	1.45-2.20	1.30-1.90	1.10-1.65	-

Capacitor: 7C240P40-R



Capacitance: 24  
Dia/Oval Dim: 1.75  
Height: 4.8  
Temp Rating: 105°C

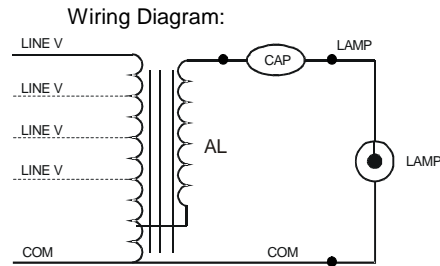

Fig. A1

**Ordering Information**

Order Suffix	Description

Ignitor: NA

This ballast does not require the use of an ignitor.

Data is based upon tests performed by Philips Lighting Electronic N.A. in a controlled environment and representative of relative performance. Actual performance can vary depending on operating conditions. Specifications are subject to change without notice.

**Philips Lighting Electronic N.A.**

10275 West Higgins Road · Rosemont, IL 60018 · Tel:800-322-2086 Fax:888-432-1882  
Customer Support/ Technical Service:800-372-3331 · OEM Support: 866-915-5886

09/14/11