



SV16 Series

6V 11W

120/277V 60Hz Emergency Luminaire

Damp Location Standard

Wet Loc. / Battery Heater Optional



INSTALLATION AND OPERATING INSTRUCTIONS

IMPORTANT SAFEGUARDS

When using electrical equipment, basic safety precautions should always be followed, including the following:

READ AND FOLLOW ALL SAFETY INSTRUCTIONS

All servicing should be performed by qualified personnel only.

Equipment should be mounted in locations and at heights where it will not be readily subjected to tampering by unauthorized personnel.

The use of accessory equipment not recommended by the manufacturer may cause an unsafe condition.

Do not use this equipment for other than intended use.

Do not let power supply cords touch hot surfaces.

Do not mount near gas or electric heaters.

CAUTION: Halogen cycle lamp(s) are used in this equipment. To avoid shattering: Do not operate lamp in excess of rated voltage, protect lamp against abrasion and scratches and against liquids when lamp is operating, dispose of lamp with care.

Halogen cycle lamps operate at high temperatures. Do not store or place flammable materials near lamp.

CAUTION: “To avoid electrical overload, total connected lamp load (factory and field installed) should not exceed output rating”.

Do not use this equipment for other than intended use.

SAVE THESE INSTRUCTIONS

WARNING – Shut off AC power to branch circuits to which units will be connected. All wiring should be per National Electrical Code and local regulations.



Philips Lighting North America Corporation
200 Franklin Square Drive
Somerset, NJ 08873, USA
Phone: 855-486-2216
www.philips.com/luminaires

Philips Lighting Canada Ltd.
281 Hillmount Road,
Markham, ON, Canada L6C 2S3
Phone: 800-668-9008
www.philips.com/luminaires

9140052682 February 2016

Installation

(1): For junction box mounting (wet or damp location units) – Remove large center knockout for wiring access and remove necessary mounting knockouts. Fasten backplate to junction box using two #8-32x1-1/4” screws supplied. For wet location units, ensure that the gasket is evenly compressed around perimeter.

For installation using surface conduit (damp location units only) – Remove necessary mounting knockouts and secure conduit to flange provided at top of backplate. Mount backplate to wall using mounting hardware supplied by others.

Connect AC Harness found in electronics module to AC supply. Refer to hookup instructions below:

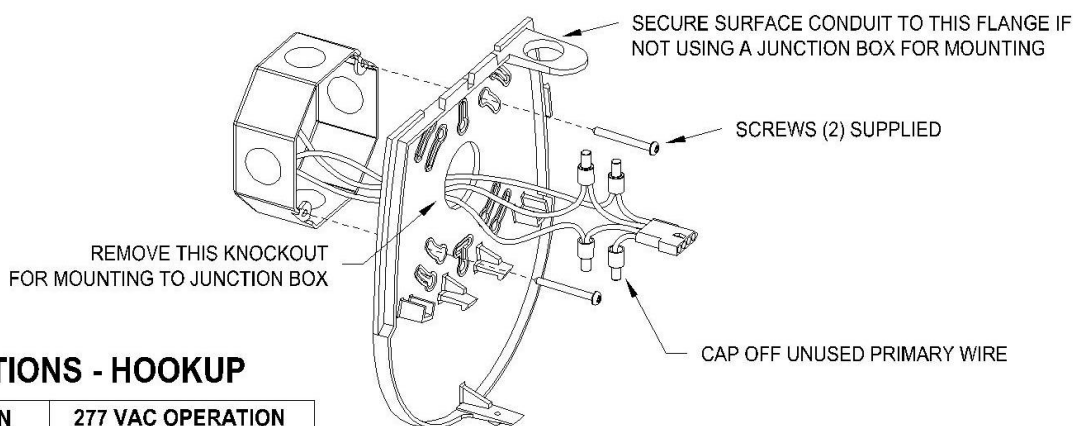

INSTRUCTIONS - HOOKUP

120 VAC OPERATION

White Wire - Common
Black Wire - 120V Line
Green Wire - Ground

277 VAC OPERATION

White Wire - Common
Blue Wire - 277V Line
Green Wire - Ground

Unused primary wire must be insulated to prevent shorting

(2): If battery heater option has been ordered, installer must finish wiring heater according to installation voltage. All connections are to be made inside electronics module.

Wiring heater for 120V operation -

Attach one wire tap to yellow wire from battery heater and one wire tap to black AC wire (wire taps are provided). Locate the two wires coming from the battery heater assembly (blue and black). Plug black wire into wire tap on black AC wire. Plug blue wire into wire tap on yellow wire.

| HEATER WIRING CHART | |
|---------------------|-----------|
| BLUE | TO YELLOW |
| BLACK | TO BLACK |

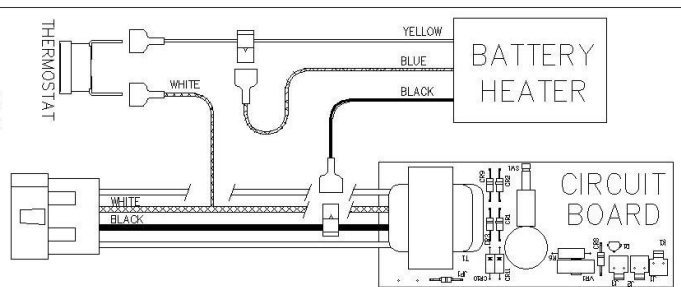

Wiring heater for 277V operation -

Attach one wire tap to blue AC wire (wire tap is provided). Locate the two wires coming from the battery heater assembly (blue and black). Plug blue wire into blue AC wire tap just installed. Clip black heater wire and cap with a wire nut (not supplied).

| HEATER WIRING CHART | | |
|---------------------|----|---------|
| BLUE | TO | BLUE |
| BLACK | - | CAP OFF |

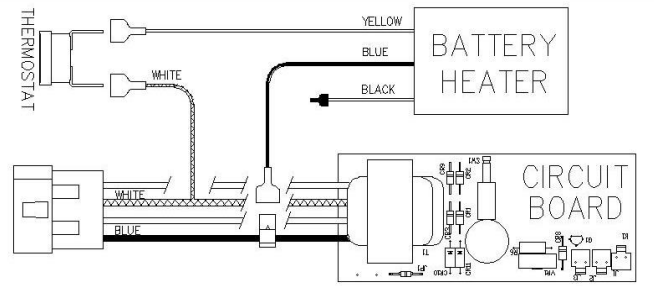

(3): Re assemble AC harness assembly to mating plug inside electronics module. Connect battery harness to charger board. Install electronics module to backplate by hinging together at top and snapping together at bottom. Two #6x1/2" screws are provided for further securing electronics module to backplate if so desired. Install lamps provided by snapping into ceramic lamp holders on lamp head. Attach cover by snapping over electronics module. Cover will latch onto edge of backplate in three locations. Tamper proof screw may be driven into unit to secure installation against vandalism.

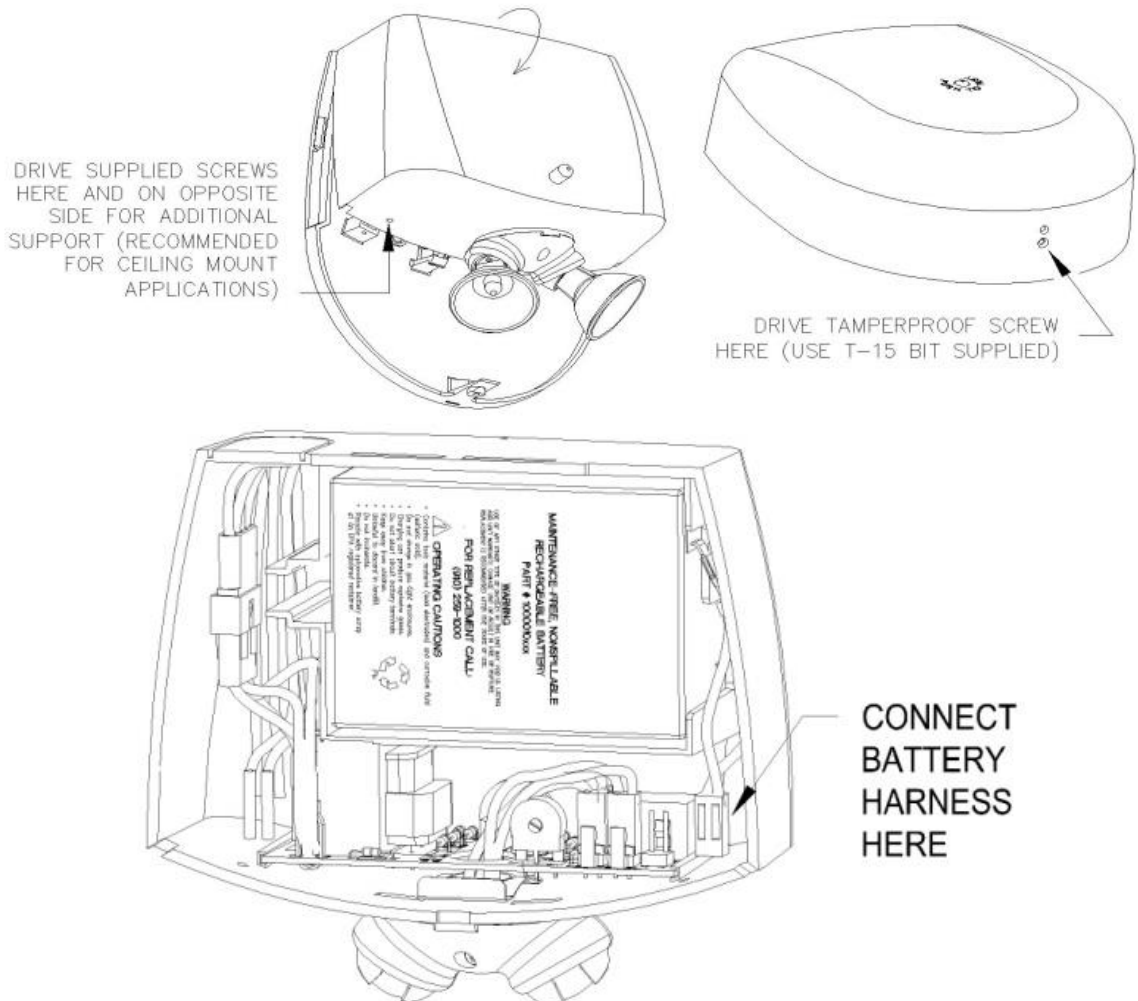

PHILIPS

Philips Lighting North America Corporation
200 Franklin Square Drive
Somerset, NJ 08873, USA
Phone: 855-486-2216
www.philips.com/luminaires

Philips Lighting Canada Ltd.
281 Hillmount Road,
Markham, ON, Canada L6C 2S3
Phone: 800-668-9008
www.philips.com/luminaires

9140052682 February 2016

OPERATING INSTRUCTIONS

- (1): Energize AC power to equipment and check that pilot lamp illuminates red.
- (2): Press test switch and verify pilot lamp turns off and lamp heads illuminate.
- (3): Leave AC connected for a minimum of 24 hours before performing any extended testing. Full recharge of battery may take up to one (1) week.

NOTE

- A. This equipment is provided with a lockout feature whereby connecting battery leads prior to energizing AC power will not turn on the emergency lamps. After AC power is energized, the emergency lamps will turn on upon AC power failure.
- B. This equipment is provided with a low battery disconnect feature which prevents full discharge of battery. If the building is to be unoccupied for an extended period and AC is shut off, the battery should be disconnected from the charger to prevent damage.
- C. The battery in this unit is sealed and requires no maintenance.

SERVICING

- (1): For servicing, remove tamper proof screw (if installed). Then remove cover by inserting a small screwdriver or similar tool into the hole in the bottom of the cover and press upward to release locking tab. Pull over up and off of unit.
- (2): Remove electronics module from backplate by inserting a flat bladed screwdriver between backplate and module and prying module away from backplate.

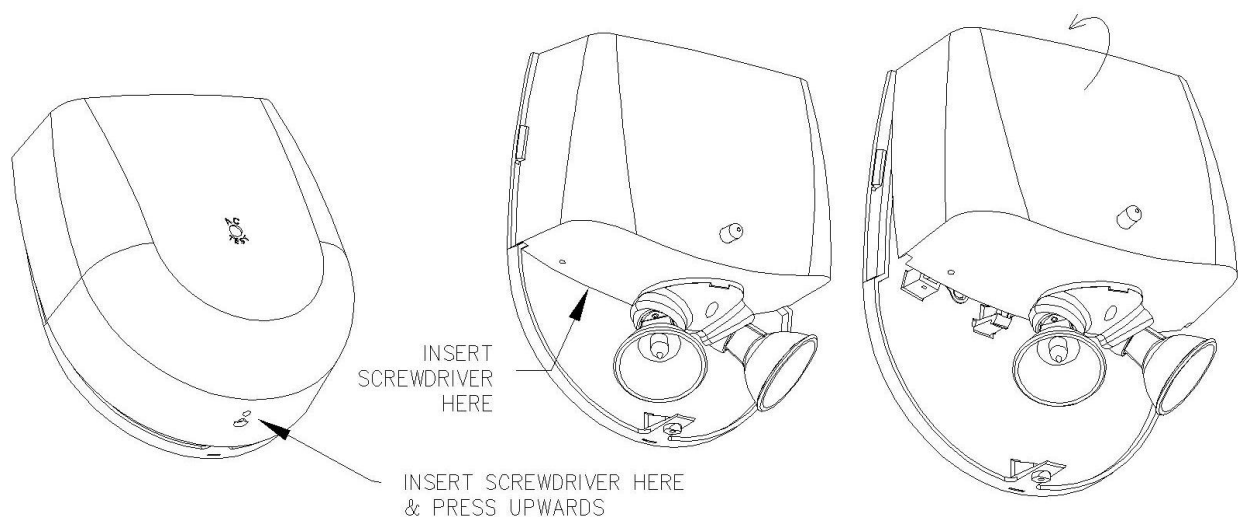

Philips Lighting North America Corporation
200 Franklin Square Drive
Somerset, NJ 08873, USA
Phone: 855-486-2216
www.philips.com/luminaires

Philips Lighting Canada Ltd.
281 Hillmount Road,
Markham, ON, Canada L6C 2S3
Phone: 800-668-9008
www.philips.com/luminaires

9140052682 February 2016