



© 2017 Philips Lighting Holding B.V. All rights reserved. Philips reserves the right to make changes in specifications and/or to discontinue any product at any time without notice or obligation and will not be liable for any consequences resulting from the use of this publication.

PGc-1605BR 04/17 philips.com/luminaires

Philips Lighting
North America Corporation
200 Franklin Square Drive
Somerset, NJ 08873
Tel. 855-486-2216

Philips Lighting Canada Ltd.
281 Hillmount Rd,
Markham, ON,
Canada L6C 2S3
Tel. 800-668-9008

PHILIPS



Wall Mount

LED wall sconces 100 line



Traditional styles
meet **advanced
performance**





Architectural appeal

Philips Gardco LED wall sconces 100 line feature compact designs that provide wide flexibility in high performance illumination, while providing new opportunities to make a sustainable architectural statement. By incorporating cutoff performance, usable illumination patterns, and powerful wattages into architecturally pleasing designs, 100 line provides a much-needed alternative to glare-inducing wall packs.



Now available with enhanced performance, and energy saving control options.

- Multiple lumen packages with output ranging from 2,687 to 9,797 lumens
- Energy saving LEDs provide up to 110 LPW efficacy
- Three distribution patterns available in Type 2, 3, 4
- Emergency Battery Back Up available to provide path-of-egress illumination
- Energy saving control options, such as motion response and wireless controls

Multiple styles **for your application**

The broad choice in housing styles, optics and lumen packages offers numerous options in balancing the illumination and aesthetic requirements of a project. Whether they are used over building entrances, to light facades, or on loading docks, there is no need to compromise appearance for performance. Available with 6 different low-profile forms to choose from, LED wall sconces 100 line have you covered.



Product offering

Wall Mount
.....
LED wall sconces
100 line
.....
Product offering
.....



101L Trapezoidal Wedge

With its tapered rectilinear form, this family immediately impresses with styling that integrates comfortably with a wide range of architectural elements.



102L Rounded Wedge

The distinctive contoured wedge of the 102L establishes styling cues that prevail throughout the series – crisp, simple design and efficient scale.



104L Half Cylinder

This half-round shape integrates naturally with architecture that features soft, rounded corners and forms. The 104L is the perfect companion for Philips Gardco's Round Form Ten cylindrical site lighting products.



106L Quarter Sphere

The classic shape of the 106L can add subtle styling to a variety of architectures. The 106L can also be used in tandem with the domed styles of the Philips Gardco Round Form Ten family.



107L Gullwing Sconce

The Gullwing sconce is the streamlined companion to the popular Philips Gardco Gullwing series of area lighting luminaires. The scale of the 107L allows it to perfectly match with the larger Gullwing LED GL18 or the smaller Gullwing LED GL13.



108L Circa Sconce

The slim appearance of the 108L sconce can add an understated yet elegant look to an otherwise unremarkable building facade.

Enhanced features, energy savings and controls

Instilling a sense of security for a building perimeter is critical in a site lighting application, but energy and maintenance cost savings are also important.

Philips Gardco LED wall sconces 100 line feature the latest in LED technology, which consumes less energy for lower utility bills compared to traditional lighting technologies, even during constant operation. In addition, LED technology lasts longer than traditional lighting technologies, for reduced maintenance time and expenses. Add flexibility and further enhance savings through optional controls, including 0-10V dimming, Dynadimmer, motion response and wireless controls.



Emergency battery backup

LED wall sconces 100 line now feature emergency battery back up. The egress lighting zones are areas requiring emergency backup systems providing code-required path-of-egress illumination.

This is an ROI example you can achieve by
retrofitting 30 HID luminaires with 100 Line LED



63%

Annual energy
over HID



70%

Annual **total cost**
of ownership savings



Reduce lighting costs and
increase energy savings
by combining 100L with
connected lighting solutions

You are saving **energy** and **money** with **LED wall sconces 100 line!**

* Based on comparison between 250W PSMH luminaires (at 291W) and 101L-32L-1000-NW (at 107W) with an energy rate of \$0.1045/KWh. National average energy rates and other assumptions apply.

Controls



Luminaire solutions

Basic. Autonomous. Affordable.

Simple, individual outdoor lighting dimming and management without the need for remote access.

- **0-10V Dimming**
- **Dual Circuit Control**
- **Dynadimmer Stand-alone Dimming Profile**
- **Programmable Motion Response**



Programmable motion response

Programmable Motion Response maximizes your outdoor lighting energy savings while supporting security efforts. Upon easy installation, Programmable Motion Response dims 100L luminaires to 25% light output, increases to 100% light output only when motion is detected, and returns to the original low output after five minutes. Settings are easily changed at the luminaire with an optional wireless handheld programmer.

Dynadimmer

Dynadimmer reduces the luminaire's light output according to pre-programmed or customized dimming schedules to reduce light pollution and energy consumption without compromise.



Site solutions

Intermediate. Informative. Flexible.

Wirelessly manage as a single system or as separate groups within a site. Monitor and respond to real time energy usage and track data trends with a web-based connected lighting system.

- **Wireless controls system**



Wireless system

The 100 Line wall sconces are available with optional wireless controllers ready to be connected to a Limelight system. The system allows you to manage the entire site, independent lighting groups or individual luminaires local or remotely. Based on a high density mesh network and with the easy to use web-based portal, you can conveniently access and manage your lighting network remotely. Wireless controls can be combined with site and area, pedestrian, and parking garage luminaires as well, for a completely connected outdoor solution.

For more information

Visit us at www.philips.com/luminaires for more on Philips stand-alone and connected outdoor lighting solutions, and select Controls Outdoor, or request our outdoor lighting solutions brochure.

Intelligent design, **rugged construction**



While the architectural appeal of Philips Gardco LED wall sconces is self-evident, equal attention has been devoted to the construction and long term performance of the luminaires. It is a quality that never goes out of style.

At every level, simple details make these sconces the very best available. It is an attention to detail that encompasses not only innovative design, but every aspect of luminaire integrity and performance. In every luminaire, one finds seamless material transitions, true performance optics and thoughtful engineering considerate of installation, service and long term operation.

All Philips Gardco 100 Line LED housings, door frames and back plates are precision die cast aluminum. The single-piece die cast door frame fits flush to the housing. Precision, high quality gaskets seal the optic plate to the LED board. The door is secured to the housing with two captive stainless fasteners that provide easy access for servicing. Every Philips Gardco sconce must pass a comprehensive battery of electrical tests prior to shipment.

Easy Mounting



The luminaire installs easily. The mounting plate is affixed to the wall, splices are made and the luminaire is secured to the plate.

Die Cast Ribbed Backplate



The die cast ribbed back plate dissipates heat from the electrical components, which are mounted to the plate within the housing. Proper thermal management is crucial to maintaining long LED life.

Ease of Maintenance



The die cast door frame is secured with two captive stainless steel fasteners and hinges open for easy access.

Performance that meets your needs

Philips Gardco Sconces are available in a Type II (2) wide throw with maximized lateral spacing; a Type III (3) optimized wide throw that adds excellent forward contribution; and a Type IV (4) with maximized forward throw distribution for small parking areas.

Optics are IP66 rated. Luminaires are wet location rated for downlighting applications and are suitable for damp location uplighting in covered ceiling lobbies, atriums and beneath canopies. Optical systems feature advanced Class 1 LED arrays designed to efficiently direct light into very wide or forward projecting light patterns.

Control of Glare & Light Trespass

The factor most destructive to quality lighting is glare. The traditional refractor wall pack generates light at excessively high angles – creating glare within a driver's or pedestrian's field of view. In addition, light above 90° may result in distracting brightness into neighboring spaces. Philips Gardco performance sconces utilize precision LED optical systems. Light above 80° is minimized and light above 90° is eliminated – resulting in exceptional control of luminaire brightness and undesired illumination beyond the property line.

Type 2 at 20'

When economy rules and wide spacings are required, Type 2 optics offer 6:1 spacing to mounting height ratios. Sconces may be spaced as far as 90' apart at a 15' mounting height.



Type 3 at 20'

For the best of both worlds, the Type 3 offers excellent lateral spacings and forward projection in a very usable rectangular pattern.



Type 4 at 20'

If critical light levels are required at the property line, Type 4 optics up tilt project light in a more forward direction.

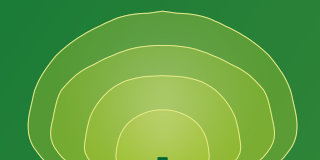

Dimensions

101L

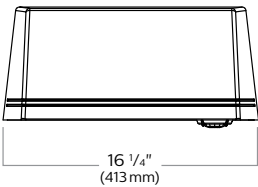
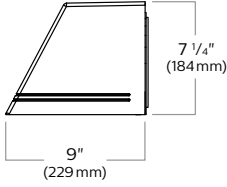
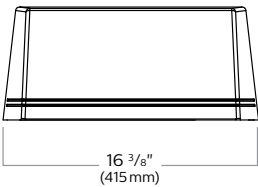

Programmable motion response

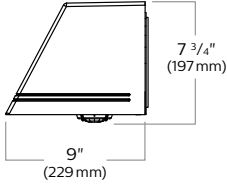

106L

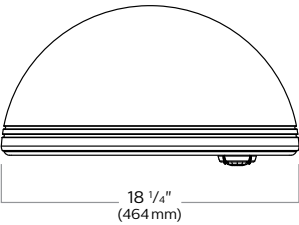
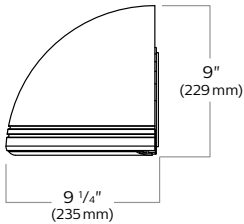
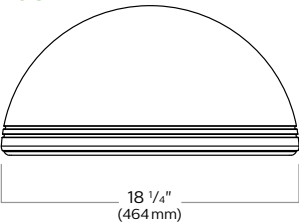

Programmable motion response

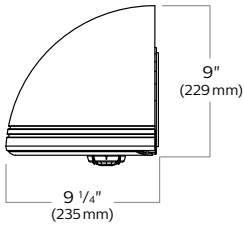

102L

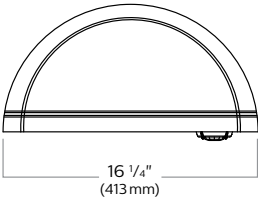
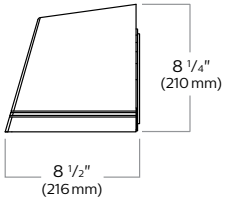
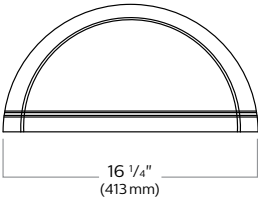

Programmable motion response

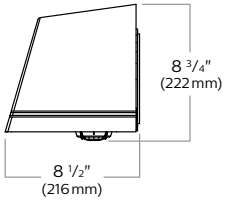

107L

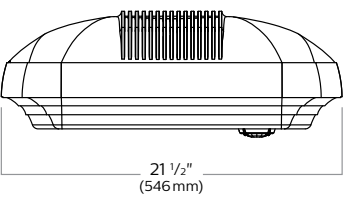
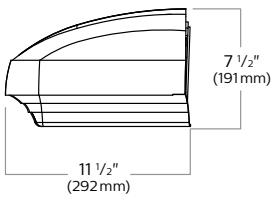
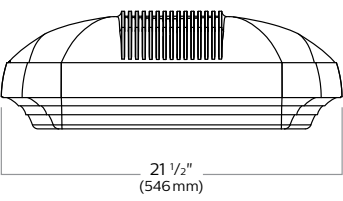

Programmable motion response

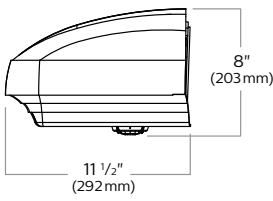

104L

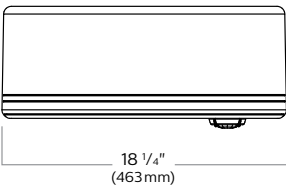
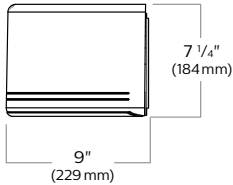

Programmable motion response

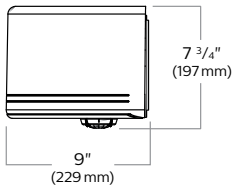

108L

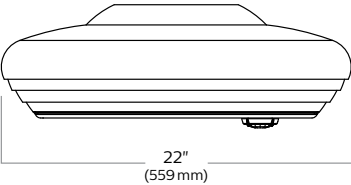
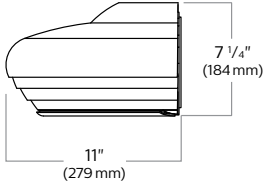
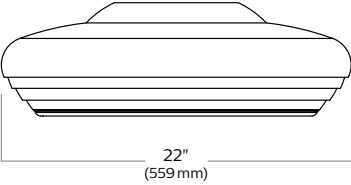

Programmable motion response

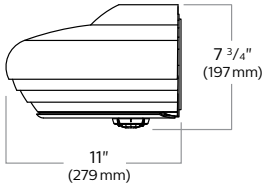

Ordering

Finish

Five standard finish options available in black, white, dark grey, and medium grey. Optional and special finishes also available.

Die cast housing

Rugged, die-cast aluminum housing for maximum durability.



Integral controls

Optional Emergency Battery Backup and Programmable Motion Response are integral to the luminaire, and do not require any external components.

Optical Distributions

Type 2, 3, and 4 distributions available

Mounted fixtures

1. 101L-16L-530-NW-G1
2. 101L-16L-700-NW-G1
3. 101L-16L-1000-NW-G1
4. 101L-16L-1200-NW-G1
5. 101L-32L-530-NW-G1
6. 101L-32L-700-NW-G1
7. 101L-32L-1000-NW-G1

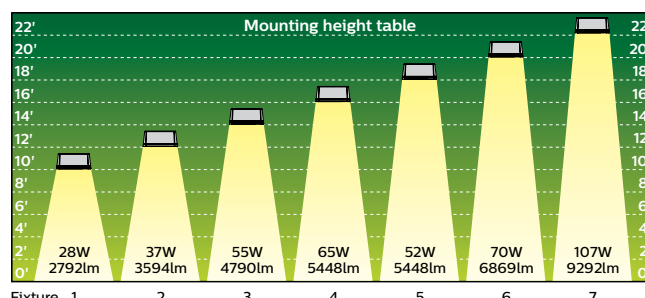

IP66 Rated

IP66-rated optics.

Ordering guide*

example: 101L-32L-700-NW-G1-3-120-IMRI2-BZ

Prefix	Number of LEDs	Drive Current	LED Color - Generation	Distribution	Emergency	Voltage	Options		
							Controls	Electrical	Finish
<input type="text"/>	<input type="text"/>	<input type="text"/>	<input type="text"/>	<input type="text"/>	<input type="text"/>	<input type="text"/>	<input type="text"/>	<input type="text"/>	<input type="text"/>
101L Trapezoidal Wedge LED wall sconce	16L 16 LEDs (1 modules)	530 530 mA	CW-G1 Cool White 5700K, 70 CRI Generation 1	2 Type 2 3 Type 3 4 Type 4	EBPC Emergency Battery Pack Cold Weather Leave blank to omit an emergency option	UNV 120-277V HVU 347-480V 120 120V 208 208V 240 240V 277 277V 347 347V 480 480V	DD 0-10V Dimming Driver DCC Dual Circuit Control DynaDimmer: Automatic Profile Dimming CS50 Safety 50% Dimming CM50 Median 50% Dimming CE50 Economy 50% Dimming DA50 All Night 50% Dimming Photoelectric/Receptacle systems (Twist Lock Receptacle - 101L only) PCB Photocontrol Button TLRD5 Twist Lock Receptacle 5-Pin TLRD7 Twist Lock Receptacle 7-Pin TLRPC Twist Lock Receptacle w/Photocell Infrared Motion Response systems IMRI2 Integral with #3 lens IMRI3 Integral with #4 lens Wireless system controls LLC2 Module with #2 lens LLC3 Module with #3 lens	Fusing F1 Single (120, 277, 347VAC) F2 Double (208, 240, 480VAC) F3 Canadian Double Pull (208, 240, 480VAC)	Textured BK Black WH White BZ Bronze DGY Dark Gray MGY Medium Gray Customer specified RAL Specify optional color or RAL (ex: OC-LGP or OC-RAL7024) CC Custom color (Must supply color chip for required factory quote)
102L Rounded Wedge LED wall sconce		700 700 mA							
104L Half Cylinder LED wall sconce		650 650 mA							
106L Quarter Sphere LED wall sconce	32L 32 LEDs (2 modules)	1000 1000 mA	NW-G1 Neutral White 4000K, 70 CRI Generation 1						
107L Gullwing Sconce LED wall sconce		1200 1200 mA							
108L Circa Sconce LED wall sconce									
		530 530 mA	WW-G1 Warm White 3000K, 70 CRI Generation 1						
		650 650 mA							
		700 700 mA							
		1000 1000 mA							

Luminaire Accessories (order separately)*

Mounting Accessories		Controls Accessories	
Wall Mount		Wireless system remote mount module	
WS	Wall Mounted Box for Surface Conduit	LLCR2-(F)	#2 lens (specify finish in place of "F")
		LLCR3-(F)	#3 lens (specify finish in place of "F")

Wireless controls remote controller accessory

Wireless controls system offers a remote radio/sensor module that allows connectivity to Wireless system gateway. Remote module can be mounted to wall or pole with j-box supplied. May be specified by choosing one of two different lenses to accommodate a variety of mounting heights/sensor detection ranges. Must specify option DD on luminaires that are planned to be used with remote mount controllers.

* Prior to ordering, consult specification sheets on www.philips.com/luminaires for the most current information, notes, and exclusions.