

# PHILIPS ADVANCE

## High Pressure Sodium Lamp Ballast

Catalog Number 78E8443  
For 400W S51  
60 Hz CWA  
Status: Active

### DIMENSIONS AND DATA

78E  
INDOOR  
ENCLOSED  
DIMENSIONS

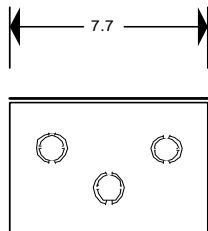

Top view  
3 double  
7/8" and 1 1/8"  
knockouts

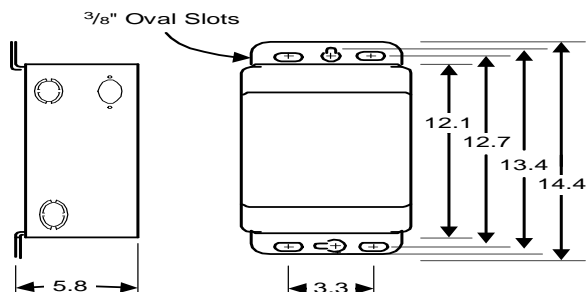

Capacitor:

The capacitor is included as part of the potted assembly.

Ignitor: IN CAN

The ignitor is included as part of the potted assembly.

Ballast to Lamp Distance  
(BTL) = 50 feet  
Temp Rating: 90°C

INPUT VOLTS	480				
CIRCUIT TYPE	CWA				
POWER FACTOR (min)	90%				
REGULATION					
Line Volts	±10%				
Lamp Watts	WITHIN TRAPEZOID				
LINE CURRENT (Amps)					
Operating.....	0.97				
Open Circuit.....	0.55				
Starting.....	0.75				
UL TEMPERATURE RATINGS					
Insulation Class	H(180°C)				
Coil Temperature Code	1029				
MIN. AMBIENT STARTING TEMP.	-40°F or -40°C				
NOM. OPEN CIRCUIT VOLTAGE	190				
INPUT VOLTAGE AT LAMP DROPOUT.....	360				
INPUT WATTS	464				
RECOMMENDED FUSE (Amps).....	3				
CORE and COIL					
Dimension (A)					
Dimension (B)					
Weight (lbs.)	38				
Lead Lengths	12"				
CAPACITOR REQUIREMENT					
Microfarads					
Volts (min.)					
Fault Current Withstand (amps)					
60 Hz TEST PROCEDURES (Refer to Advance Test Procedure for HID Ballasts - Form 1270)					
High Potential Test (Volts)					
1 minute	2000				
2 seconds	2500				
Open Circuit Voltage Test (Volts)	170-210				
Short-Circuit Current Test (Amps)					
Secondary Current	0.50-0.80				
Input Current.....	0.50-0.80	-	-	-	-



Wiring Diagram:

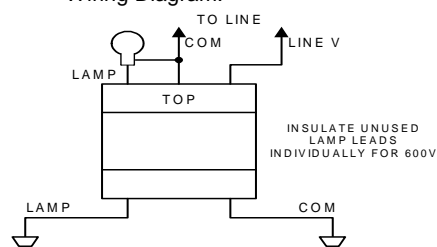

Fig. IE -1

### Ordering Information

Order Suffix

Description

Data is based upon tests performed by Philips Lighting Electronic N.A. in a controlled environment and representative of relative performance. Actual performance can vary depending on operating conditions. Specifications are subject to change without notice.

Philips Lighting Electronic N.A.

10275 West Higgins Road · Rosemont, IL 60018 · Tel:800-322-2086 Fax:888-432-1882  
Customer Support/ Technical Service:800-372-3331 · OEM Support: 866-915-5886

08/28/97