



# Simply beautiful

eW Profile Powercore gen4

Product guide





We bring **exceptional  
light** to any kitchen.

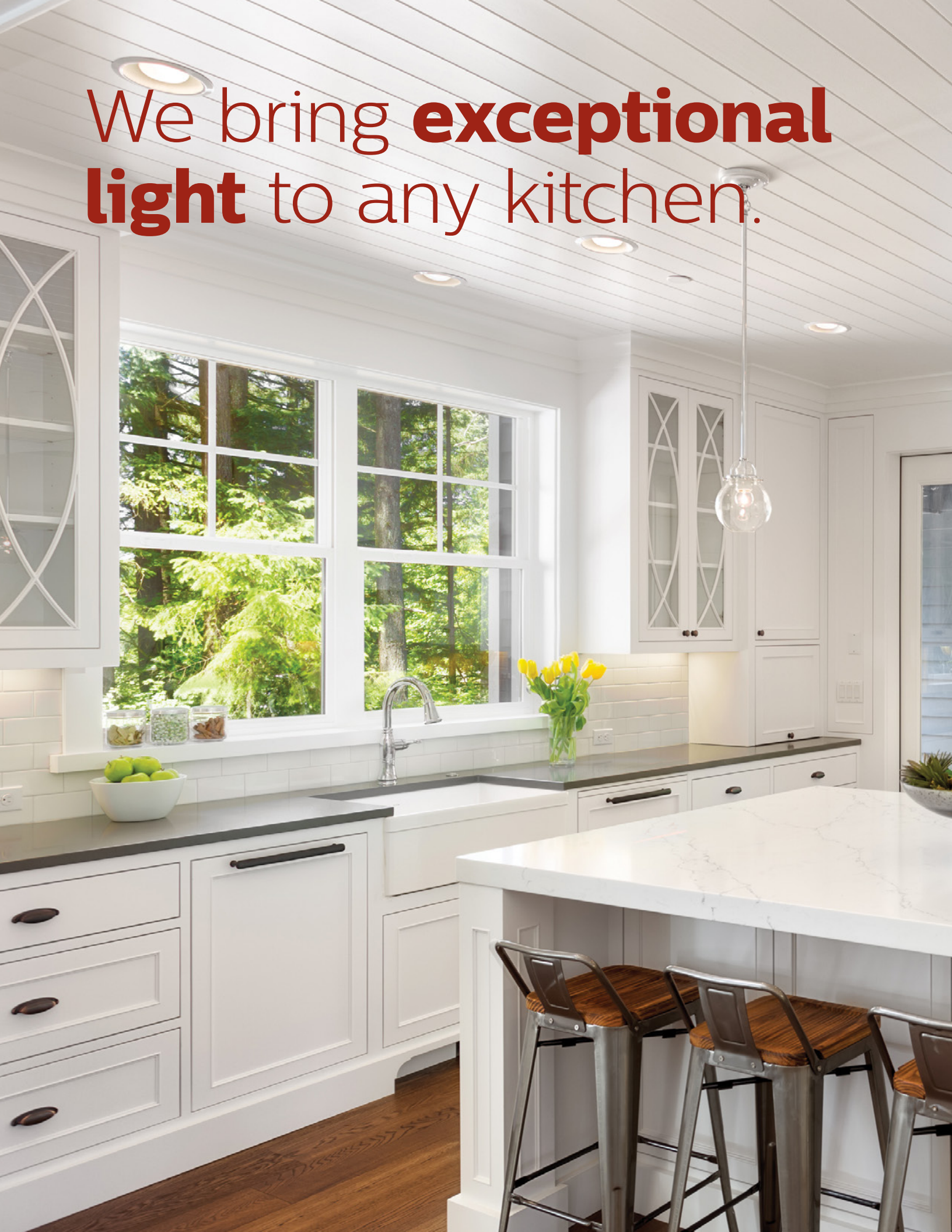



# See the light, not the lighting

Your kitchen is more than just another room of your house. It's the hub of your home, where you cook meals and entertain friends and family. Today's state-of-the-art kitchens are often a major investment to design and build. They demand exceptional lighting, the kind that creates the right look and feel. With **eW Profile Powercore gen4**—the latest Color Kinetics under-cabinet light solution—you get an unbeatable combination of high performance, energy rebates, and year-after-year reliability. And high-quality light that's as beautiful as your kitchen.

We designed eW Profile Powercore gen4 under-cabinet lighting specifically to meet the needs of today's demanding and sophisticated homeowners. Profile delivers high-quality light (90+ CRI) that adds more light, life, and beauty to your kitchen—or to shelves, display cases, or other workspaces. Now you can bring beautiful light to your countertop, backsplashes, and wherever else you need it.

Profile delivers light extremely precisely, so there's no wasted light or energy. It complements natural light. And a choice of four color temperatures lets you choose the level of warm and brightness that you want.

## Lighting that can never be too thin

Integrated seamlessly beneath your cabinets, Profile is sleek, remarkably thin, and easy to install in *any* kitchen layout—making it virtually invisible. Other solutions require bulky brick-sized power supplies that are hard to hide. Not Profile. You get great lighting that's easy to install, without making any adjustments to your kitchen design.

With Profile, you don't have to worry about extra construction, repainting, complicated wiring—or headaches. Flexible installation and mounting

options make life easier for your electrical contractor, and you. You just get beautiful lighting that's simple to install and that you'll enjoy year after trouble-free year. In fact, Profile's generous, five-year warranty goes well beyond the warranties offered by other manufacturers. So you can be confident that Profile will last and last deep into the lifespan of your new kitchen or renovation.

## Compliant with energy guidelines

Profile's high quality and reliability doesn't come at a premium cost. And unlike many other lighting options, Profile is compliant with key energy-efficiency programs—such as Energy Star and California Title 24—bringing you a wide range of attractive rebates that save you money right from the start. Profile lets you get rewarded and reimbursed for your commitment to energy efficiency. Check with your local energy provider to see what programs are available in your area.

High quality, flexibility, reliability, and efficiency—that's what you get when you make Color Kinetics eW Profile Powercore gen4 part of your kitchen.



# Profile gen4

## A designer's dream

Making kitchens brighter, welcoming, and even more beautiful—that's what Profile gen4 can do for homeowners. But lighting designers and installers make it happen. The good news? Profile gen4 is designed to make their work much, much easier. Here's how.

Under-cabinet lighting can be tricky. Use budget tape lighting and you may find yourself replacing it over and over. Use an inflexible, bulky solution and you'll have to adjust your design, or make changes in your current kitchen to hide your lighting. Luckily, there's Profile gen4, designed to meet the criteria that lighting professionals want in under-cabinet lighting—a low-profile form factor, flexible installation, and rock-solid reliability.

**Keeping a low profile.** A Profile gen4 luminaire looks great—sleek, sophisticated, and extremely thin. But you'll probably never see one. That's because its ultra-low profile lets it fit seamlessly into your kitchen—or any kitchen.

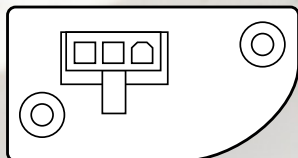

Ultra-low profile 22 mm (0.88 inch) under cabinet height. (Actual size)

**Staying flexible.** When installing under-cabinet lighting, it's important to have options. After all, cabinets vary widely.

Profile gen4 is available in different lengths that match the dimensions of your kitchen. Installers can choose from several electrical options—switched leader cable, switched wiring compartment, existing wall switches/panels. But they'll never have to try to hide a bulky, brick-sized power supply, as with other lighting solutions. And Profile gen4 offers a wide variety of accessories that make installation even easier.

**Lighting the future.** Profile gen4 looks great right from the start. And thanks to its proven reliability, it performs flawlessly, year after year. When other lighting solutions fail, Profile keeps going—thanks to smart design and carefully selected LEDs. That's why we can offer a 5-year warranty, one of the most generous in the industry.

With Profile gen4, everyone wins. Because it delivers the beautiful under-cabinet lighting that homeowners want—and the simple installation that lighting designers and contractors need.



# Choose the right light for you

Color temperature is a technical term that lighting professionals use to quantify and characterize light from any source. Confusingly, the higher the color temperature (as measured in degrees Kelvin), the cooler the light. We won't try to explain this technical contradiction, since it doesn't really matter. What matters is that you see the kind of light that you want—every morning, every night. In short, color temperature can be reduced to a very real-world explanation—how the light makes your kitchen look.

Light is extremely subjective. People interpret light differently thanks to minor differences in the physiography of our eyes. And everyone has biases and preferences based on what they like, where they live, and other factors. No one type of light can meet everyone's needs. That's why Profile gen4 Essential White luminaires are available in four color temperatures—2700 K, 3000 K, 3500 K, and 4000 K—letting you find the quality of light that you like.

But no matter what option you choose, Profile delivers extremely high-quality light. Thanks to careful engineering and proprietary technologies, it achieves an impressive 90+ CRI—far above standard under counter lighting solutions.

## Select Your Ambiance

**Warm  
2700 K**  
Warm, Cozy,  
Open

**White  
3000 K**  
Intimate,  
Personal,  
Exclusive

**Neutral  
3500 K**  
Bright, Inviting,  
Friendly

**Cool  
4000 K**  
Neat, Clean,  
Efficient

**Flexible Light Options.** Profile lets you select from a range of color temperatures—2700, 3000, 3500, and 4000 K—so you choose the level of warmth that you prefer.





**All kitchens are different.**

The dimensions and design varies. That's why Profile gen4 delivers an extremely flexible under-cabinet lighting solution that fits seamlessly into any kitchen—including yours.

Photography: [slidezero.com](https://www.slidezero.com)

# What makes Profile gen4 the **right choice** for your kitchen?

Profile gen4 brings you advanced under-cabinet lighting with key differences.

It's flexible and versatile, so it fits seamlessly in your kitchen. A choice of luminaire lengths and a wide range of accessories takes the hard work and headaches out of installation, keeping it fast and easy. And you can choose the color temperature that you prefer, selecting from four popular options.

## What do choice and flexibility mean to you?

When you choose Profile gen4, you get the light that you want, without complexity or compromises. It doesn't matter if your kitchen is large or small, simple or complex—Profile gen4 can enhance it with beautiful under-cabinet light. All while using less energy. And you get the confidence that comes from a 5-year warranty.

See how Profile gen4 fits into any kitchen.

	Small	Medium	Large
Quantity of fixtures	12	24	47
Total length of fixtures	16 ft	29 ft	58 ft
Total power consumption	48 W	70 W	138 W
Direct connection to line voltage	Yes	Yes	Yes
5 year warranty	Yes	Yes	Yes

# eW Profile Powercore gen4 Key Features



## Luminaire Length

Three lengths let Profile gen4 fit into any kitchen, large or small—no matter what its dimensions.  
235 mm (9.25 in.)  
489 mm (19.25 in.)  
997 mm (39.25 in.)

## Ultra-Low Profile.

An exceptionally slim profile lets Profile gen4 fit invisibly under almost any cabinet.



## Light Options.

Choose from warm to cool light with four color temperature options:

Warm (2700 K)

White (3000 K)

Neutral (3500 K) and

Cool (4000 K).

## Rugged Use.

Go ahead and turn your Profile gen4 lighting off and on as often as you like—it has no impact on the longevity of its LEDs.





**Regulatory Compliance.** Profile gen4 is EnergyStar® listed, as well as a California Title T24 high-efficiency residential listed product. These listings may make you eligible for rebates, lowering costs even more. *Check with your local energy supplier to see what rebates are available in your area.*

**Energy Efficiency.** Lower power and higher energy efficiency help the environment, while lowering your cost of ownership.

# 90<sup>+</sup> CRI

**High-Quality Light.** Profile gen4 delivers light with an impressive CRI of 90+, so it's brighter and better.

# 5 Year Warranty

**Guaranteed Reliability.** Profile's 5-year warranty gives you a high degree of confidence and exceeds that of other manufacturers.

**Accessories and Options.** A wide array of choices—from switched wiring compartments to jumper cables to connectors—accommodate nearly any layout.



# See under-cabinet lighting in action

Explore our under-cabinet lighting showcase to see how you can make Profile gen4 part of your kitchen.

## Example 1 Lighting a small/compact kitchen

Profile gen4 lets you add multiple areas of under-cabinet lighting in a small area. A choice of lengths lets Profile gen4 fit snugly into even the tightest areas and angles of a compact kitchen.

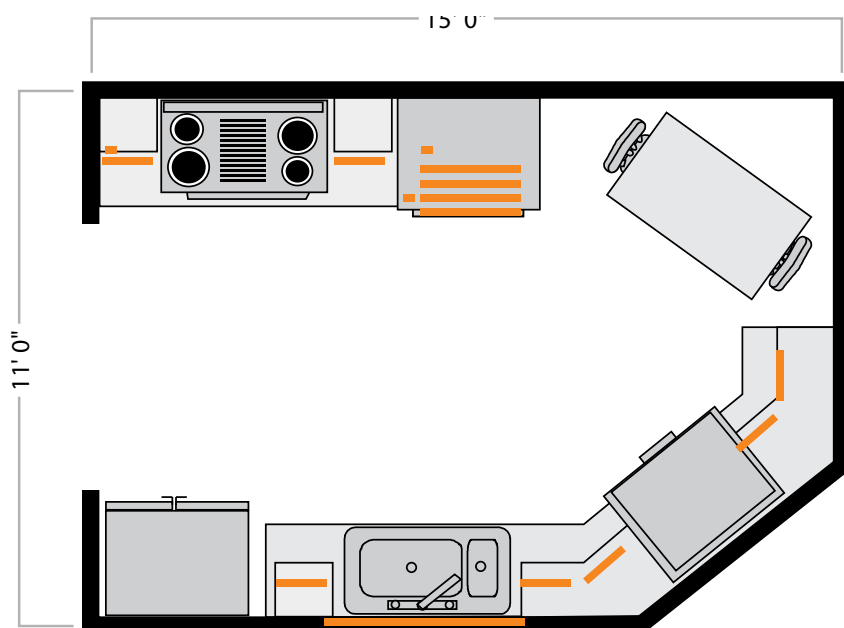

Qty.	Product	Usage	Power consumption
7	Profile Powercore gen4, 235 mm (9.25 in)	Throughout kitchen	19 W
4	Profile Powercore gen4, 489 mm (19.25 in)	4 shelf display	19 W
1	Profile Powercore gen4, 997 mm (39.25 in)	Over kitchen sink	10 W
2	Jumper cable 152 mm (6 in)		
2	“Y” Jumper cables <i>(Perfect when power source is located in the middle of a run so you can run luminaires in opposite directions).</i>		
3	Permanent wiring compartment <i>(For 120 VAC installations. Requires a jumper cable for luminaire connection.)</i>		
Total power consumption			<b>48 watts</b>



## Example 2 Lighting a grand country kitchen

In a larger kitchen, Profile gen4 lets you create long stretches of exceptional under-cabinet light—without requiring a bulky power supply. Profile gen4 fits invisibly into your design, so all you see is exceptional light, not the lighting.

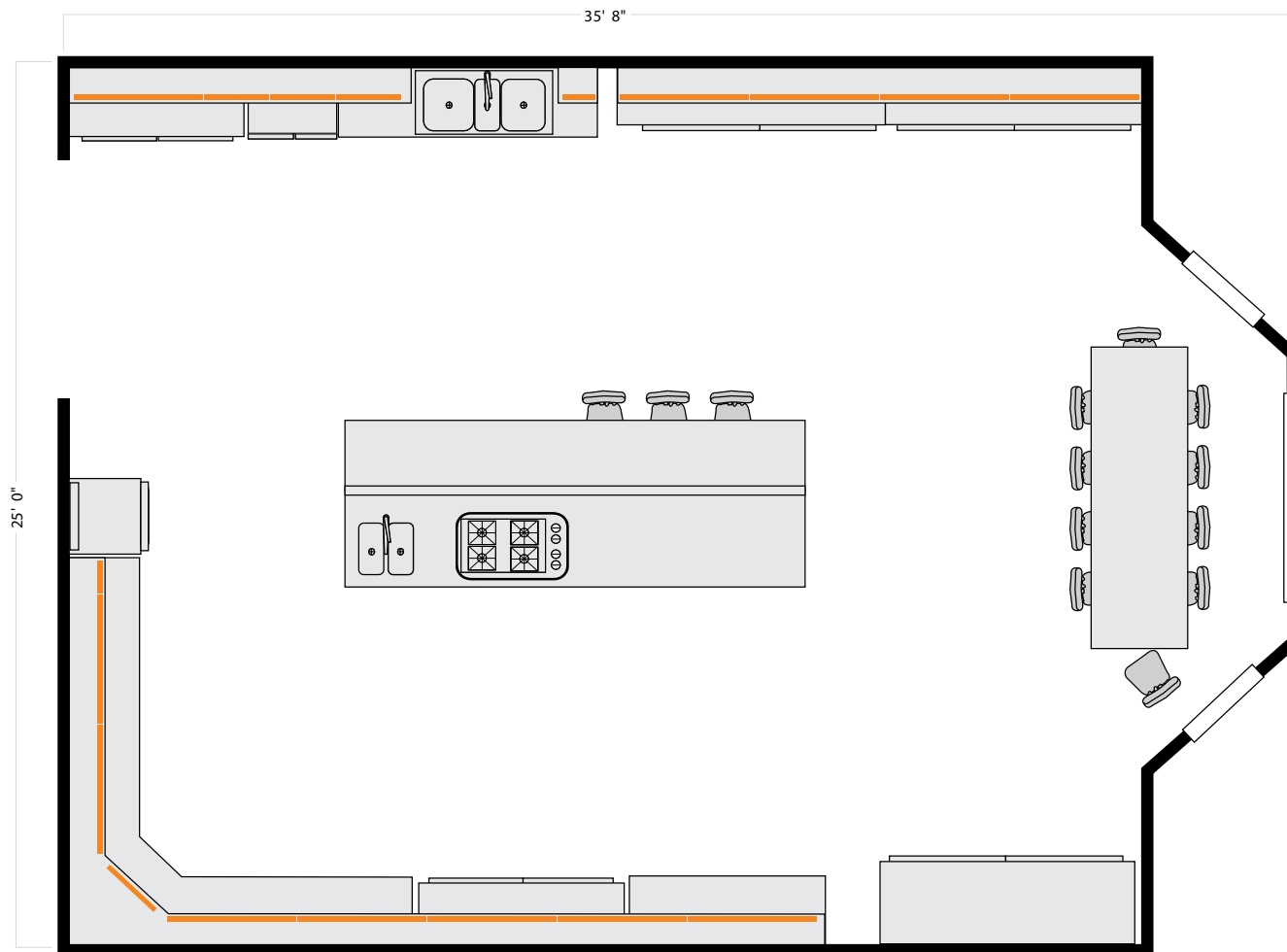

Qty.	Product	Usage	Power consumption
2	Profile Powercore gen4, 235 mm (9.25 in)	Throughout kitchen	5 W
4	Profile Powercore gen4, 489 mm (19.25 in)	Throughout kitchen	19 W
12	Profile Powercore gen4, 997 mm (39.25 in)	Throughout kitchen	114 W
1	Jumper cables 1.5 m (5 ft)		
2	Jumper cable 152 mm (6 in)		
2	Permanent switched wiring compartment <i>(For 120 VAC installations. Allows switching at the luminaire.)</i>		
Total power consumption			<b>138 watts</b>

### Example 3 Lighting a large kitchen

All kitchens are different. No matter how your kitchen is designed, you can be sure that Profile gen4 can light longer workspaces, as well as smaller nooks. Though your kitchen may be large and sophisticated, its lighting should be simple. With Profile gen4, your under-cabinet lighting becomes an integral part of the look and feel of your kitchen—now and far in the future.

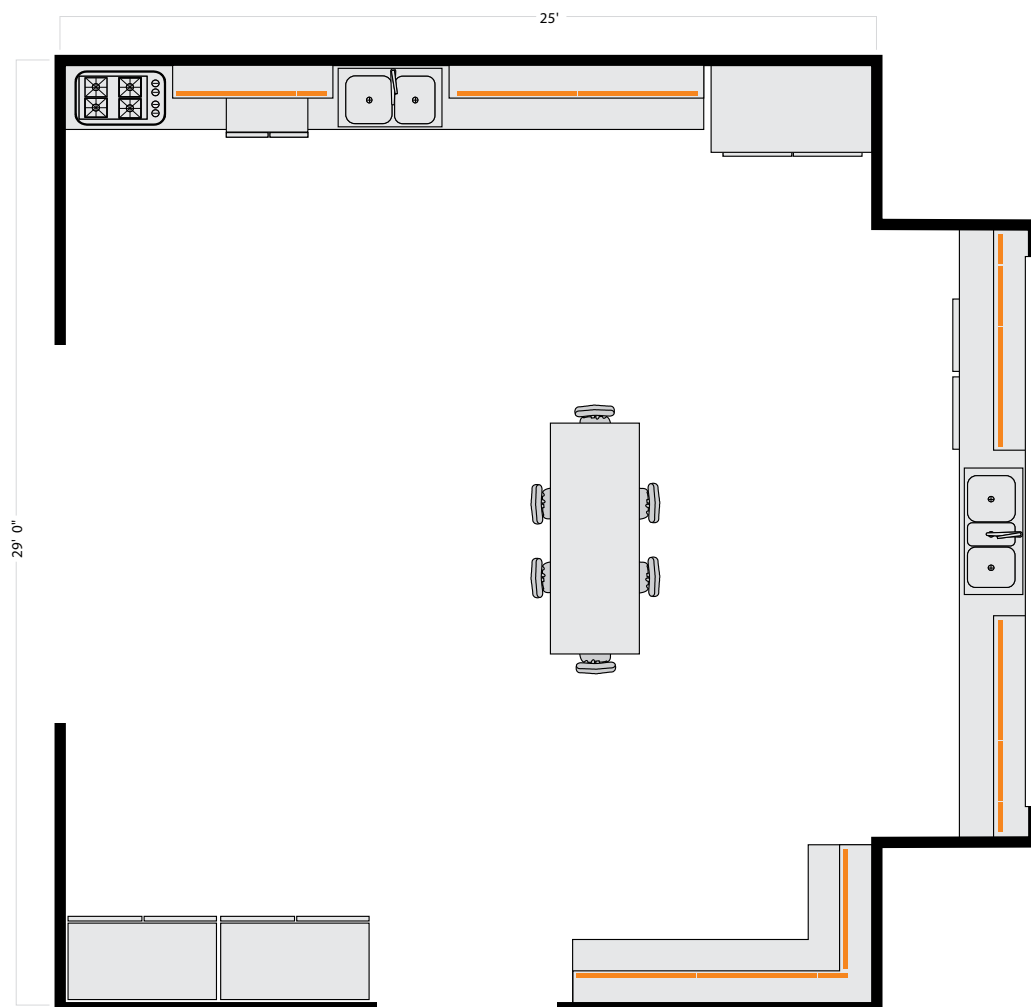

Qty.	Product	Usage	Power consumption
4	Profile Powercore gen4, 235 mm (9.25 in)		11 W
2	Profile Powercore gen4, 489 mm (19.25 in)		10 W
8	Profile Powercore gen4, 997 mm (39.25 in)		76 W
2	Jumper cables 1.5 m (5 ft)		
2	Jumper cable 152 mm (6 in)		
1	Permanent wiring compartment <i>(For 120 VAC installations. Requires a jumper cable for luminaire connection.)</i>		
Total power consumption			<b>97 watts</b>



#### Example 4 Lighting a galley kitchen

Today's urban apartments rely on using small amounts of space wisely. The inherently tight workspaces of a galley kitchen benefit from Profile gen4's bright, clean light, which lets you do more in less space.

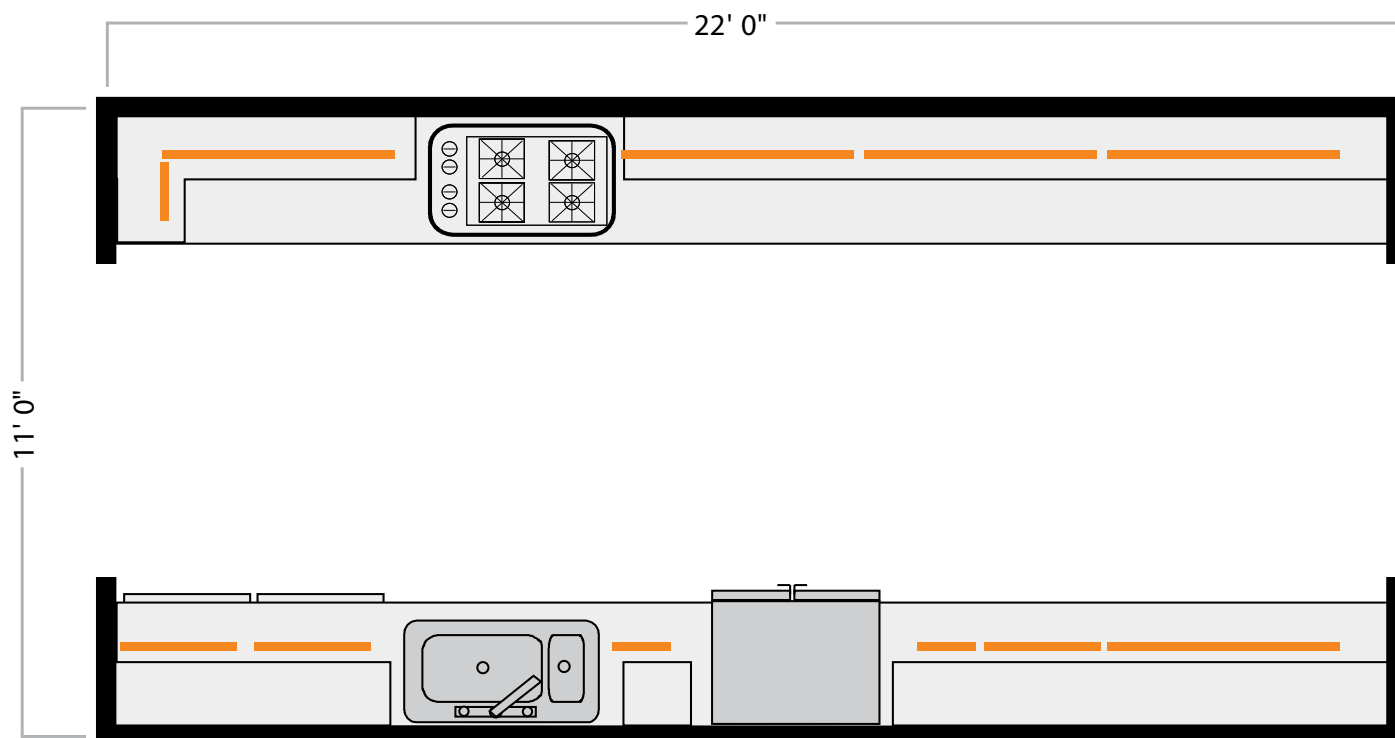

Qty.	Product	Usage	Power consumption
3	Profile Powercore gen4, 9.25 in (235 mm)		8 W
3	Profile Powercore gen4, 19.25 in (489 mm)		14 W
5	Profile Powercore gen4, 39.25 in (997 mm)		48 W
2	Jumper cable 1.5 m (5 ft)		
4	Jumper cable 152 mm (6 in)		
2	Switched Portable Leader Cable (Plugs directly into 120 VAC outlet.)		
Total power consumption			<b>70 watts</b>

# Ordering is as simple as 1, 2, 3.

eW Profile Powercore gen4 offers multiple power, fixture length, and fixture connection options to accommodate nearly any under-cabinet application. To order a complete solution, simply choose a line voltage connection type, any combination of fixture lengths, and the fixture connectors you need for your lighting design.

1

Choose a **leader cable** option for each run of 50 ft. of fixtures.



Permanent Wiring Compartment  
(120 VAC)



Switched Permanent Wiring Compartment (120 VAC)



Switched Portable Leader Cable  
(120 VAC)



Leader Cable and Terminator  
(220 – 240 VAC)

2

Choose the **fixtures** you need in the sizes that match your kitchen.



\_\_\_\_\_ x 235 mm (9.25 in.)

\_\_\_\_\_ x 489 mm (19.25 in.)

\_\_\_\_\_ x 997 mm (39.25 in.)

*Mounting clips, screws and an end-to-end connector are included with every eW Profile Powercore gen4 fixture.*

Choose the color of the light.



Warm  
2700 K  
Warm, Cozy, Open



White  
3000 K  
Intimate, Personal, Exclusive



Neutral  
3500 K  
Friendly, Inviting, Brighter



Cool  
4000 K  
Neat, Clean, Efficient

Choose the power in your kitchen.



120 VAC

or



220 – 240  
VAC

*(Consult your lighting designer or electrical contractor.)*

3

Choose your **connectors**, including jumper cables and end-to-end connectors.



Jumper Cables:  
152 mm (6 in)  
305 mm (12 in)  
457 mm (18 in)  
1.5 m (5 ft)



“Y” Jumper Cable and Terminator

*Perfect when power source is located in the middle of a run so you can run luminaires in opposite directions.*



End-to-End Connector

*One end-to-end connector is included with every eW Profile Powercore gen4 fixture.*

An optional mounting track ensures straight runs of fixtures in linear applications.



# Product details

Luminaire	Item Number	Signify 12NC
eW Profile Powercore gen4, 2700 K, 120 VAC, 235 mm (9.25 in)	523-000027-87	912400135960
eW Profile Powercore gen4, 2700 K, 120 VAC, 489 mm (19.25 in)	523-000027-88	912400135961
eW Profile Powercore gen4, 2700 K, 120 VAC, 997 mm (39.25 in)	523-000027-89	912400135962
eW Profile Powercore gen4, 3000 K, 120 VAC, 235 mm (9.25 in)	523-000027-90	912400135963
eW Profile Powercore gen4, 3000 K, 120 VAC, 489 mm (19.25 in)	523-000027-91	912400135964
eW Profile Powercore gen4, 3000 K, 120 VAC, 997 mm (39.25 in)	523-000027-92	912400135965
eW Profile Powercore gen4, 3500 K, 120 VAC, 235 mm (9.25 in)	523-000027-93	912400135966
eW Profile Powercore gen4, 3500 K, 120 VAC, 489 mm (19.25 in)	523-000027-94	912400135967
eW Profile Powercore gen4, 3500 K, 120 VAC, 997 mm (39.25 in)	523-000027-95	912400135968
eW Profile Powercore gen4, 4000 K, 120 VAC, 235 mm (9.25 in)	523-000027-96	912400135969
eW Profile Powercore gen4, 4000 K, 120 VAC, 489 mm (19.25 in)	523-000027-97	912400135970
eW Profile Powercore gen4, 4000 K, 120 VAC, 997 mm (39.25 in)	523-000027-98	912400135971
eW Profile Powercore gen4, 2700 K, 220 – 240 VAC, 235 mm (9.25 in)	523-000102-00	912400135972
eW Profile Powercore gen4, 2700 K, 220 – 240 VAC, 489 mm (19.25 in)	523-000102-01	912400135973
eW Profile Powercore gen4, 2700 K, 220 – 240 VAC, 997 mm (39.25 in)	523-000102-02	912400135974
eW Profile Powercore gen4, 3000 K, 220 – 240 VAC, 235 mm (9.25 in)	523-000102-03	912400135975
eW Profile Powercore gen4, 3000 K, 220 – 240 VAC, 489 mm (19.25 in)	523-000102-04	912400135976
eW Profile Powercore gen4, 3000 K, 220 – 240 VAC, 997 mm (39.25 in)	523-000102-05	912400135977
eW Profile Powercore gen4, 3500 K, 220 – 240 VAC, 235 mm (9.25 in)	523-000102-06	912400135978
eW Profile Powercore gen4, 3500 K, 220 – 240 VAC, 489 mm (19.25 in)	523-000102-07	912400135979
eW Profile Powercore gen4, 3500 K, 220 – 240 VAC, 997 mm (39.25 in)	523-000102-08	912400135980
eW Profile Powercore gen4, 4000 K, 220 – 240 VAC, 235 mm (9.25 in)	523-000102-09	912400135981
eW Profile Powercore gen4, 4000 K, 220 – 240 VAC, 489 mm (19.25 in)	523-000102-10	912400135982
eW Profile Powercore gen4, 4000 K, 220 – 240 VAC, 997 mm (39.25 in)	523-000102-11	912400135983
<b>Accessories</b>		
Permanent Wiring Compartment and Terminator (120 VAC) (Requires Jumper Cable for luminaire connection), White	120-000065-00	910503700270
Switched Portable Leader Cable and Terminator, 3 m (10 ft), White (120 VAC)	108-000034-00	910503700258
Switched Permanent Wiring Compartment and Terminators, White (120 VAC)	120-000065-04	910503701022
Leader Cable and Terminator, 3 m (10 ft), White (220 – 240 VAC)	108-000034-01	910503700259
End-to-End Connector, Quantity 5, 22 mm (.875 in), White	108-000035-10	910503700368
Jumper Cable, 152 mm (6 in), White (120 VAC)	108-000035-00	910503700260
Jumper Cable, 305 mm (12 in), White (120 VAC)	108-000035-01	910503700261
Jumper Cable, 457 mm (18 in), White (120 VAC)	108-000035-02	910503700262
Jumper Cable, 1.5 m (5 ft), White (120 VAC)	108-000035-03	910503700263
“Y” Jumper Cable and Terminator, 419 mm (16.5 in), White (120 VAC)	108-000035-04	910503700264
Jumper Cable, 152 mm (6 in), White (220 – 240 VAC)	108-000035-05	910503700265
Jumper Cable, 305 mm (12 in), White (220 – 240 VAC)	108-000035-06	910503700266
Jumper Cable, 457 mm (18 in), White (220 – 240 VAC)	108-000035-07	910503700267
Jumper Cable, 1.5 m (5 ft), White (220 – 240 VAC)	108-000035-08	910503700268
“Y” Jumper Cable and Terminator, 419 mm (16.5 in), White (220 – 240 VAC)	108-000035-09	910503700269
Mounting Track, 25 @ 229 mm (9 in), White	120-000064-02	910503700273
Mounting Track, 25 @ 483 mm (19 in), White	120-000064-00	910503700271
Mounting Track, 24 @ 991 mm (39 in), White	120-000064-01	910503700272

# Specifications and information

Color Temperatures	2700 K, 3000 K, 3500 K, 4000 K					
Beam Angle	105° x 100°					
Output	2700 K			3000 K		
	235 mm (9.25 in)	489 mm (19.25 in)	997 mm (39.25 in)	235 mm (9.25 in)	489 mm (19.25 in)	997 mm (39.25 in)
Lumens	196	388	756	195	386	792
Efficacy	76	82	80.3	75.6	81	82
CRI	94	94	94	94	94	94
	3500 K			4000 K		
	235 mm (9.25 in)	489 mm (19.25 in)	997 mm (39.25 in)	235 mm (9.25 in)	489 mm (19.25 in)	997 mm (39.25 in)
Lumens	205	412	818	212	417	828
Efficacy	77.7	86.1	86.2	79.3	87.9	87.2
CRI	96	96	96	97	97	97
Input Voltage	120 or 220 – 240 VAC, 50/60 Hz					
Power Consumption	2.5 W	5 W	9.5 W			
Control	Compatible with selected commercially available reverse-phase ELV-type dimmers					
Housing Material	Extruded aluminium, powder-coated finish					
Approbations	UL/cUL, FCC Class B, CE, C-Tick					
Environment	Dry/Damp Location, IP50					
Certifications	ENERGY STAR, California Title 24 Compliant					
Fixture Run Lengths	Up to 15.3 m (50 ft) of fixtures in a single run.					
Length	235 mm (9.25 in)	489 mm (19.25 in)	997 mm (39.25 in)			
Weight	198 g (7 oz)	369 g (13 oz)	728 g (1.6 lb)			

## For further information

Complete details including Part Numbers, Installation Instructions, Specification Sheets .ies files, and product drawings can be found on the product page.



eW Profile Powercore  
gen4 Family

## Ready to order?

Ask your local contractor or lighting designer to order eW Profile Powercore gen4.

# Dimensions and configuration

## Effective and actual length

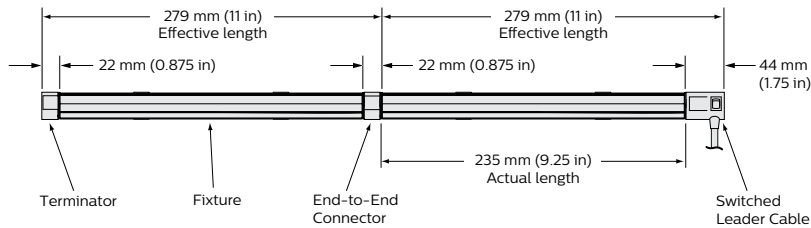

Effective fixture lengths vary once end-to-end connectors or Jumper Cables are attached. Use the actual lengths when calculating the total number of fixtures in a run, (15.2 m (50 ft) or 324 W maximum) and use the effective lengths when measuring for spacing and fit.

## Fixtures

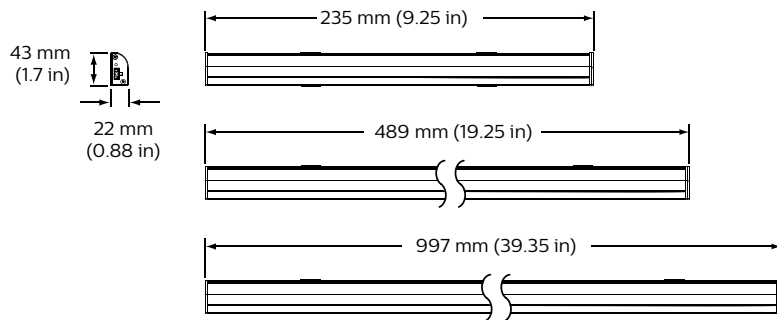

Position Profile gen4 close to the outer edge of the cabinet or enclosure. Make sure the light is pointing toward the backsplash and away from the viewer. Profile gen4 is designed to throw light at the optimal angle for under-cabinet applications. Don't shim or tilt the fixtures.

## Switched Leader Cable

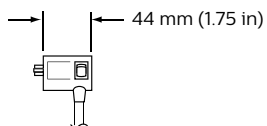

## Jumper / Leader Cable

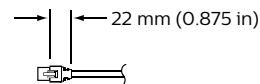

## Jumper / Leader Cable

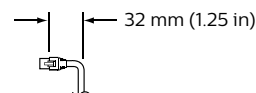

## Permanent Wiring Compartment

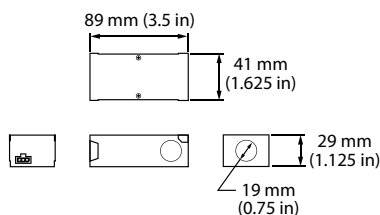

## End-to-End Connector

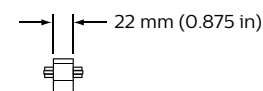

## Terminator

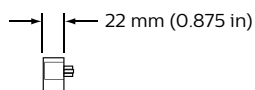

## Switched Permanent Wiring Compartment

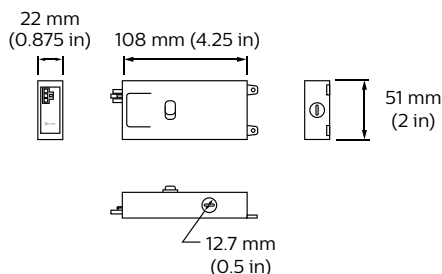

**End-to-End Connectors** allow you to create solid linear runs.

**Jumper Cables** in various lengths and configurations let you turn corners, continue runs across gaps or around appliances or other obstacles, and add more spacing between fixtures when necessary.

If a power source is located in the middle of a run, you can use a "Y" Jumper Cable to run fixtures in opposite directions, originating from a location near the power source.

© 2019 Signify Holding. All rights reserved. The information provided herein is subject to change, without notice. Signify does not give any representation or warranty as to the accuracy or completeness of the information included herein and shall not be liable for any action in reliance thereon. The information presented in this document is not intended as any commercial offer and does not form part of any quotation or contract, unless otherwise agreed by Signify.

All trademarks are owned by Signify Holding or their respective owners.  
DAS-000213-00 R01 01-19

