

PHILIPS
CHLORIDE

Emergency
Architectural

Patron LED



Emergency Solutions

Make your site
feel more secure,
maintain your image

Emergency and general illumination all
in one stylish and efficient package



Emergency and general
illumination **all in one
stylish package**



The Philips Chloride Patron LED low profile unit offers many options for indoor or outdoor lighting applications. Its stylish design is an excellent choice as an architectural grade emergency lighting unit for illuminating an interior or exterior path of egress.

The Patron LED may also be used as a decorative mini wall light for exterior applications providing general lighting for building facades, entranceways, and pathways. When used as a mini wall light, the Patron LED offers an optional nicad battery (contained inside the housing) for providing emergency lighting utilizing the same LED lights used for general lighting (no external emergency power source required).

Features

- **Versatile** – provides both general (700 lumens) and emergency illumination (500 lumens)
- **Stylish** – architectural styling in a sleek compact design
- **Long lasting** – LED light sources last 1000 times longer than the traditional bi-pin halogen miniature lamps (50,000 hours expected life)
- **Efficient** – Consumes 25 Watts compared to 75 Watts with a traditional wall light (white 4500K LEDs)
- **Easy maintenance** – Simple to install and the long life LEDs make it virtually maintenance free
- **Operating temperature** –
 Non-heater: 0°C (32°F) to 50°C (122°F)
 With heater: -19°C (-2°F) to 50°C (122°F)
- **Proactive** – Self-test provided as a standard feature.
- **Reliable** – You will never be left in the dark in emergency situations, because if one LED fails, the remaining LEDs remain illuminated.
- **Versatile** – The optical design in the Patron LED unit provides a wide linear and a forward throw light pattern that will meet all your needs in one unit.



Available in dark bronze or white, the Patron LED features a die-cast aluminum housing which provides a rugged, yet attractive design that blends with any decor. It is also versatile enough for any environment, from extreme outdoor applications, to stylish sophisticated indoor settings.

Design features

1. 8 – 3 Watt – LEDs
2. Test button
3. Die-cast aluminum cover
4. Polycarbonate lens
5. Alignment post (one on each side to guide cover into place)
6. Miro reflector
7. Alignment post receptacle
8. Back gasket with keyslots
9. Die-cast aluminum backplate
10. Gasket for water resistance
11. Spring clips
12. Battery
13. Transformer

Listings/compliances

- ETL Listed to UL 924 Standards
- ETL Listed to UL 1598 Standards (AC only version)
- Wet Location Listed
- NFPA 101 (Life Safety Code) compliant
- NFPA 70 (National Electric Code) compliant
- ADA compliant
- LM79 compliant
- LM80 compliant



Installation

Installation of the Patron LED unit is quick and easy. Unique hanger wires hold front cover during mounting and battery installation. The unit features a universal j-box pattern on the back and a rigid conduit entry on top of the housing. Just fit the unit onto the screws, rotate to lock it into position, install the battery, and snap on the housing and lens.

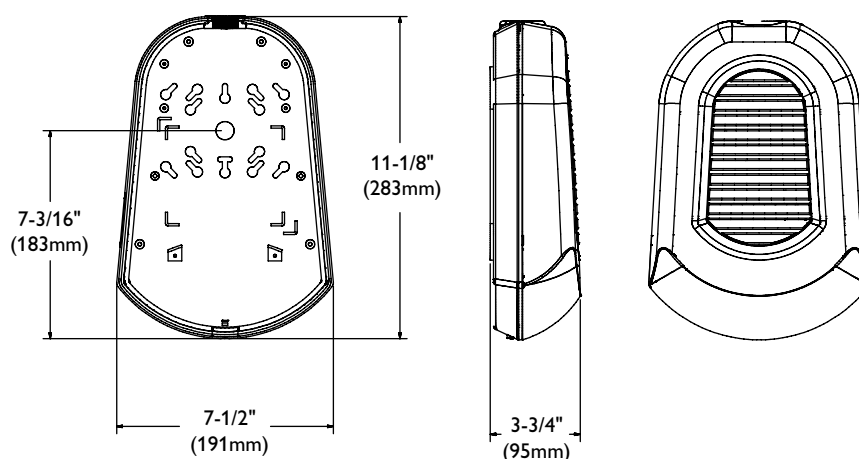
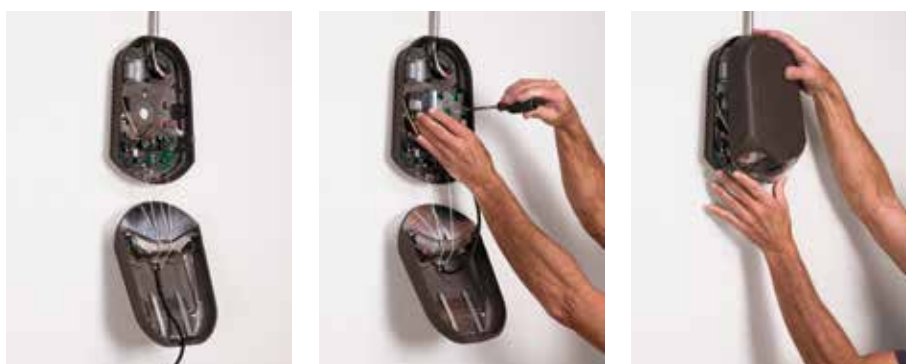

Performance

Single unit

	MH	W	L	
	Mounting Height	Path of Egress		Average Footcandle
		Width	Length	
Indoor	9'	10'	41'	1.22
	11'	6'	43'	1.25
Outdoor	9'	10'	39'	1.17
	11'	6'	41'	1.20

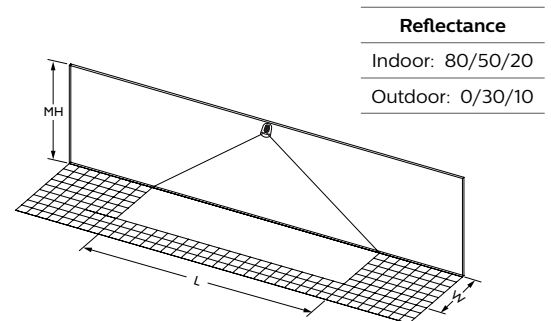

Single unit forward path of egress

	MH	W	L	
	Mounting Height	Path of Egress		Average Footcandle
		Width	Length	
Outdoor	10'	6'	24'	2.35
	12'	6'	27'	1.78
	14'	6'	37'	1.11

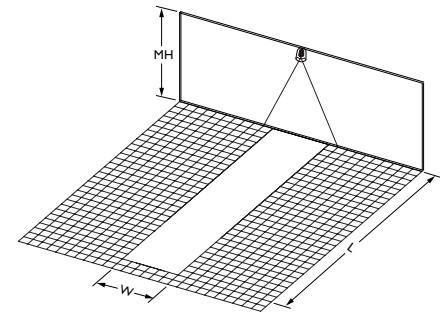

Two Units center-to-center spacing

	MH	W	L	
	Mounting Height	Path of Egress		Average Footcandle
		Width	Length	
Indoor	8'	6'	49'	1.76
	11'	6'	62'	1.04
	11'	10'	47'	1.07
	14'	6'	54'	1.17
Outdoor	9'	6'	43'	1.55
	11'	6'	55'	1.00
	11'	10'	42'	1.00
	14'	6'	40'	1.14

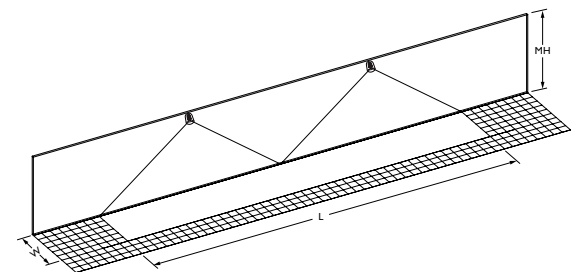

Meets Life Safety Code standard minimum illuminance of 0.1 FC and average illuminance of 1.0 FC. Indoor performance based on 80/50/20 reflectance and assumes open space with no obstructions. Refer to charts for mounting height. Add 1' to mounting height for ceiling height. Outdoor performance based on 0/30/10 reflectance. Analysis based on independently tested photometrics.

Ordering information

Catalog Number	Operation	Volts	LED	Housing Finish	Lamp Type
PLACBZ	AC only	6	8-3W	Dark Bronze	700 Lumen Output
PLACW	AC only	6	8-3W	White	700 Lumen Output
PLEMBZ	EM only	6	8-3W	Dark Bronze	500 Lumen Output
PLEMW	EM only	6	8-3W	White	500 Lumen Output
PLACEMBZ	AC/EM	6	8-3W	Dark Bronze	700/500 Lumen Output
PLACEMW	AC/EM	6	8-3W	White	700/500 Lumen Output

Accessories (order separately)

PLHTR	Patron Heater Kit
PVS1	Wire Guard

Option

BAC	Buy American Compliant
------------	------------------------

*AC mode for general lighting with an integral nicad battery for emergency illumination.



Custom designed packaging for safe, organized shipping.

