



Metronomis – bespoke solutions

Metronomis Cambridge

Metronomis is a family of ten highly distinctive luminaires and dedicated supports (masts and brackets), which can be used with a wide variety of optics to provide architects and lighting designers with the total solution needed to create a unified, consistent lighting design that still reflects the differences in urban culture and history. In its daytime appearance, Metronomis integrates harmoniously with any street scene, while its night-time appearance is both functional – guiding people and traffic safely through the city – and decorative, creating a pleasant ambience in city squares and pedestrian precincts. As the current range is based on conventional light sources, four highly innovative, LED-dedicated designs have been developed, echoing the original silhouette but retaining flexibility and modularity as key characteristics. The Metronomis LED range offers a number of new ways to personalize your urban projects. Please check out the Metronomis LED luminaire variants.

Benefits

- Total solution with both luminaires and supports forming part of a complete, integrated concept
- Huge range of optical elements and light sources makes it possible to create different atmospheres within the city using a single, perfectly coordinated system
- Dedicated masts and brackets match the style of the luminaires - five mast designs in steel, aluminum and wood with heights from 3.5 to 12 m

Features

- Wide range of optical elements and light sources
- Dedicated masts and brackets – five mast designs in steel, aluminum and wood, with heights from 3.5 to 12 m

Metronomis Cambridge

Application

- Urban and architectural areas
- Commercial and business centers

Specifications

Type	CDS580
Light source	HID: <ul style="list-style-type: none">- 1 x MASTER CosmoWhite CPO-TW / PGZ12 / 45, 60, 90, 140 W- 1 x MASTER CityWhite CDO-TT / E27 / 50, 70 W- 1 x MASTER CityWhite CDO-TT / E40 / 100, 150 W- 1 x MASTER Colour CDM-T / G12 / 35, 70, 150 W- 1 x MASTER SDW-T / PG12-1 / 50, 100 W- 1 x SON-T / E27 / 50, 70 W- 1 x SON-T / E40 / 100, 150 W- 1 x SON-T APIA Xtra / 50, 70, 100 W Compact fluorescent: <ul style="list-style-type: none">- 1 x MASTER PL-T 4 Pin / GX24q-3 or 4* / 32, 42 W- *depends on wattage Induction lamp system: <ul style="list-style-type: none">- MASTER QL system / 55 W
Lamp included	Yes (K or lamp color 628, 728, 830, 840) No

Specifications

Ignitor	Semi-parallel (SP) Semi-parallel, self-stopping (ST) Semi-parallel digital (SND)
Options	Photocell: Minicell (P3) Filter coil (F)
Materials and finishing	Housing: high-pressure, die-cast aluminum Decorative arms: die-cast aluminum Bowls and bowl covers: polycarbonate Refractor and diffuser: polymethylmethacrylic-imide Louvers: high-pressure, die-cast aluminum Reflector assemblies: aluminum Adapters: die-cast aluminum

Gear	Electro magnetic (low loss), 240 V / 50 Hz Electronic, 220 - 240 V / 50 - 60 Hz: <ul style="list-style-type: none">- Electronic (EB)
Optic (elements)	Louver (LO) Refractor, prismatic (PR) Diffuser (DF) Rotationally symmetrical reflector (S) Road lighting reflector, asymmetrical (A) Indirect (IO)**
Optical cover	Transparent bowl and cover (TT) Transparent bowl and opal cover (TO) Transparent bowl and painted cover (TP) Opal bowl and cover (OO) Opal bowl and painted cover (OP)

Color	Grey (GR) RAL colors available on request
Installation	Post top mounting: axial entry Ø 60 / 76 mm Side entry mounting: lateral entry Ø 42 - 60 mm with side-entry adapter Recommended mounting height: 4 - 6 m
Accessories	Adapter for side entry, Ø 42 - 60 mm
Remarks	Compatible with various Metronomis brackets **Dedicated indirect optic (IO) preventing light nuisance (E2 classification according to CIE 126-1997)
Main applications	Urban and architectural areas, commercial and business centers

Versions



Metronomis Cambridge CDS580
urban-lighting luminaire with diffuser
(DF), clear bowl and painted cover
(TP)

Metronomis Cambridge

Dimensional drawing

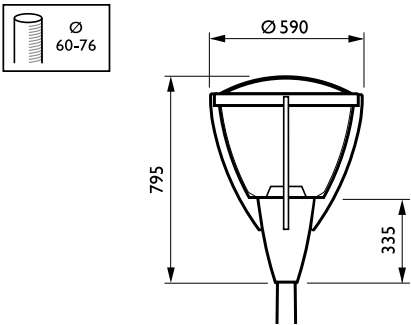

Metronomis CDS500

Approval and Application	
Mech. impact protection code	IK09
General Information	
CE mark	CE mark
Color	Gray
Optical cover/lens type	TP
Design Award Winner mark	Design Award Winner
ENEC mark	ENEC mark
Gear	CONV
Glow-wire test	850/5
Number of light sources	1
Optic type	-
Optical element	PR
Product Family Code	CDS580

General Information

order code	Lamp family code	Lamp power
84593700	SON	70
84596800	CDO-TT	70
84597500	CDO-TT	100
67655500	CDO-TT	70
67657900	CDO-TT	150

