



# Product Description

## MASTERColour CDM-Tm Mini PGJ5

Miniature, single-ended ceramic metal halide lamp. PGJ5 twist-lock lamp base

### Benefits

- Stable colour impression over lifetime
- High efficacy for low operating costs and low heat generation
- Long life compared with halogen lamps
- Relatively low heat output enhances comfort for shoppers and staff
- Mechanical retrofit in halogen capsule (GY6.35) luminaires (same light centre length). For full retrofit gear and lampholder also need to be exchanged
- UV Block for reduced fading risk of merchandise

### Features

- Crisp, sparkling light for a comfortable atmosphere
- Low heat generation
- Warm white colour impression
- Good colour rendering
- Miniature size allows design of very compact luminaires with high beam intensities for mounting close to illuminated object
- Easy replacement due to robust twist-lock socket
- Universal burning position

### Application

- Accent and display lighting with a sparkling effect
- Decorative outdoor floodlighting

# MASTERCoulour CDM-Tm Mini PGJ5

## Warnings and Safety

- Use only in totally enclosed luminaire, even during testing (IEC61167, IEC 62035, IEC60598)
- The luminaire must be able to contain hot lamp parts if the lamp ruptures
- Use only with electronic control gear
- Control gear must include end-of-life protection (IEC61167, IEC 62035)
- For 20W PGJ5 lamp, use only Philips electronic control gear HID PV mini PGJ5 20W
- For 35W PGJ5 lamp, use only Philips electronic control gear HID PV mini PGJ5 35W
- A lamp breaking is extremely unlikely to have any impact on your health. If a lamp breaks, ventilate the room for 30 minutes and remove the parts, preferably with gloves. Put them in a sealed plastic bag and take it to your local waste facilities for recycling. Do not use a vacuum cleaner.

## Dimensional drawing

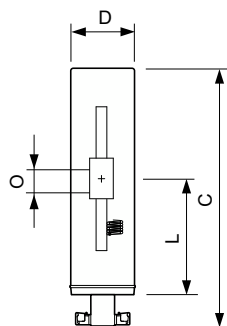

Product	D (max)	D	O	L (min)	L (max)	L	C (max)
MASTERC CDM-Tm Mini 20W/830 PGJ5 1CT/12	13.2 mm	0.44 inch	3 mm	22.3 mm	22.9 mm	22.6 mm	52 mm
MASTERC CDM-Tm Mini 35W/930 PGJ5 1CT/12	13.2 mm	0.44 inch	4 mm	22.3 mm	22.9 mm	22.6 mm	52 mm

General Information	
Cap-Base	PGJ5
Operating Position	UNIVERSAL
Light Technical	
Chromaticity Coordinate X (Nom)	0.434
Chromaticity Coordinate Y (Nom)	0.398
Color Designation	Warm White (WW)
Correlated Color Temperature (Nom)	3000 K
Controls and Dimming	
Dimmable	No
Mechanical and Housing	
Bulb Finish	Clear
Bulb Shape	T13.3

## Light Technical

Order Code	Full Product Name	Color rendering index (CRI)	Luminous Efficacy (rated) (Nom)	Luminous Flux
928087905130	MASTERC CDM-Tm Mini 20W/830 PGJ5 1CT/12	87	72 lm/W	1,600 lm
928093905130	MASTERC CDM-Tm Mini 35W/930 PGJ5 1CT/12	91	77 lm/W	3,000 lm

## Operating and Electrical

Order Code	Full Product Name	Voltage (Nom)	Power Consumption
928087905130	MASTERC CDM-Tm Mini 20W/830 PGJ5 1CT/12	100 V	22.1 W

Order Code	Full Product Name	Voltage (Nom)	Power Consumption
928093905130	MASTERC CDM-Tm Mini 35W/930 PGJ5 1CT/12	96 V	39.1 W

## Approval and Application

MASTERColour CDM-Tm Mini PGJ5

Order Code	Full Product Name	Energy Consumption kWh/1000 h	Mercury (Hg) Content (Max)	Mercury (Hg) Content (Nom)
928087905130	MASTERC CDM-Tm Mini 20W/830 PGJ5 1CT/12	23 kWh	2.4 mg	2.4 mg
928093905130	MASTERC CDM-Tm Mini 35W/930 PGJ5 1CT/12	40 kWh	2.7 mg	2.74 mg

