



Long-lasting, reliable solution

HID-HighPower for SON/MH/HPL/HPI

Encapsulated ballasts for use with SON (T) (Plus), HPL, HPI and MH lamps with rated wattages of 1000 W and above

Benefits

- Protected from overheating – outstanding product lifetime of 15 years average
- Minimal watt losses thanks to orthocyclic winding process
- Ideal for pole mounting

Features

- Excellent resistance to chemical impact, humid conditions and environmental stress crack
- Class I rated (i.e. with earthing facility)
- Equipped with screw terminal blocks as standard
- Separate earth terminal (HID 'Heavy Duty')
- Ballasts for alternative mains voltages/frequencies available upon request

Application

- Outdoor lighting (most popular application areas: sports and area lighting)

HID-HighPower for SON/MH/HPL/HPI

Versions

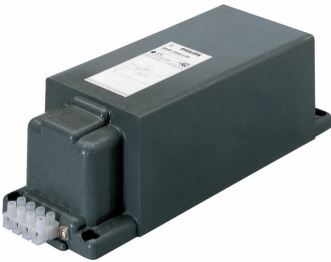

GPPR BSN-HP L02 L43 L78 PHL



GPPR BHD-HP PHL



Dimensional drawing

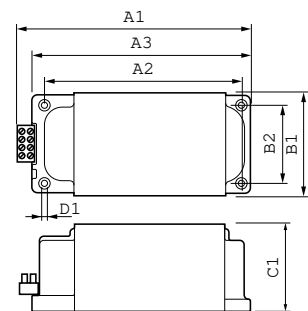
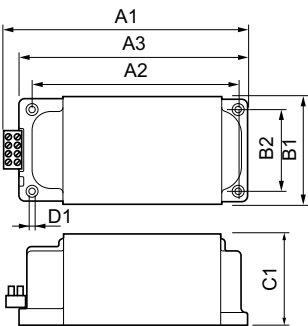
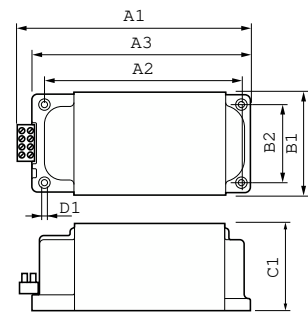

Product	D1	C1	A1	A2	A3	B1	B2
BSN 1000 L78-A2	6.5	102.0	257.0	222.0	246.0	117.0	88.0
230/240V 50Hz	mm	mm	mm	mm	mm	mm	mm
HP-257							

Product	D1	C1	A1	A2	A3	B1	B2
BHD 2000 L76-A2	6.5	102.0	317.0	282.0	306.0	117.0	88.0
380/400/415V 50Hz	mm	mm	mm	mm	mm	mm	mm
HP-317							

Product	D1	C1	A1	A2	A3	B1	B2
BHL 1000 L78-A2	6.5	102.0	207.0	172.0	196.0	117.0	88.0
230/240V 50Hz	mm	mm	mm	mm	mm	mm	mm
HP-207							
BHL 2000 L76-A2	6.5	102.0	317.0	282.0	306.0	117.0	88.0
380/400/415V 50Hz	mm	mm	mm	mm	mm	mm	mm
HP-317							

HID-HighPower for SON/MH/HPL/HPI

Operating and Electrical	
Input frequency	50 Hz
Line Frequency	50 Hz

Operating and Electrical

Order Code	Full Product Name	Input Voltage
06236900	BSN 1000 L78 230/240V 50HZ HP-257	230 V (default) or 240 V
74276600	BHD 2000 L76 380/400/415V 50Hz HP-317	380 to 415 V

Order Code	Full Product Name	Input Voltage
06237600	BHL 1000 L78 230/240V 50HZ HP-207	230 V (default) or 240 V
06384700	BHL 2000 L76 380/400/415V 50HZ HP-317	380 to 415 V

