



# Product Description

## EB-Certalume for PLT/C lamps

Affordable, reliable, high frequency electronic ballast for 4-pin PL-T and PL-C fluorescent lamps, ideal alternative for electromagnetic (EM) ballasts

### Benefits

- Energy efficient, saving 25% energy compared to electromagnetic “C-type” ballasts
- The EB-C TL5 range has a robust design and meets safety, EMC and Immunity tests including safety approbation via an external test-house covering IEC/EN 61347.
- Ideal alternative for electromagnetic ballast, no ignitor needed Pre wired, Lamp/ mains wires and lamp holders are included for easy installation.
- Same size as electromagnetic ballast so ideal for replacements

### Features

- Energy efficient CELMA A3
- Complying to CCC certificate including safety acc IEC 61347
- Robust design for 20.000 hour lifetime and 3.000 on/off switches on one lamp.
- Rapid, flicker-free lamp start (< 1.6 s)
- High power factor 0.95 with THD <25%
- EMC compliant to EN 55015 2006 + A1 2007
- Wide voltage range for ignition and operation (165V-253V)
- 45 degree connector for easy connection with push button release

### Application

- Designed for applications where lamps burn for a long period of time and switching cycle (on/off) is infrequent. Typical areas of application include:
- Professional indoor applications (e.g. offices and hotels)
- Department stores, shops, supermarkets, convenient stores and public area's
- Indoor lighting boxes
- Homes

# EB-Certalume for PLT/C lamps

## Versions



EB-C 113 PL-T/C 220-240V 50/60Hz

## Dimensional drawing

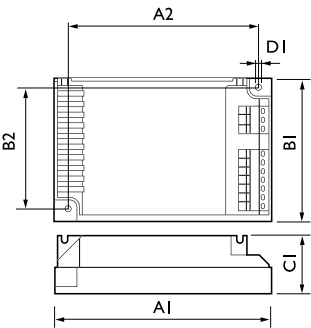

Product	D1	C1	A1	A2	B1
EB-C 213 PL-T/C 220-240V 50/60Hz	4.2 mm	31.0 mm	94.0 mm	86.0 mm	72.0 mm
EB-C 113 PL-T/C 220-240V 50/60Hz	4.2 mm	31.0 mm	94.0 mm	86.0 mm	72.0 mm
EB-C 218 PL-T/C 220-240V 50/60Hz	4.2 mm	31.0 mm	94.0 mm	86.0 mm	72.0 mm
EB-C 118 PL-T/C 220-240V 50/60Hz	4.2 mm	31.0 mm	94.0 mm	86.0 mm	72.0 mm
EB-C 226 PL-T/C 220-240V 50/60Hz	4.2 mm	31.0 mm	94.0 mm	86.0 mm	72.0 mm
EB-C 126 PL-T/C 220-240V 50/60Hz	4.2 mm	31.0 mm	94.0 mm	86.0 mm	72.0 mm

Approval and application	
Energy Efficiency Index	A2
Operating and electrical	
Input Frequency	50 to 60 Hz
Input Voltage	220 to 240 V
General information	
Number Of Products On MCB (16A Type B) (Nom)	20
Lamp Type	PL-T/C

## General information

Order Code	Full Product Name	Number Of Lamps
83286000	EB-C 113 PL-T/C 220-240V 50/60Hz	1 piece/unit
83287700	EB-C 213 PL-T/C 220-240V 50/60Hz	2 piece/unit
83288400	EB-C 118 PL-T/C 220-240V 50/60Hz	1 piece/unit

Order Code	Full Product Name	Number Of Lamps
83289100	EB-C 218 PL-T/C 220-240V 50/60Hz	2 piece/unit
88904800	EB-C 126 PL-T/C 220-240V 50/60Hz	1 piece/unit
88907900	EB-C 226 PL-T/C 220-240V 50/60Hz	2 piece/unit

## System characteristics

## EB-Certalume for PLT/C lamps

Order Code	Full Product Name	Lamp Power On	Rated Ballast-
		PL-T/C	Lamp Power
83286000	EB-C 113 PL-T/C 220-240V 50/60Hz	13.0 W	13 W
83287700	EB-C 213 PL-T/C 220-240V 50/60Hz	13.0 W	13 W
83288400	EB-C 118 PL-T/C 220-240V 50/60Hz	16.0 W	18 W

Order Code	Full Product Name	Lamp Power On	Rated Ballast-
		PL-T/C	Lamp Power
83289100	EB-C 218 PL-T/C 220-240V 50/60Hz	16.5 W	18 W
88904800	EB-C 126 PL-T/C 220-240V 50/60Hz	24.5 W	26 W
88907900	EB-C 226 PL-T/C 220-240V 50/60Hz	24.5 W	26 W

### Mechanical and housing

Order Code	Full Product Name	Housing
83286000	EB-C 113 PL-T/C 220-240V 50/60Hz	-
83287700	EB-C 213 PL-T/C 220-240V 50/60Hz	-
83288400	EB-C 118 PL-T/C 220-240V 50/60Hz	-

Order Code	Full Product Name	Housing
83289100	EB-C 218 PL-T/C 220-240V 50/60Hz	-
88904800	EB-C 126 PL-T/C 220-240V 50/60Hz	-
88907900	EB-C 226 PL-T/C 220-240V 50/60Hz	-

