

# Xtreme drivers for long life and reliable performance

## HF-Performer II Xtreme for TL5/TL-D lamps

HF-Performer Xtreme is a unique X-technology from Philips that guarantees the highest lifetime reliability for lamps and enables an extra-long and reliable HF system life with an energy efficiency index (CELMA EEI) of A2.

### Benefits

- HF-P XT has double the lifetime of standard HF gear due to the special cooler "Xtreme" long-life low-failure product design.
- Suitable for use in outdoor and industrial environments because the units are protected against transients; also suitable for class I and class II luminaires
- Extreme thermal robustness with average lifetime of 50,000 hours at  $T_{case} = 85^{\circ}\text{C}$ ; also extreme reliability and reduced failure rate of 0.1%/1,000 hours
- HF-P Xtreme gear is optimized for the unique dosing of the emitter, resulting in an optimized lamp life

### Features

- Protects against transient voltage peaks of up to 4 kV and excessive mains voltage and incorrect connections of up to 400 V
- Programmed, flicker-free, pre-heated start ( $< 2.0\text{ s}$ ) which allows the lamp to be switched on and off without reducing useful lamp life
- Active power factor correction to ensure constant light, irrespective of mains-voltage fluctuations
- Suitable for emergency lighting luminaires in accordance with IEC/EN 60598-2-22

# HF-Performer II Xtreme for TL5/TL-D lamps

## Application

- Ideal for applications with high maintenance costs or where lamp failure is unacceptable
- Used with movement-detection control systems like Philips OccuPlus
- Applications where gear replacement can cause unsafe situations, hassle or high costs, such as installations with high ceilings or in geographically remote areas, tunnels, airports or underground railway stations
- Industrial premises such as food processing and petrochemical plants

## Versions



## Dimensional drawing

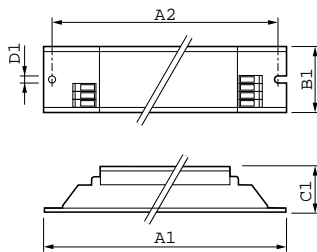
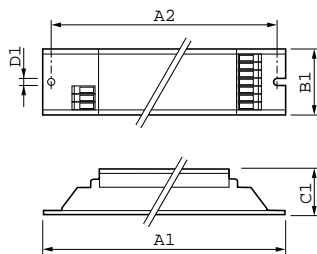

Product	D1	C1	A1	A2	B1
HF-P Xt 280 TL5 EII 220-240V	4.2 mm	28.0 mm	425.0 mm	415.0 mm	30.0 mm
HF-P Xt 249 TL5 EII 220-240V	4.2 mm	28.0 mm	360.0 mm	350.0 mm	30.0 mm
50/60Hz					
HF-P Xt 258 TL-D EII 220-240V	4.2 mm	28.0 mm	360.0 mm	350.0 mm	30.0 mm
50/60Hz					

Product	D1	C1	A1	A2	B1
HF-P Xt 158 TL-D EII 220-240V	4.2 mm	28.0 mm	360.0 mm	350.0 mm	30.0 mm
50/60Hz					
HF-P Xt 136 TL-D EII 220-240V	4.2 mm	28.0 mm	360.0 mm	350.0 mm	30.0 mm
50/60Hz					

## HF-Performer II Xtreme for TL5/TL-D lamps

### Approval and Application

Energy Efficiency Index	A2
-------------------------	----

### Operating and Electrical

Input Frequency	50 to 60 Hz
Input Voltage	220 to 240 V

### General Information

Order Code	Full Product Name	Number Of Products On			Lamp Type
		MCB (16A Type B) (Nom)	Number Of Lamps		
91200830	HF-P XT 136 TL-D EII 220-240V 50/60HZ	28	1 piece/unit		TL-D
91204630	HF-P XT 158 TL-D EII 220-240V 50/60HZ	28	1 piece/unit		TL-D
91206030	HF-P XT 258 TL-D EII 220-240V 50/60HZ	12	2 piece/unit		TL-D

Order Code	Full Product Name	Number Of Products On			Lamp Type
		MCB (16A Type B) (Nom)	Number Of Lamps		
91427930	HF-P XT 249 TL5 EII 220-240V 50/60HZ	12	2 piece/unit		TL5
91442230	HF-P XT 280 TL5 EII 220-240V 50/60HZ	8	2 piece/unit		TL5

### Mechanical and Housing

Order Code	Full Product Name	Housing
91200830	HF-P XT 136 TL-D EII 220-240V 50/60HZ	L 360x30x28
91204630	HF-P XT 158 TL-D EII 220-240V 50/60HZ	L 360x30x28
91206030	HF-P XT 258 TL-D EII 220-240V 50/60HZ	L 360x30x28

Order Code	Full Product Name	Housing
91427930	HF-P XT 249 TL5 EII 220-240V 50/60HZ	L 360x30x28
91442230	HF-P XT 280 TL5 EII 220-240V 50/60HZ	L 425x30x28

### System characteristics

Order Code	Full Product Name	Lamp		
		Power On TL5	Lamp Power On TL-D	Rated Ballast-Lamp Power
91200830	HF-P XT 136 TL-D EII 220-240V 50/60HZ	-	32 W	36 W
91204630	HF-P XT 158 TL-D EII 220-240V 50/60HZ	-	50 W	58 W
91206030	HF-P XT 258 TL-D EII 220-240V 50/60HZ	-	50 W	58 W

Order Code	Full Product Name	Lamp		
		Power On TL5	Lamp Power On TL-D	Rated Ballast-Lamp Power
91427930	HF-P XT 249 TL5 EII 220-240V 50/60HZ	49 W	-	49 W
91442230	HF-P XT 280 TL5 EII 220-240V 50/60HZ	80 W	-	80 W

