



# Intelligent control

## ROVR

Philips Advance ROVR ballasts reflect the latest approach to controlling fluorescent lighting. Rather than simply responding to instructions from control components, ROVR ballasts enable two-way communication, and have the ability to dim and switch individual ballasts through the control signal. These features allow for virtually unlimited design flexibility while creating sustainable lighting systems. This two-way communication is made possible through the industry-standard digital communication protocol known as DALI (Digital Addressable Lighting Interface). This protocol allows ROVR ballasts to provide users with operational data while controlling the output of individual luminaires. This fully supports sustainable design principles such as daylight harvesting and occupancy sensors while enabling a proactive response to maintenance concerns.

### Benefits

- Provides task appropriate comfort only where necessary to increase potential energy savings while supporting LEED performance standards – Full range continuous dimming (100% light output down to 3% – T5/HO to 1%)
- Ideal for frequent switching applications such as occupancy sensors and daylight harvesting – Programmed start operation"

### Features

- Operates via DALI Protocol
- Available in linear fluorescent and 4-pin compact fluorescent models
- IntelliVolt technology (120 – 277V, 50/60Hz)

### Application

- Training centers, multi-tenant office spaces, auditoriums, educational facilities, or entertainment venues, conference rooms, private offices, hotels, restaurants, and department stores

Versions



IDL2S26M5BS35M

IDL2S26M5LD35M



IDA2S32SC35M

IDA3S32G35M

Dimensional drawing

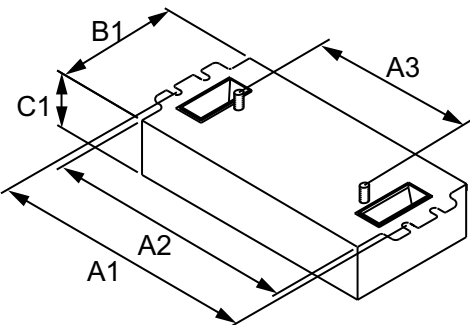
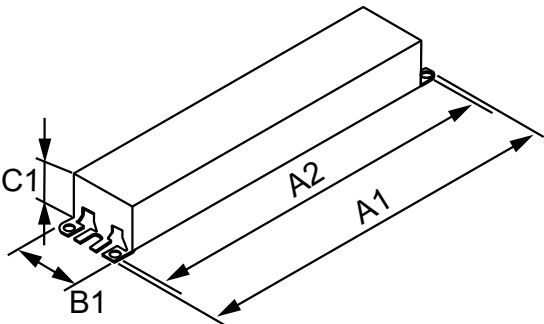
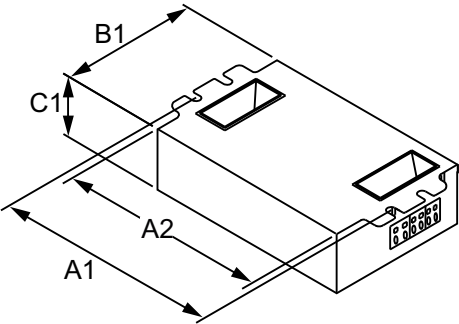

Product	A1	A2	B1	C1
ROVR IDL2T42M5LD35M	4.55 in	4.20 in	3.00 in	1.18 in
ROVR IDL2S26M5LD35M	4.55 in	4.20 in	3.00 in	1.29 in

Product	A1	A2	B1	C1
ROVR IDA3S32G35M	16.70 in	16.34 in	1.70 in	1.18 in
ROVR IDA2S32SC35M	9.5 in	8.90 in	1.7 in	1.18 in

Product	A1	A2	A3	B1	C1
ROVR IDL2S26M5BS35M	4.55 in	4.20 in	2.00 in	3.00 in	1.18 in

## Operating and Electrical

Input Frequency	50 to 60 Hz
Input Voltage	120 to 277 V
Total Harmonic Distortion USA	10 %

## General Information

Order Code	Full Product Name	Number Of Lamps	Lamp Type
913710212602	ROVR ELE DIM BAL (2) 26W CFL (4-PIN) 120-277V	1/2 piece/unit	CFQ26W/G24Q
913710212702	ROVR ELE DIM BAL (2) 26W CFL (4-PIN) 120-277V	1/2 piece/unit	CFQ26W/G24Q
913710298002	ROVR ELE DIM BAL (2) 42W CFL (4-PIN) 120-277V	1/2 piece/unit	CFTR42W/ GX24Q

Order Code	Full Product Name	Number Of Lamps	Lamp Type
913710265802	ROVR INTLV DIM (2) F32T8_NO SALE TO CALIF	2 piece/unit	F32T8
913710288802	ROVR INTLV DIM (3) F32T8_NO SALE TO CALIF	3 piece/unit	F32T8

## Mechanical and Housing

Order Code	Full Product Name	Housing
913710212602	ROVR ELE DIM BAL (2) 26W CFL (4-PIN) 120-277V	M5
913710212702	ROVR ELE DIM BAL (2) 26W CFL (4-PIN) 120-277V	M5
913710298002	ROVR ELE DIM BAL (2) 42W CFL (4-PIN) 120-277V	M5

Order Code	Full Product Name	Housing
913710265802	ROVR INTLV DIM (2) F32T8_NO SALE TO CALIF	SC
913710288802	ROVR INTLV DIM (3) F32T8_NO SALE TO CALIF	G

