

# Reliable performance

## Core & Coil (71A) HPS 200W – 400W

The basic ballast is the open core and coil which is most often used as a component within a lighting luminaire. The core and coil also forms the nucleus of Philips Advance's five other ballast configurations.

### 优点

- Vacuum-pressure impregnation is used to re-enforce the electrical insulation of the ballast, preclude moisture, inhibit noise, and dissipate heat
- Pre-insulated voltage leads reduce the risk of shock and shrink installation time

### 特点

- Vacuum-pressure impregnated with a silica-filled polyester varnish
- All core and coil ballasts below 600W utilize a UL Class H (180°C) insulation system
- C and C ballasts 600W and higher utilize a UL Class N (200°C) insulation system
- Pre-insulated voltage leads
- Ballast kits supplied with pre-wired ignitor

### 应用

- High bay retail, manufacturing, gymnasiums, warehouses, parking structures, outdoor

# Core & Coil (71A) HPS 200W - 400W

## Versions

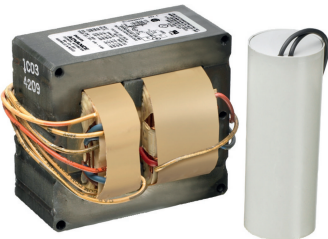

## 二维绘图

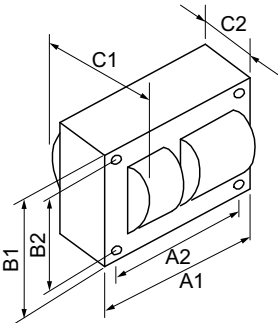

Product	C1	C2	A1	A2	B1	B2
CORE & COIL HID 71A8493500D	4 in	2.09 in	4.8 in	4.4 in	4.3 in	3.9 in

