

Reliable performance

Core & Coil (71A) HPS ~LT~ 200W

The basic ballast is the open core and coil which is most often used as a component within a lighting luminaire. The core and coil also forms the nucleus of Philips Advance's five other ballast configurations.

Benefits

- Vacuum-pressure impregnation is used to re-enforce the electrical insulation of the ballast, preclude moisture, inhibit noise, and dissipate heat
- Pre-insulated voltage leads reduce the risk of shock and shrink installation time

Features

- Vacuum-pressure impregnated with a silica-filled polyester varnish
- All core and coil ballasts below 600W utilize a UL Class H (180°C) insulation system
- C and C ballasts 600W and higher utilize a UL Class N (200°C) insulation system
- Pre-insulated voltage leads
- Ballast kits supplied with pre-wired ignitor

Application

- High bay retail, manufacturing, gymnasiums, warehouses, parking structures, outdoor

Core & Coil (71A) HPS ~LT~ 200W

Versions

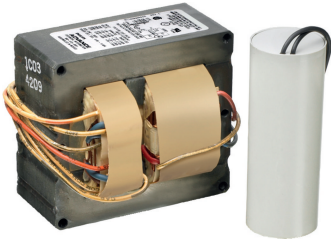

Dimensional drawing

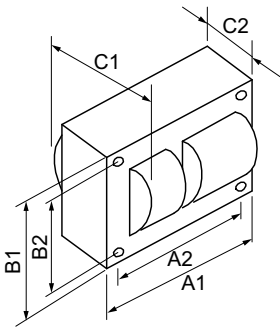

Product	C1	C2	A1	A2	B1	B2
CORE & COIL HID 71A79J3500D	3 in	1.6 in	3.9 in	3.5 in	2.8 in	2.4 in
CORE & COIL HID 71A81J3500D	4.1 in	2.8 in	3.9 in	3.5 in	2.8 in	2.4 in
CORE & COIL HID 71A80J3500D	3.3 in	2 in	3.9 in	3.5 in	2.8 in	2.4 in
CORE & COIL HID 71A8091500D	3.45 in	2 in	3.9 in	3.5 in	2.8 in	2.4 in
CORE & COIL HID 71A7971001D	2.9 in	1.52 in	3.9 in	3.5 in	2.8 in	2.4 in
CORE & COIL HID 71A8172001D	4.2 in	2.5 in	3.9 in	3.5 in	2.8 in	2.4 in
CORE & COIL HID 71A8071001D	3.45 in	2 in	3.9 in	3.5 in	2.8 in	2.4 in
CORE & COIL HID 71A7941500D	3.2 in	1.85 in	3.9 in	3.5 in	2.8 in	2.4 in

Operating and Electrical

Input Frequency 60 Hz

General Information

Number Of Lamps 1 piece/unit

Operating and Electrical

Order Code	Full Product Name	Input Voltage
		120/208/240/277 V
		480 V
		120/208/240/277 V
		120/208/240/277 V

Order Code	Full Product Name	Input Voltage
		120/208/240/277 V
		230 V
		230 V
		230 V

General Information

Order Code	Full Product Name	Capacitor Value	Lamp Type
		7 MFD	70W HPS
		7 MFD	70W HPS
		10 MFD	100W HPS
		14 MFD	150W HPS

Order Code	Full Product Name	Capacitor Value	Lamp Type
		10 MFD	100W HPS
		34 MFD	100W HPS
		55 MFD	150W HPS
		28 MFD	70W HPS

Core & Coil (71A) HPS ~LT~ 200W

