



Philips TrueLine recessed: True line of light

TrueLine, recessed

Architects need a lighting solution that matches the interior architecture of the space they are enhancing. They want a light line with elegant proportions and high light levels that offers maximum design freedom. Philips TrueLine is a flexible linear luminaire for indoor office applications that offers excellent quality with the promise of future-proof upgrades. Specifiers need luminaires that save energy, at the same time as providing the right level of light. TrueLine recessed meets both these sets of requirements. Not only is it compliant with the WELL Building Standard for Light, TrueLine recessed is rated UGR<19, which is compliant with all office norms (OC). TrueLine also comes in suspended and surface-mounted versions. All the luminaires in the family are available in different lengths, shapes, colours and light outputs. This offers the ultimate design flexibility and unlimited possibilities. TrueLine luminaires are also a sustainable, future-proof choice with high efficiency up to 140 lm/W and the option to upgrade to wireless connectivity and control.

Benefits

- Extremely high efficacy for a line luminaire
- Office compliant lighting
- Future-ready, scalable smart office capabilities
- Compatible with the Interact connected lighting system
- Supports sustainable building design and energy-saving subsidy criteria

TrueLine, recessed

Features

- Highly-uniform lighting with excellent glare control ($UGR < 19$, $L65 < 3000 \text{ cd/m}^2$)
- Best-in-class efficacy up to 140 lm/W
- 3000K, 4000K, and Tunable White versions, all CRI > 90
- Long lifetime L90@50,000 hours
- Integrated sensors/wireless drivers for data collection, occupancy, daylight regulation and wayfinding
- Environmental Product Declaration (EPD)
- Recessed, suspended and surface mounted options

Application

- Offices
- Education
- Retail

Warnings and Safety

- The product is IPX0 and, as such, is not protected against water ingress. Therefore, we strongly recommend that the environment in which the luminaire is to be installed is suitably checked.
- If the above advice is not taken and the luminaires are subject to water ingress, Philips/Signify cannot guarantee safe failure and the product warranty will become void.

Versions



TrueLine recessed-RC532B L1130



TrueLine-RC530 RC531B VPC ELP3



TrueLine-RC534B VPC



TrueLine-RC535B

Dimensional drawing

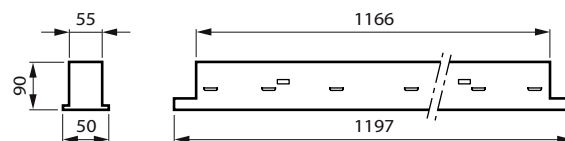
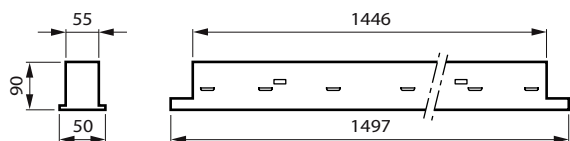

Dimensional drawing

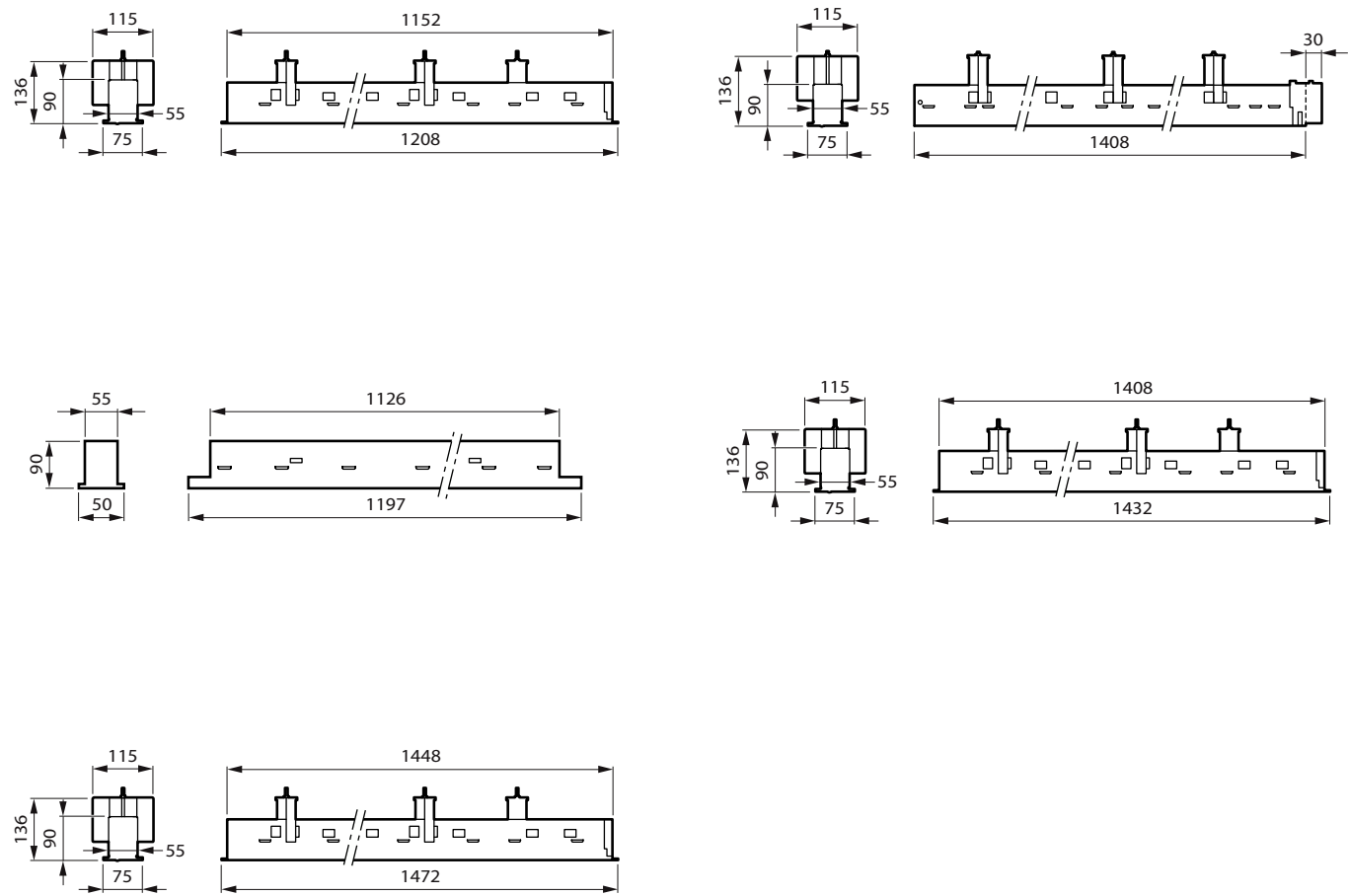

Product details

TrueLine_recessed-
RC530B_PCV_L1130-DP.tif



TrueLine-
RC530_RC531_RC534B_VPC-
DPP.tif



Product details



TrueLine-
RC530_RC531_RC532_RC533B_P
CV-1DPP.tif



TrueLine-
RC530_RC531_RC532_RC533B_P
CV-2DPP.tif



TrueLine-
RC530_RC531_RC534B_VPC_PI5-
DPP.tif



TrueLine-
RC534B_SM534C_SP534P-DPP.tif



TrueLine_Recessed-U3

General Information	
CE mark	Yes
Driver included	Yes
ENEC mark	ENEC mark
Flammability mark	For mounting on normally flammable surfaces
Glow-wire test	Temperature 650 °C, duration 30 s
Light source replaceable	No
Number of gear units	Unit
Light Technical	
Colour rendering index (CRI)	≥90
Flickering value (PstLM)	1
Stroboscopic effect	0.4
Operating and Electrical	
Input Voltage	220 to 240 V
Line Frequency	50 to 60 Hz
Temperature	
Ambient temperature range	+10 to +40 °C
Controls and Dimming	
Dimmable	Yes
Mechanical and Housing	
Housing Colour	White
Approval and Application	
Protection class IEC	Safety class I
Mech. impact protection code	IK02
Ingress protection code	IP20
Initial Performance (IEC Compliant)	
Initial chromaticity	(0.38, 0.38) SDCM <3
Luminous flux tolerance	+/-10%
Application Conditions	
Maximum dim level	1%
Suitable for random switching	No

General Information

Order Code	Full Product Name	Embedded control	Product family code
97185100	RC532B LED25S/940 PSD W8L113 VPC PI5	-	RC532B
97146200	RC530B LED15S/940 PSD W8L113 PCV PI5	-	RC530B
97159200	RC530B LED43S/940 PSD W8L141 PCV PI5	-	RC530B
97153000	RC530B LED34S/940 PSD W8L113 PCV PI5	-	RC530B
97171400	RC531B LED15S/940 PSD W8L113 PCV PI5	-	RC531B
97181300	RC532B LED15S/940 PSD W8L113 PCV PI5	-	RC532B
97178300	RC531B LED31S/940 PSD W8L141 PCV PI5	-	RC531B
97197400	RC533B LED31S/940 PSD W8L141 PCV PI5	-	RC533B
97165300	RC530B LED50S/940 PSD W8L141 PCV PI5	-	RC530B
97158500	RC530B LED40S/940 PSD W8L120 VPC PI5 IP	-	RC530B
97186800	RC532B LED31S/940 PSD W8L141 PCV PI5	-	RC532B
97164600	RC530B LED43S/940 W8L150 VPC ELP3 PI6	-	RC530B
97163900	RC530B LED43S/940 W8L145 PCV ELP3 PI6	-	RC530B
97179000	RC531B LED31S/940 W8L145 PCV ELP3 PI6	-	RC531B
97200100	RC534B LED43S/940 PSD W8L141 PCV PI5	-	RC534B
97203200	RC535B LED50S/940 PSD W8L141 PCV PI5	-	RC535B
97321300	RC530B LED43S/TW9 SIA W8L145 PCV U4 PI3	Upgradable sensor slot with SNS210 sensor	RC530B
97324400	RC530B LED34S/TW9 SIA W8L120 VPC U4 PI3	Upgradable sensor slot with SNS210 sensor	RC530B

Light Technical (1/2)

Order Code	Full Product Name	Beam angle of light source	Correlated Colour Temperature	Luminous efficacy (rated) (nom.)	Luminous Flux
97185100	RC532B LED25S/940	- degree(s)	4000 K	139 lm/W	2,500 lm

Order Code	Full Product Name	Beam angle of light source	Correlated Colour Temperature	Luminous efficacy (rated) (nom.)	Luminous Flux
	PSD W8L113 VPC PI5				

TrueLine, recessed

Order Code	Full Product Name	Beam angle of light source	Correlated Colour Temperature	Luminous efficacy (rated) (nom.)	Luminous Flux
97146200	RC530B LED15S/940 PSD W8L113 PCV PI5	- degree(s)	4000 K	127 lm/W	1,500 lm
97159200	RC530B LED43S/940 PSD W8L141 PCV PI5	- degree(s)	4000 K	144 lm/W	4,300 lm
97153000	RC530B LED34S/940 PSD W8L113 PCV PI5	- degree(s)	4000 K	145 lm/W	3,400 lm
97171400	RC531B LED15S/940 PSD W8L113 PCV PI5	- degree(s)	4000 K	106 lm/W	1,500 lm
97181300	RC532B LED15S/940 PSD W8L113 PCV PI5	- degree(s)	4000 K	127 lm/W	1,500 lm
97178300	RC531B LED31S/940 PSD W8L141 PCV PI5	- degree(s)	4000 K	110 lm/W	3,100 lm
97197400	RC533B LED31S/940 PSD W8L141 PCV PI5	- degree(s)	4000 K	110 lm/W	3,100 lm
97165300	RC530B LED50S/940 PSD W8L141 PCV PI5	- degree(s)	4000 K	142 lm/W	5,000 lm
97158500	RC530B LED40S/940	- degree(s)	4000 K	140 lm/W	4,000 lm

Order Code	Full Product Name	Beam angle of light source	Correlated Colour Temperature	Luminous efficacy (rated) (nom.)	Luminous Flux
	PSD W8L120 VPC PI5 IP				
97186800	RC532B LED31S/940 PSD W8L141 PCV PI5	- degree(s)	4000 K	148 lm/W	3,100 lm
97164600	RC530B LED43S/940 W8L150 VPC ELP3 PI6	- degree(s)	4000 K	144 lm/W	4,300 lm
97163900	RC530B LED43S/940 W8L145 PCV ELP3 PI6	- degree(s)	4000 K	144 lm/W	4,300 lm
97179000	RC531B LED31S/940 W8L145 PCV ELP3 PI6	- degree(s)	4000 K	110 lm/W	3,100 lm
97200100	RC534B LED43S/940 PSD W8L141 PCV PI5	- degree(s)	4000 K	138 lm/W	4,300 lm
97203200	RC535B LED50S/940 PSD W8L141 PCV PI5	- degree(s)	4000 K	132 lm/W	5,000 lm
97321300	RC530B LED43S/TW9 SIA W8L145 PCV U4 PI3	120 degree(s)	Tunable white 2700-6500 K	121 lm/W	4,300 lm
97324400	RC530B LED34S/TW9 SIA W8L120 VPC U4 PI3	120 degree(s)	Tunable white 2700-6500 K	124 lm/W	3,400 lm

Light Technical (2/2)

Order Code	Full Product Name	Optic type
97185100	RC532B LED25S/940 PSD W8L113 VPC PI5	Wide beam
97146200	RC530B LED15S/940 PSD W8L113 PCV PI5	Wide beam
97159200	RC530B LED43S/940 PSD W8L141 PCV PI5	Wide beam
97153000	RC530B LED34S/940 PSD W8L113 PCV PI5	Wide beam
97171400	RC531B LED15S/940 PSD W8L113 PCV PI5	Wide beam
97181300	RC532B LED15S/940 PSD W8L113 PCV PI5	Wide beam
97178300	RC531B LED31S/940 PSD W8L141 PCV PI5	Wide beam
97197400	RC533B LED31S/940 PSD W8L141 PCV PI5	Wide beam
97165300	RC530B LED50S/940 PSD W8L141 PCV PI5	Wide beam

Order Code	Full Product Name	Optic type
97158500	RC530B LED40S/940 PSD W8L120 VPC PI5 IP	Wide beam
97186800	RC532B LED31S/940 PSD W8L141 PCV PI5	Wide beam
97164600	RC530B LED43S/940 W8L150 VPC ELP3 PI6	Wide beam
97163900	RC530B LED43S/940 W8L145 PCV ELP3 PI6	Wide beam
97179000	RC531B LED31S/940 W8L145 PCV ELP3 PI6	Wide beam
97200100	RC534B LED43S/940 PSD W8L141 PCV PI5	Asymmetrical mirror
97203200	RC535B LED50S/940 PSD W8L141 PCV PI5	Asymmetrical mirror
97321300	RC530B LED43S/TW9 SIA W8L145 PCV U4 PI3	Wide beam
97324400	RC530B LED34S/TW9 SIA W8L120 VPC U4 PI3	Wide beam

Operating and Electrical

Order Code	Full Product Name	Power Consumption
97185100	RC532B LED25S/940 PSD W8L113 VPC PI5	18 W
97146200	RC530B LED15S/940 PSD W8L113 PCV PI5	12.2 W
97159200	RC530B LED43S/940 PSD W8L141 PCV PI5	30.5 W
97153000	RC530B LED34S/940 PSD W8L113 PCV PI5	24.5 W
97171400	RC531B LED15S/940 PSD W8L113 PCV PI5	14.6 W
97181300	RC532B LED15S/940 PSD W8L113 PCV PI5	12.2 W
97178300	RC531B LED31S/940 PSD W8L141 PCV PI5	29 W
97197400	RC533B LED31S/940 PSD W8L141 PCV PI5	29 W
97165300	RC530B LED50S/940 PSD W8L141 PCV PI5	36 W

Order Code	Full Product Name	Power Consumption
97158500	RC530B LED40S/940 PSD W8L120 VPC PI5 IP	29 W
97186800	RC532B LED31S/940 PSD W8L141 PCV PI5	21 W
97164600	RC530B LED43S/940 W8L150 VPC ELP3 PI6	30.5 W
97163900	RC530B LED43S/940 W8L145 PCV ELP3 PI6	30.5 W
97179000	RC531B LED31S/940 W8L145 PCV ELP3 PI6	29 W
97200100	RC534B LED43S/940 PSD W8L141 PCV PI5	32 W
97203200	RC535B LED50S/940 PSD W8L141 PCV PI5	38 W
97321300	RC530B LED43S/TW9 SIA W8L145 PCV U4 PI3	35.5 W
97324400	RC530B LED34S/TW9 SIA W8L120 VPC U4 PI3	27.5 W

