

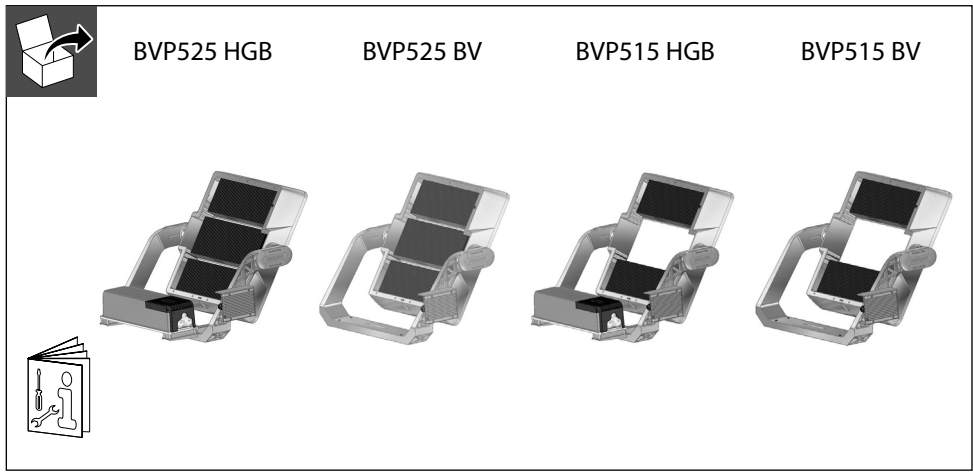









**PHILIPS**

OptiVision LED gen2  
Floodlight

BVP525/BVP515

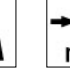

Type	LIFE L80B10	led color	lumen	W +/-10%	outdoor	indoor	outdoor	HGB	15°	40°	BV	15°	40°
BVP525	100000h	757	202000	1471	15° C	-	-40° C	31,5	0,39	0,48	25	0,23	0,32
BVP525	100000h	757	193000	1392	20° C	-	-40° C	31,5	0,39	0,48	25	0,23	0,32
BVP525	100000h	757	186000	1314	25° C	-	-40° C	31,5	0,39	0,48	25	0,23	0,32
BVP525	100000h	757	178000	1236	30° C	-	-40° C	31,5	0,39	0,48	25	0,23	0,32
BVP525	100000h	757	170000	1160	35° C	-	-40° C	31,5	0,39	0,48	25	0,23	0,32
BVP525	100000h	757	161000	1082	40° C	-	-40° C	31,5	0,39	0,48	25	0,23	0,32
BVP525	100000h	757	148000	964	45° C	-	-40° C	31,5	0,39	0,48	25	0,23	0,32
BVP525	100000h	757	148000	964	-	35° C	-40° C	31,5	0,39	0,48	25	0,23	0,32
BVP525	100000h	757	134000	845	-	45° C	-40° C	31,5	0,39	0,48	25	0,23	0,32
BVP525	100000h	740	194000	1471	15° C	-	-40° C	31,5	0,39	0,48	25	0,23	0,32
BVP525	100000h	740	187000	1392	20° C	-	-40° C	31,5	0,39	0,48	25	0,23	0,32
BVP525	100000h	740	180000	1314	25° C	-	-40° C	31,5	0,39	0,48	25	0,23	0,32
BVP525	100000h	740	172000	1236	30° C	-	-40° C	31,5	0,39	0,48	25	0,23	0,32
BVP525	100000h	740	164000	1160	35° C	-	-40° C	31,5	0,39	0,48	25	0,23	0,32
BVP525	100000h	740	155000	1082	40° C	-	-40° C	31,5	0,39	0,48	25	0,23	0,32
BVP525	100000h	740	143000	964	45° C	-	-40° C	31,5	0,39	0,48	25	0,23	0,32
BVP525	100000h	740	143000	964	-	35° C	-40° C	31,5	0,39	0,48	25	0,23	0,32
BVP525	100000h	740	130000	845	-	45° C	-40° C	31,5	0,39	0,48	25	0,23	0,32
BVP525	50000h	757	202000	1471	15° C	-	-40° C	31,5	0,39	0,48	25	0,23	0,32
BVP525	50000h	757	202000	1471	20° C	-	-40° C	31,5	0,39	0,48	25	0,23	0,32
BVP525	50000h	757	202000	1471	25° C	-	-40° C	31,5	0,39	0,48	25	0,23	0,32
BVP525	50000h	757	193000	1392	30° C	-	-40° C	31,5	0,39	0,48	25	0,23	0,32
BVP525	50000h	757	186000	1314	35° C	-	-40° C	31,5	0,39	0,48	25	0,23	0,32
BVP525	50000h	757	178000	1236	40° C	-	-40° C	31,5	0,39	0,48	25	0,23	0,32
BVP525	50000h	757	170000	1160	45° C	-	-40° C	31,5	0,39	0,48	25	0,23	0,32
BVP525	50000h	757	170000	1160	-	35° C	-40° C	31,5	0,39	0,48	25	0,23	0,32
BVP525	50000h	757	148000	964	-	45° C	-40° C	31,5	0,39	0,48	25	0,23	0,32

Type	LIFE L80B10	 led color	lumen	W +/-10%	 outdoor	 indoor	 outdoor	 HGB	 15°	 40°	 BV	 15°	 40°
BVP525	50000h	740	194000	1471	15° C	-	-40° C	31,5	0,39	0,48	25	0,23	0,32
BVP525	50000h	740	194000	1471	20° C	-	-40° C	31,5	0,39	0,48	25	0,23	0,32
BVP525	50000h	740	194000	1471	25° C	-	-40° C	31,5	0,39	0,48	25	0,23	0,32
BVP525	50000h	740	187000	1392	30° C	-	-40° C	31,5	0,39	0,48	25	0,23	0,32
BVP525	50000h	740	180000	1314	35° C	-	-40° C	31,5	0,39	0,48	25	0,23	0,32
BVP525	50000h	740	172000	1236	40° C	-	-40° C	31,5	0,39	0,48	25	0,23	0,32
BVP525	50000h	740	164000	1160	45° C	-	-40° C	31,5	0,39	0,48	25	0,23	0,32
BVP525	50000h	740	164000	1160	-	35° C	-40° C	31,5	0,39	0,48	25	0,23	0,32
BVP525	50000h	740	143000	964	-	45° C	-40° C	31,5	0,39	0,48	25	0,23	0,32
BVP515	100000h	757	134000	981	15° C	-	-40° C	28	0,34	0,4	22	0,18	0,24
BVP515	100000h	757	129000	928	20° C	-	-40° C	28	0,34	0,4	21	0,18	0,24
BVP515	100000h	757	124000	876	25° C	-	-40° C	28	0,34	0,4	21	0,18	0,24
BVP515	100000h	757	119000	824	30° C	-	-40° C	28	0,34	0,4	21	0,18	0,24
BVP515	100000h	757	113000	773	35° C	-	-40° C	28	0,34	0,4	21	0,18	0,24
BVP515	100000h	757	107000	722	40° C	-	-40° C	28	0,34	0,4	21	0,18	0,24
BVP515	100000h	757	99000	643	45° C	-	-40° C	28	0,34	0,4	21	0,18	0,24
BVP515	100000h	757	99000	643	-	35° C	-40° C	28	0,34	0,4	21	0,18	0,24
BVP515	100000h	757	89000	564	-	45° C	-40° C	28	0,34	0,4	21	0,18	0,24
BVP515	100000h	740	129000	981	15° C	-	-40° C	28	0,34	0,4	21	0,18	0,24
BVP515	100000h	740	125000	928	20° C	-	-40° C	28	0,34	0,4	21	0,18	0,24
BVP515	100000h	740	120000	876	25° C	-	-40° C	28	0,34	0,4	21	0,18	0,24
BVP515	100000h	740	114000	824	30° C	-	-40° C	28	0,34	0,4	21	0,18	0,24
BVP515	100000h	740	109000	773	35° C	-	-40° C	28	0,34	0,4	21	0,18	0,24
BVP515	100000h	740	104000	722	40° C	-	-40° C	28	0,34	0,4	21	0,18	0,24
BVP515	100000h	740	96000	643	45° C	-	-40° C	28	0,34	0,4	21	0,18	0,24
BVP515	100000h	740	96000	643	-	35° C	-40° C	28	0,34	0,4	21	0,18	0,24
BVP515	100000h	740	86000	564	-	45° C	-40° C	28	0,34	0,4	21	0,18	0,24
BVP515	50000h	757	134000	981	15° C	-	-40° C	28	0,34	0,4	21	0,18	0,24
BVP515	50000h	757	134000	981	20° C	-	-40° C	28	0,34	0,4	21	0,18	0,24
BVP515	50000h	757	134000	981	25° C	-	-40° C	28	0,34	0,4	21	0,18	0,24
BVP515	50000h	757	129000	928	30° C	-	-40° C	28	0,34	0,4	21	0,18	0,24
BVP515	50000h	757	124000	876	35° C	-	-40° C	28	0,34	0,4	21	0,18	0,24
BVP515	50000h	757	119000	824	40° C	-	-40° C	28	0,34	0,4	21	0,18	0,24
BVP515	50000h	757	113000	773	45° C	-	-40° C	28	0,34	0,4	21	0,18	0,24
BVP515	50000h	757	113000	773	-	35° C	-40° C	28	0,34	0,4	21	0,18	0,24
BVP515	50000h	757	99000	643	-	45° C	-40° C	28	0,34	0,4	21	0,18	0,24
BVP515	50000h	740	129000	981	15° C	-	-40° C	28	0,34	0,4	21	0,18	0,24
BVP515	50000h	740	129000	981	20° C	-	-40° C	28	0,34	0,4	21	0,18	0,24
BVP515	50000h	740	129000	981	25° C	-	-40° C	28	0,34	0,4	21	0,18	0,24
BVP515	50000h	740	125000	928	30° C	-	-40° C	28	0,34	0,4	21	0,18	0,24
BVP515	50000h	740	120000	876	35° C	-	-40° C	28	0,34	0,4	21	0,18	0,24
BVP515	50000h	740	114000	824	40° C	-	-40° C	28	0,34	0,4	21	0,18	0,24
BVP515	50000h	740	109000	773	45° C	-	-40° C	28	0,34	0,4	21	0,18	0,24
BVP515	50000h	740	109000	773	-	35° C	-40° C	28	0,34	0,4	21	0,18	0,24
BVP515	50000h	740	96000	643	-	45° C	-40° C	28	0,34	0,4	21	0,18	0,24

Any modification on the luminaire will cancel the warranty

Tolerances on weight: +/-10%

Tolerances on light flux: +/- 7%

Tolerances on system power: +/-10%

Tolerances on CCT: +/-400°K

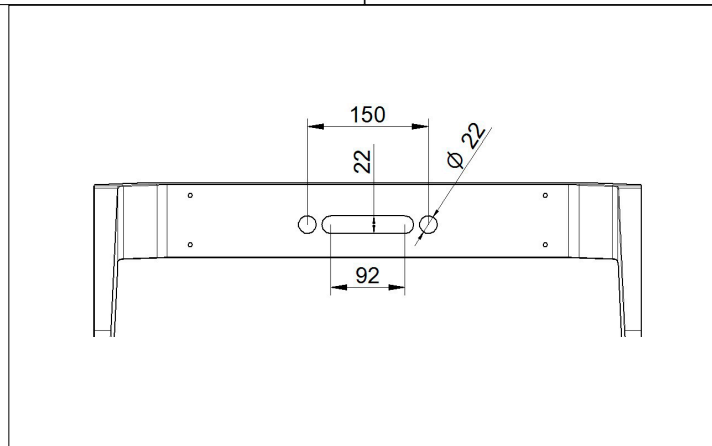
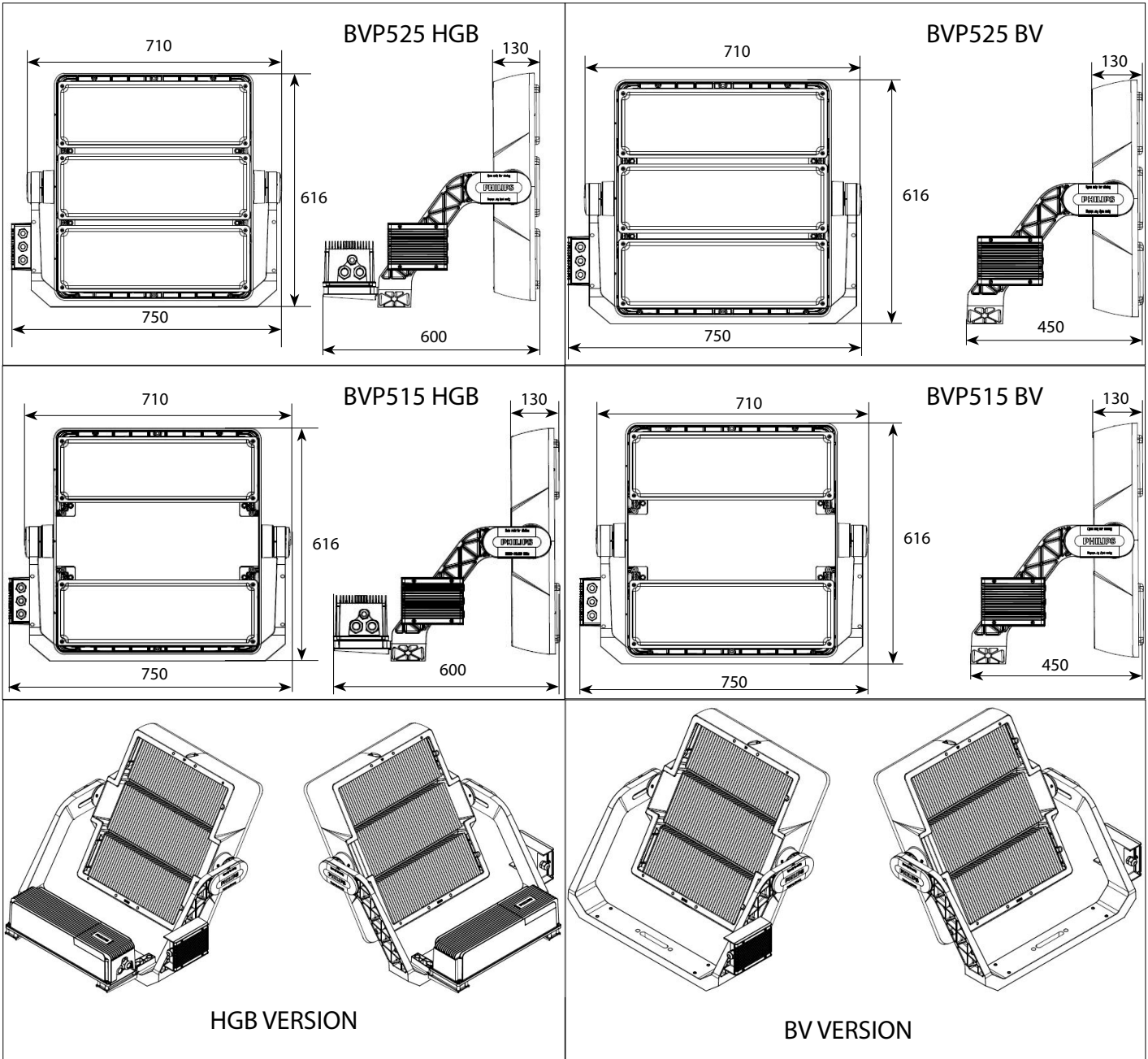

BRACKET FIXATION DETAIL



In luminaire version for swimming pool applications (SWP):  
 Fixture mounting system (including fasteners) needs to be compliant with EN 13451-1 or MIS 1203  
 Mounting system and product shall be a subject of periodical inspection at least every year.  
 Any rusted element needs to be replaced.

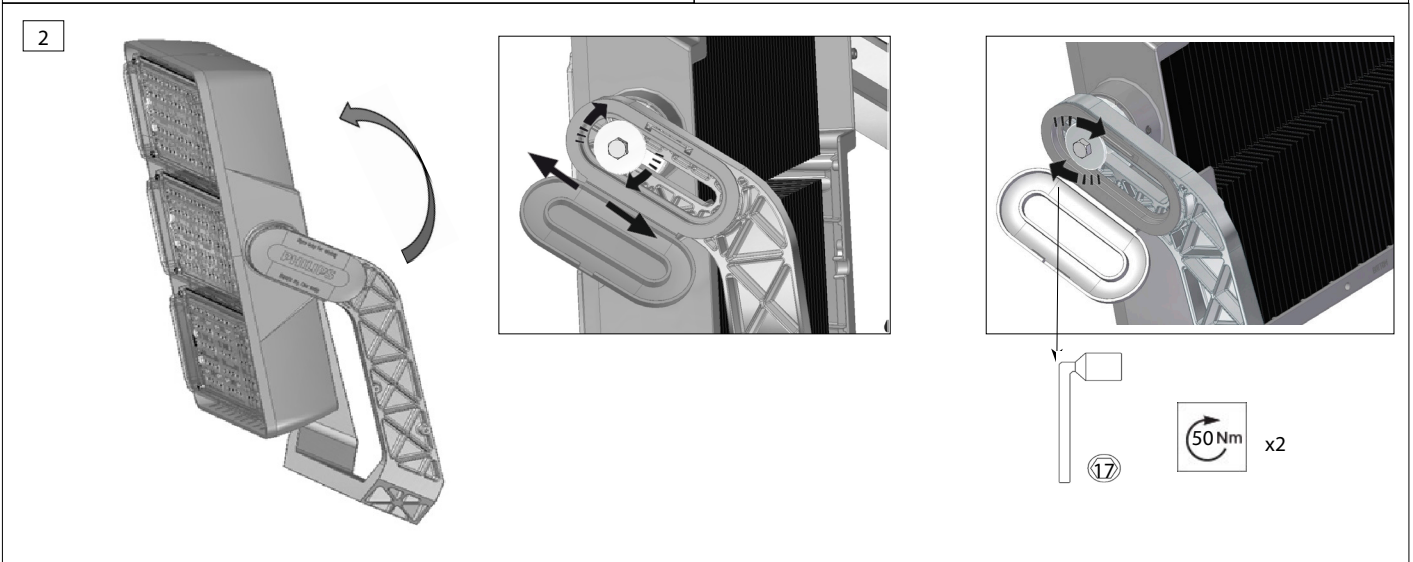
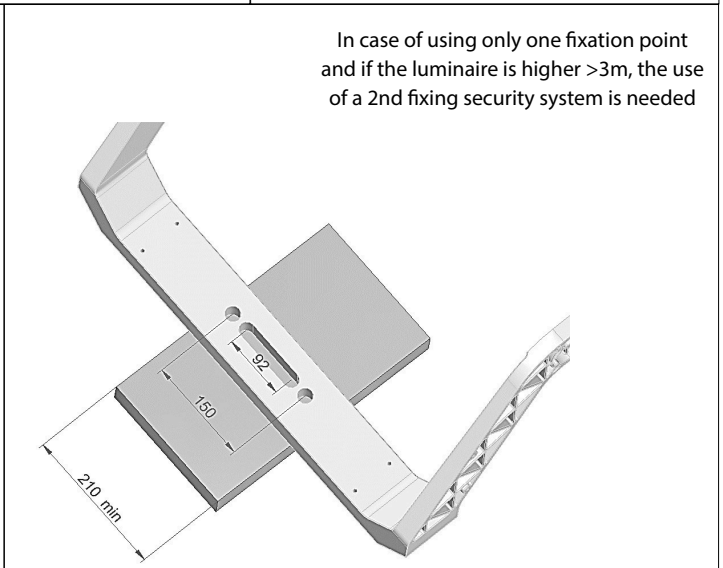
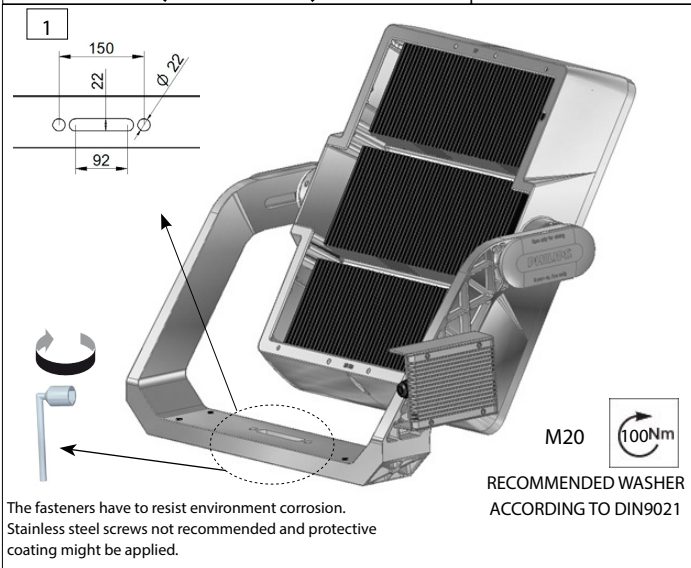
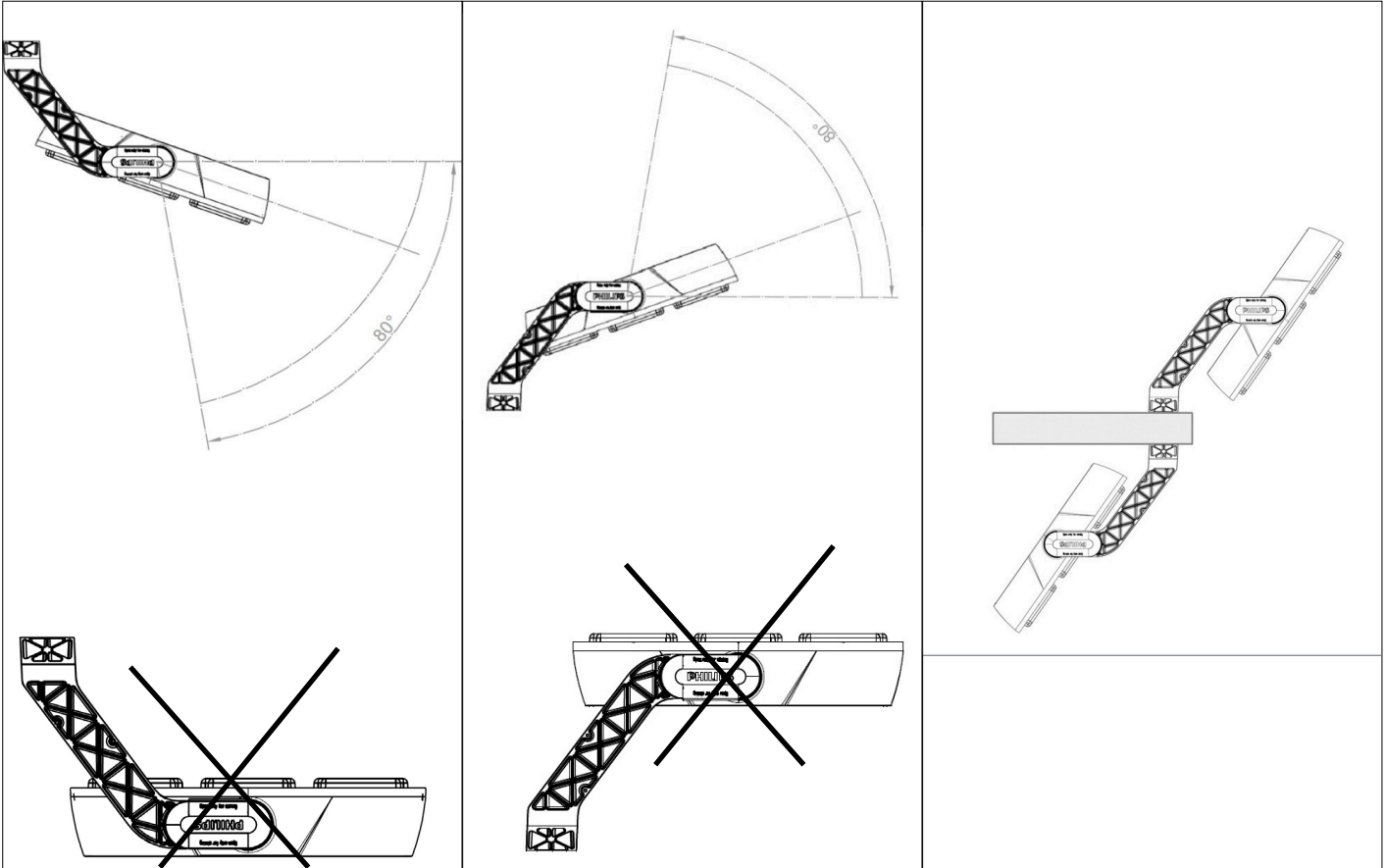



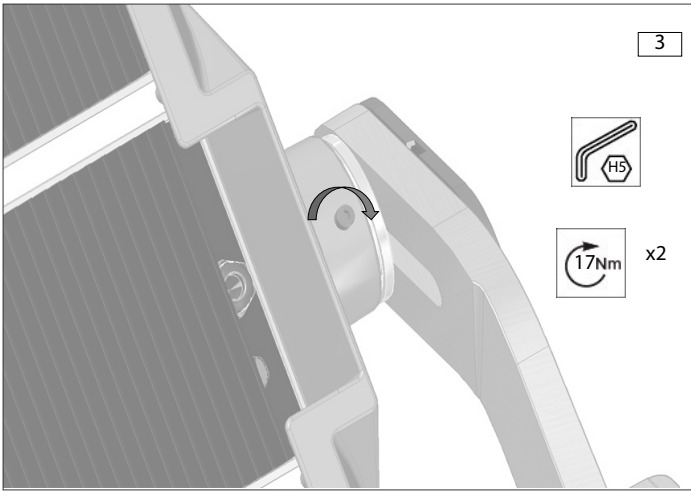

MAINTENANCE

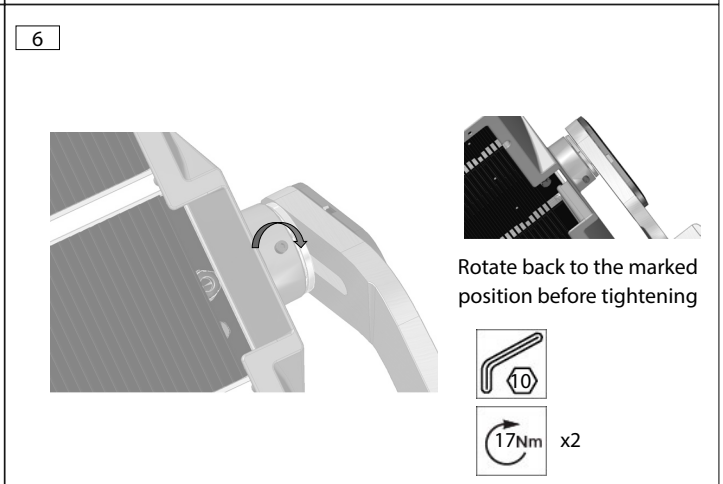
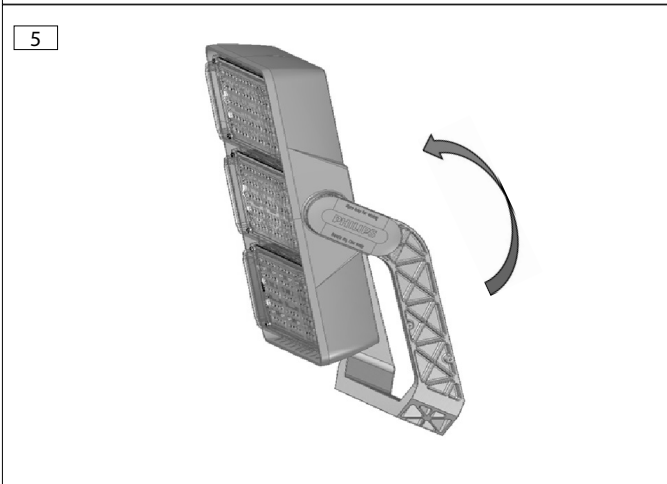
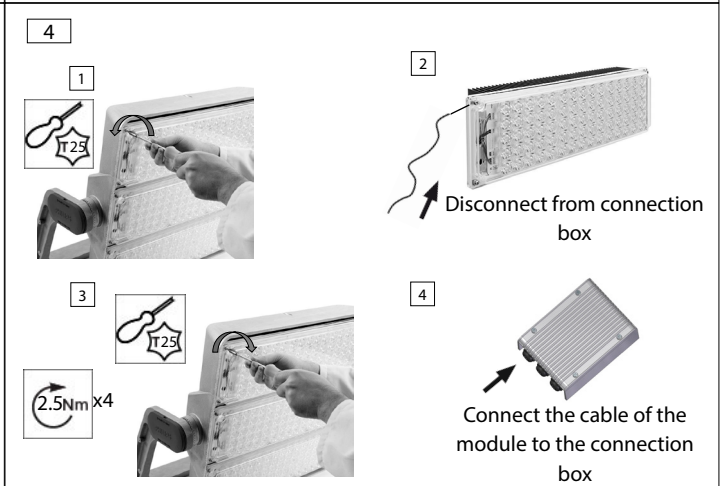
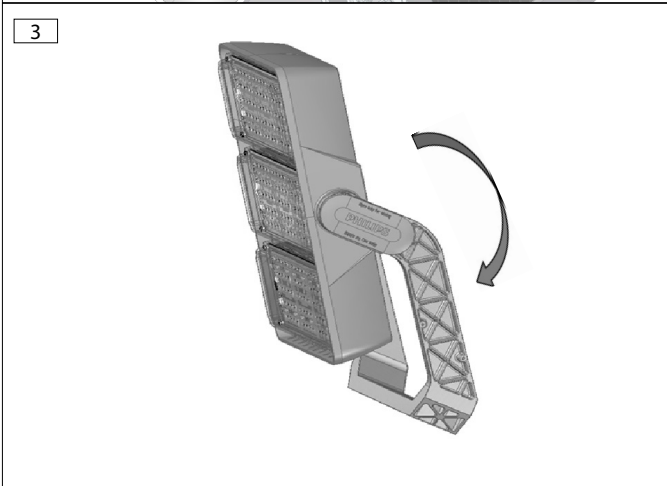
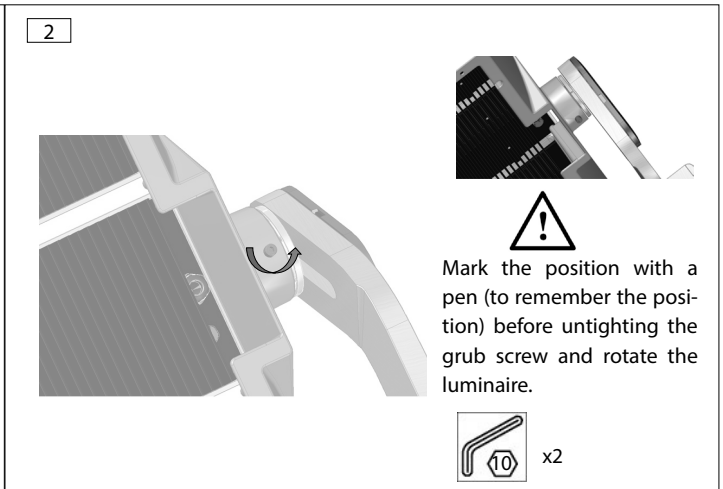
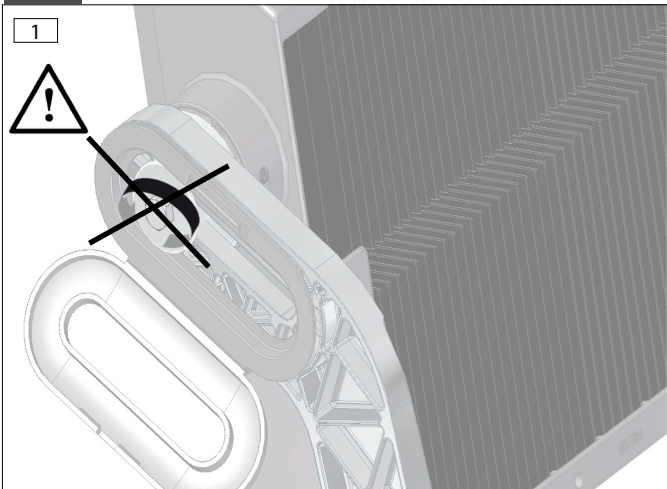

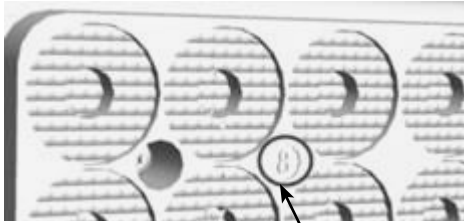

OPTIC TYPE  
S2 TO S8

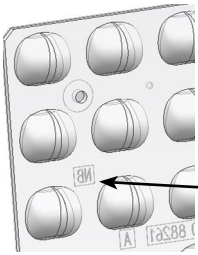

OPTIC TYPE  
NB/MB/WB/VBW

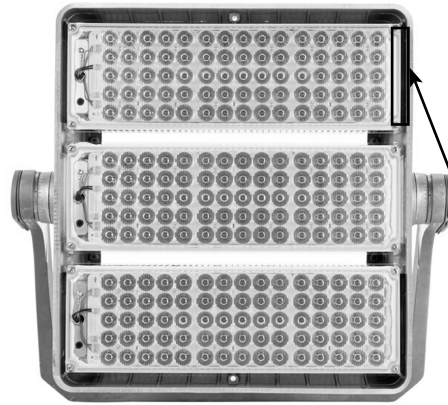

LIGHT MODULE LABEL  
12 NC: 9123XXXXXXXX  
I: 0,8-2,0 A  
Tc: 90°C



## CLEANING

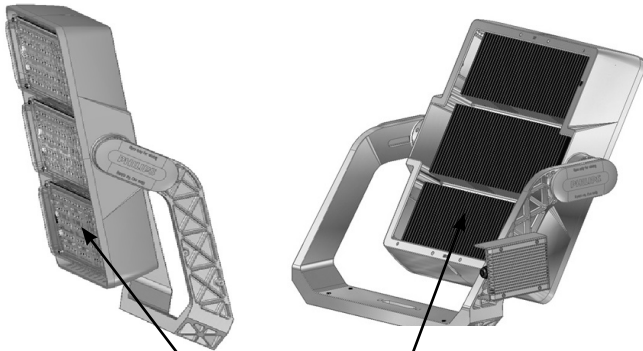

CLEANING PARTS

1. Remove physical elements that can block and modify the aircooling (heatsink fins)
2. Cleaning Frequency (depending on installation place and environment)

Cleaning Interval (months)	Pollution Category		
	High	Medium	Low
6	0,91	0,92	0,96
12	0,86	0,88	0,94
18	0,83	0,85	0,92
24	0,81	0,83	0,91
36	0,79	0,82	0,9

## OPTICAL COVER

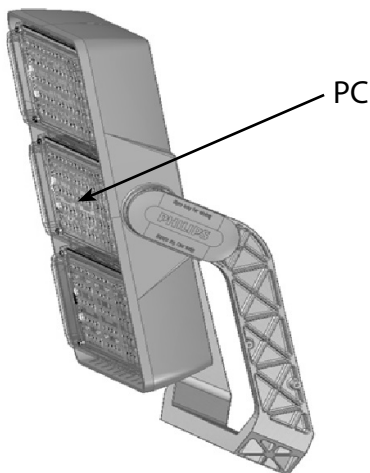

## CLEANING TECHNIQUES

1. Always test the sample with the cleaner and according to the chosen technique before
2. Do not leave cleaners on plastic parts for a long period
3. Do not apply cleaners in direct sunlight or at elevated temperatures



RECOMMENDED
Mild Soap
Lukewarm Water
Soft/Grid free Cloth
Sponge
Water Cleaning

FORBIDDEN
Abrasive Cleaners
Highly Alkaline Cleaners
Aromatic Solvents
Halogenated Solvents
Brushes
Steel Wood
Squeegess, razorblades



The list is not exhaustive

# ACCESORIES

## LOUVRE

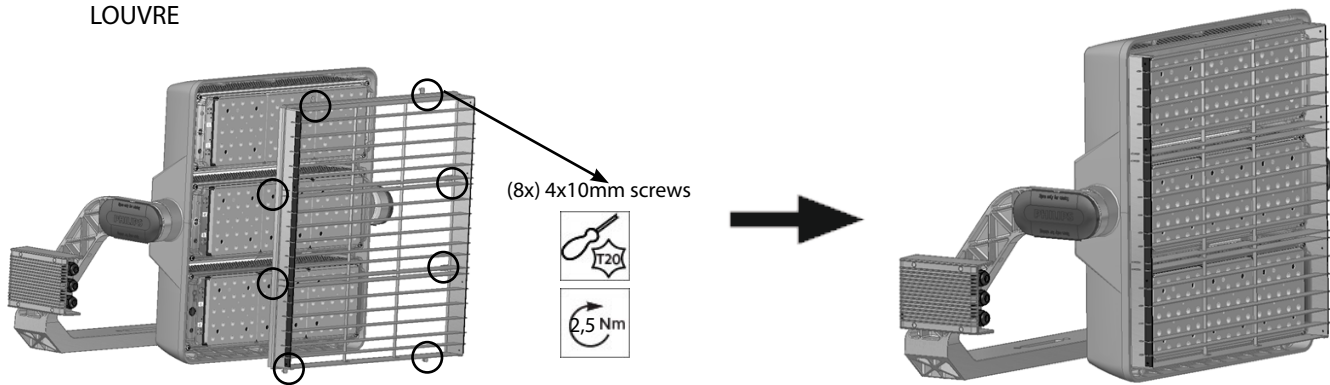

12NC: 912300022867 (ZVP520 L-A90): External zero candela louvre  
 12NC: 912300022588 (ZVP420 L): External spill-light control louvre

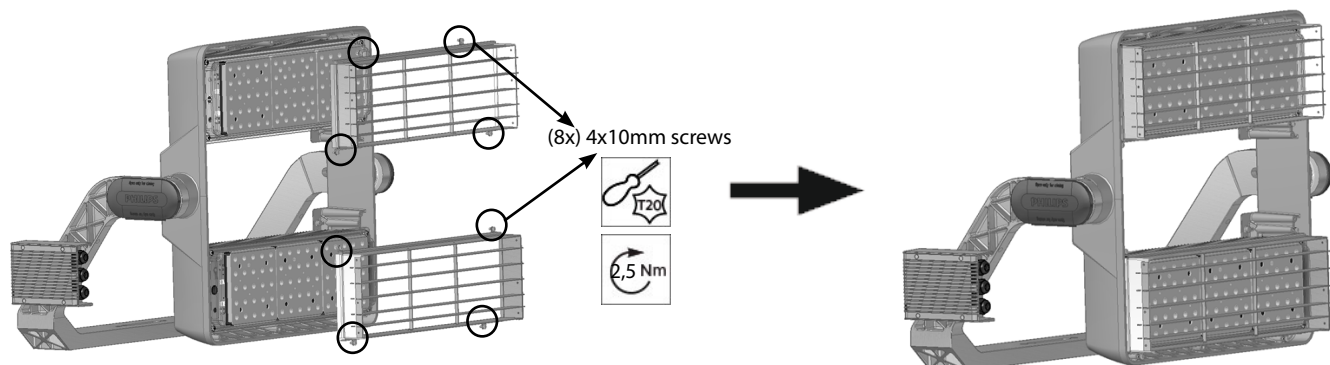

12NC: 912300022990 (ZVP520 L-A90): External zero candela louvre  
 12NC: 912300022989 (ZVP500 L): External spill-light control louvre

## PRECISION AIMING DEVICE

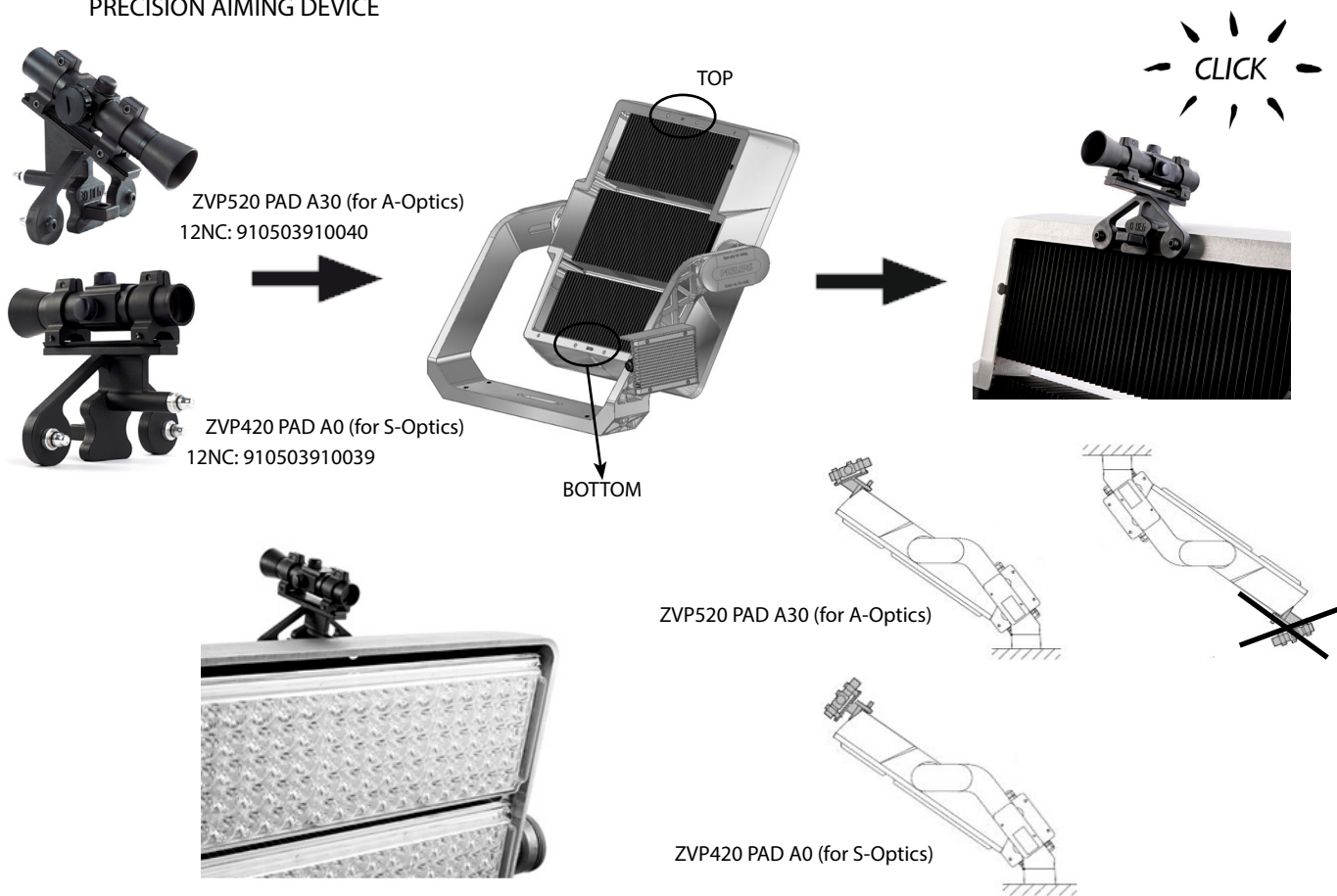

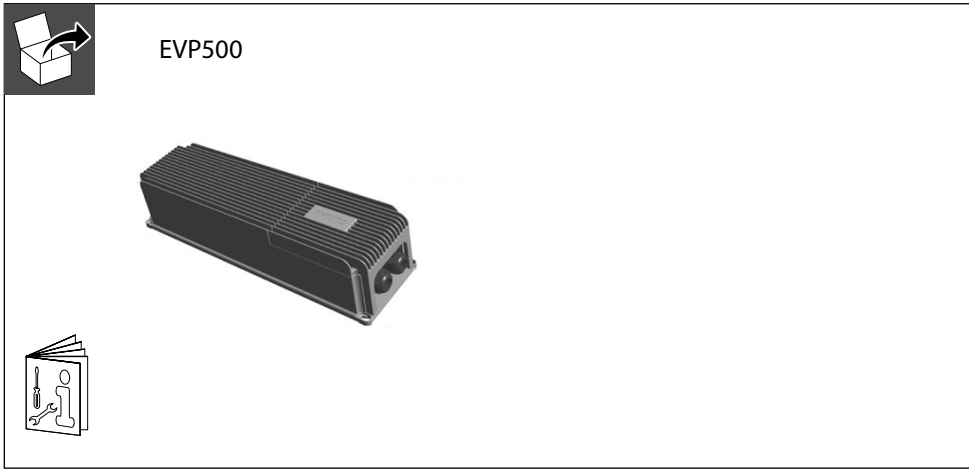
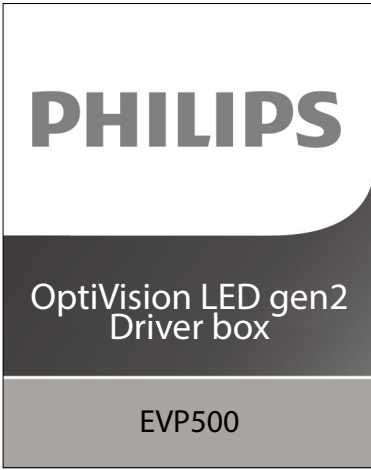

6

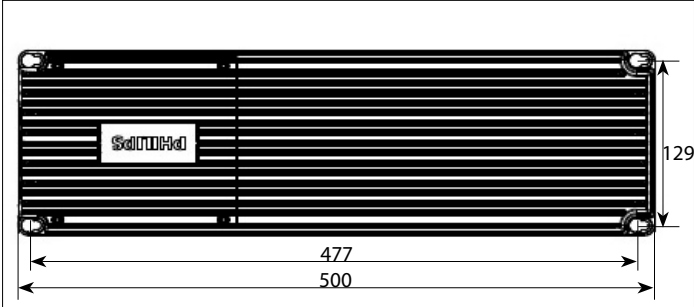
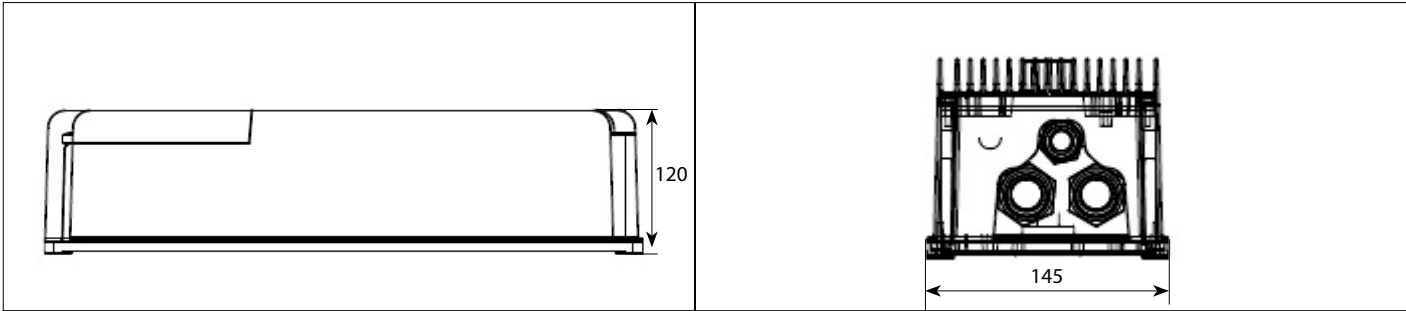

Driver box Features

Iin (Mains 220V-230V)	8A
Iin (Mains 380V-400V)	4.6A
Inrush (220V-230V)	20 A during 160 µs
Inrush (380V-400V)	30 A during 160 µs
Power Factor	> 0.95 at full power
Surge Protection	10kV Com. Mode 6kV Dif. Mode
Maximum Heat Disipation*	75W

\* According to the maximum heat disipation, a thermal study should be done for a cabinet installation

Distances between driver and luminaire

L<50	page 9
50<L<200	page 11

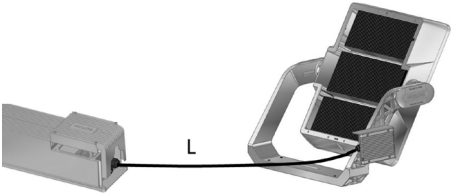





# ELECTRICAL CONNECTION L<50m

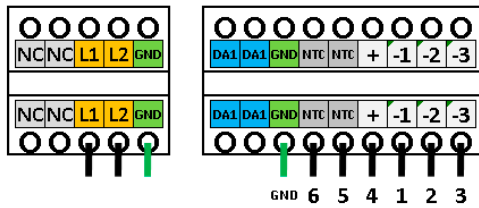
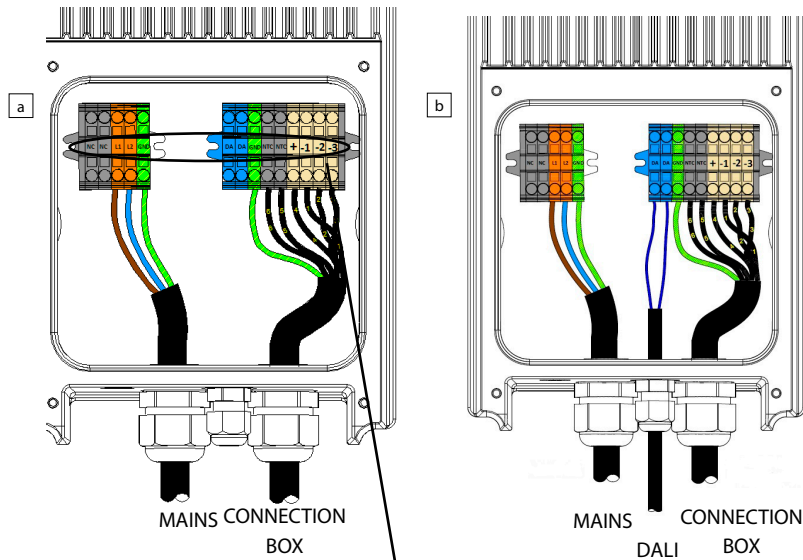
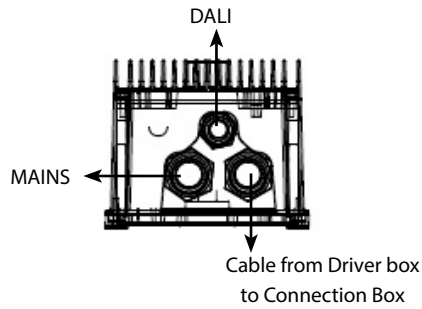
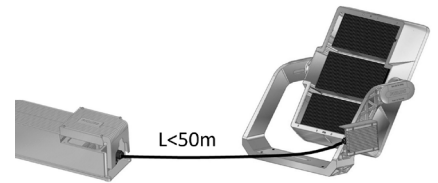
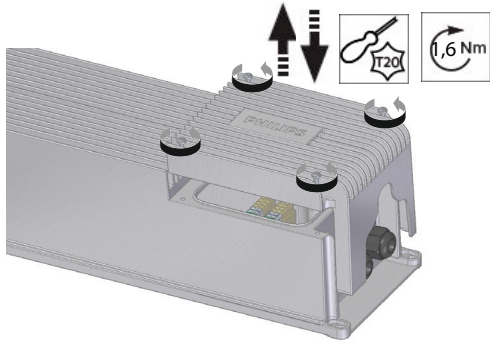

		Ø min	Ø max	TORQUE	MAX VOLTAGE SUPPORTED	RECOMMENDED CABLE TYPE	CONNECTOR SECTION MAX
DALI Cable	M20	Ø10	Ø14	3 Nm	1000 V		
MAINS Cable	M25	Ø13	Ø18	8 Nm	1000 V	H07RN-F 450V/750V	4 mm <sup>2</sup>
Connection Box	M25	Ø13	Ø18	8 Nm	1000 V	H07RN-F 450V/750 or A11VV U-600/1000V	2.5 mm <sup>2</sup>



# WIRING CONNECTION BOX L<50m

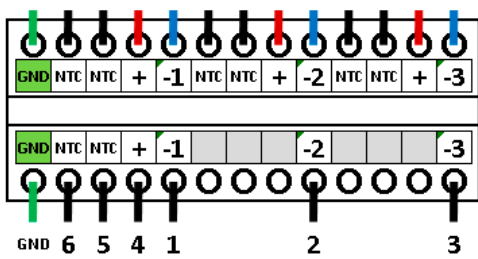
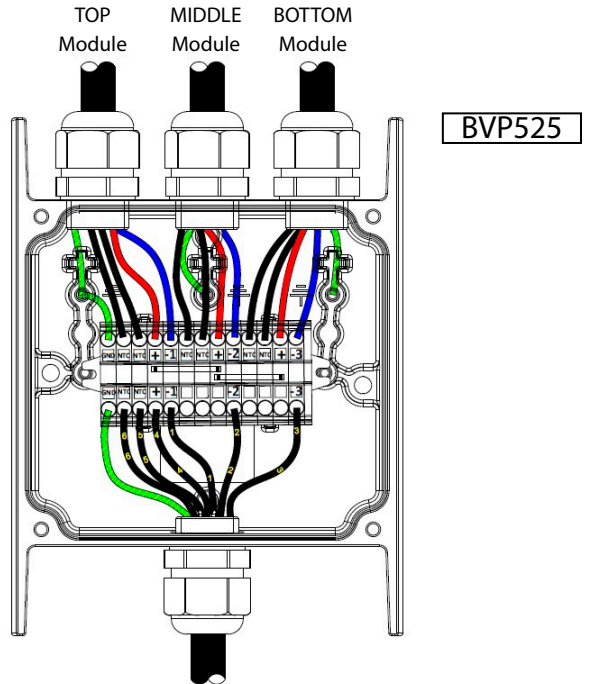
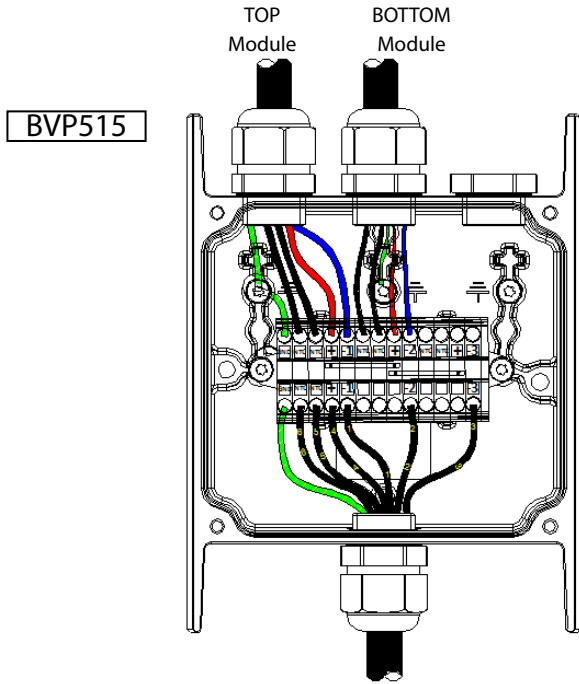
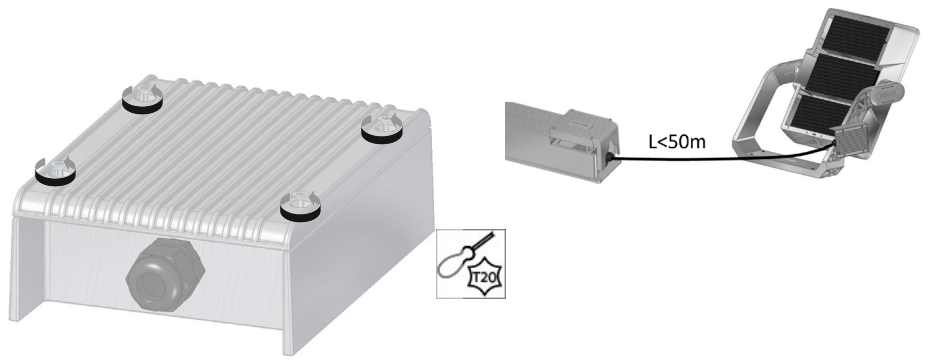

		CABLE DIAMETER RANGE	MAX VOLTAGE SUPPORTED	RECOMMENDED CABLE TYPE
L<25m	7G1.5	Ø13-Ø18	1000 V	H07RN-F 450V/750 or A11VV U-600/1000V
L<50m	7G2.5	Ø13-Ø18	1000 V	H07RN-F 450V/750 or A11VV U-600/1000V
50m<L<200m	8G2.5	Ø13-Ø18	1000 V	H07RN-F 450V/750 or A11VV U-600/1000V



CABLE NOT SUPPLIED BY PHILIPS IN VERSION BV

		Ø min	Ø max	TORQUE
Cables to Modules	M20	Ø10	Ø14	3 Nm
Cable to Driver box	M25	Ø13	Ø18	8 Nm





# ELECTRICAL CONNECTION 50m<L<200m

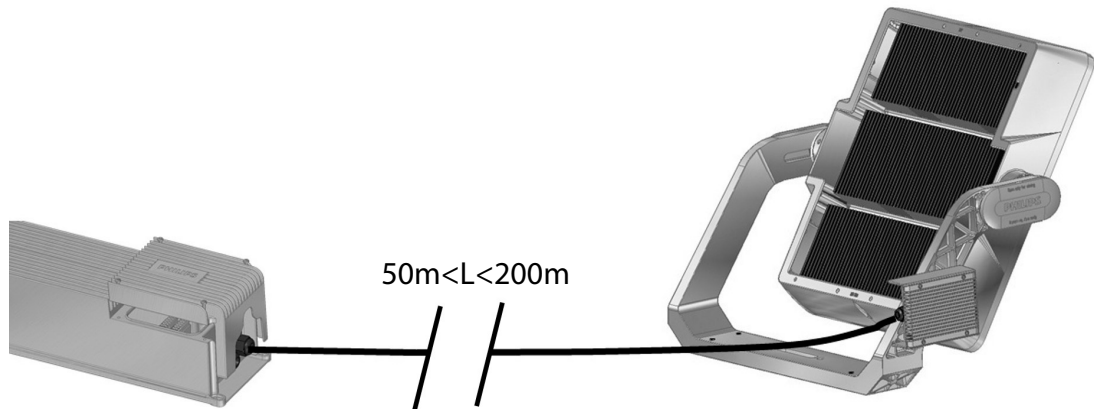

CABLE NOT SUPPLIED BY PHILIPS IN VERSION BV  
8G2,5 mm<sup>2</sup> cable

DRIVER

LUMINARY

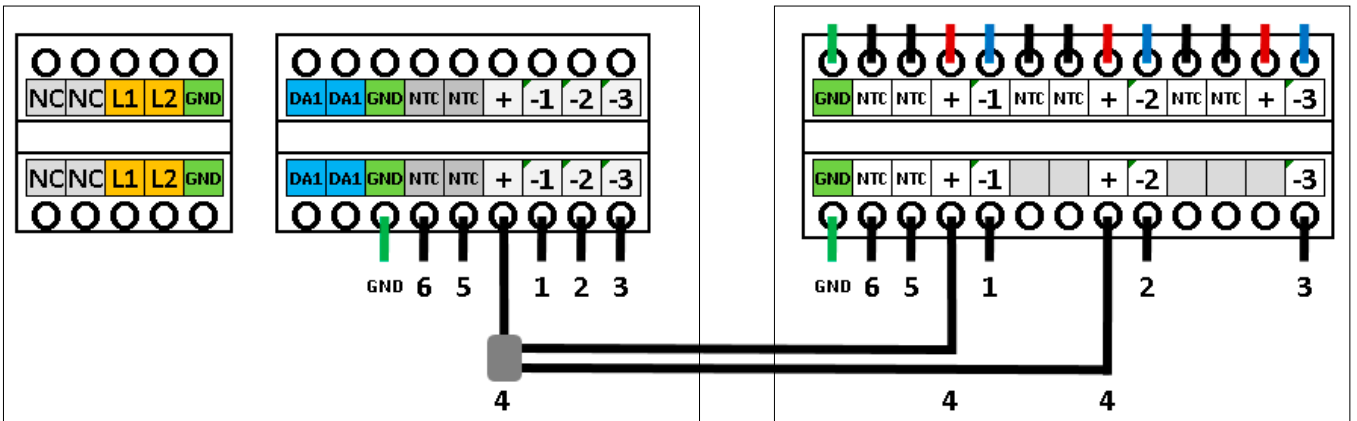

SPLITTER NOT SUPPLIED BY PHILIPS



## Installation of drivers boxes on cabinet

### ORIENTATION

Each driver box in the cabinet has to be in vertical position

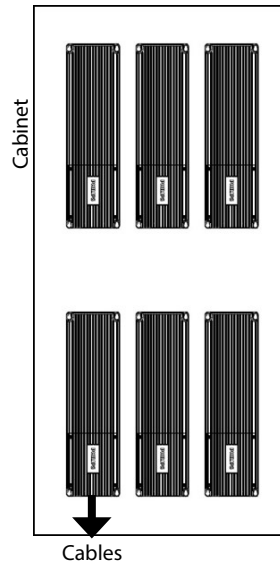

### DISTANCES

The distances between driver boxes or wall have to be higher than:

Item	Distance
1, 3	Min 50mm
2	Min 80mm
4	Min 150mm
5	Min 200mm

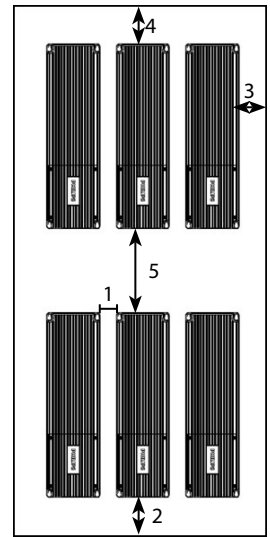

### TEMPERATURES

MAXIMUM Relative Humidity:  
95% -> Storage & Transport  
90% -> Operating (no condensation allowed)

A temperature sensor must be installed inside the cabinet between two driver boxes.  
The temperature measured by the sensor has to be lower than 45°C.  
We recommend a cabinet protected against solar action.

An active cooling can be added in the cabinet to guarantee a maximum temperature of 45°C all along the year

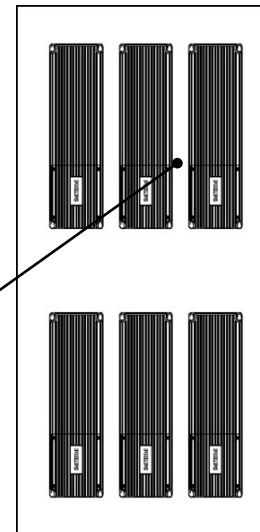





## Installation of driver boxes in the mast

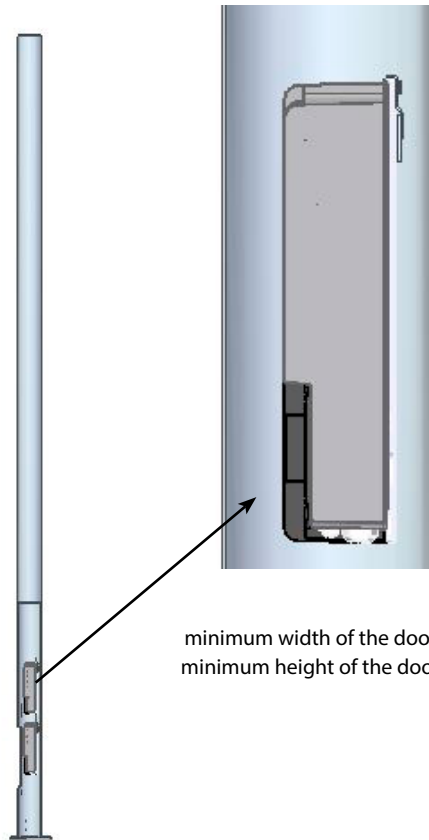

minimum width of the door: 125mm  
minimum height of the door: 600mm

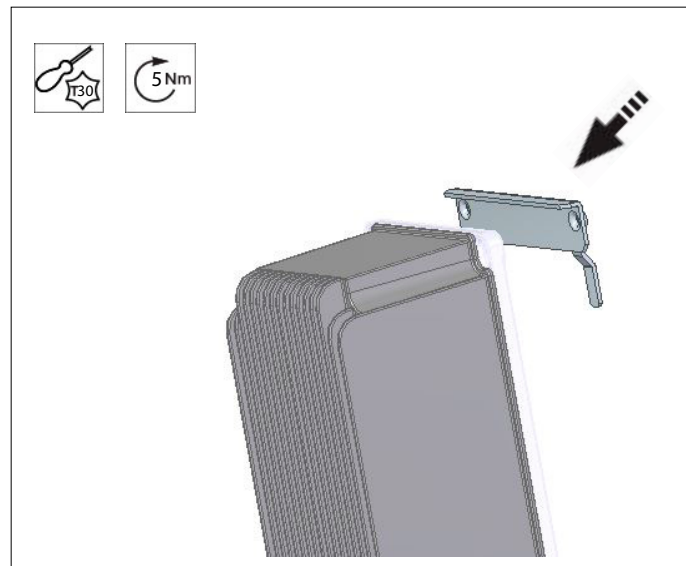

Depending of the driver fixation in the mast, please select the most suitable hook.



Installation of driver boxes on the bracket or in horizontal position

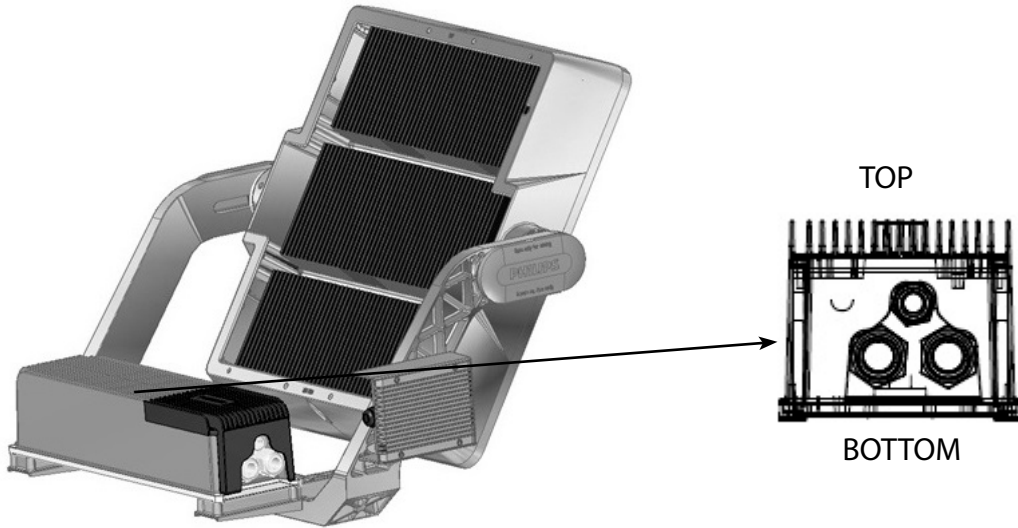

Breathers cannot be exposed directly to water

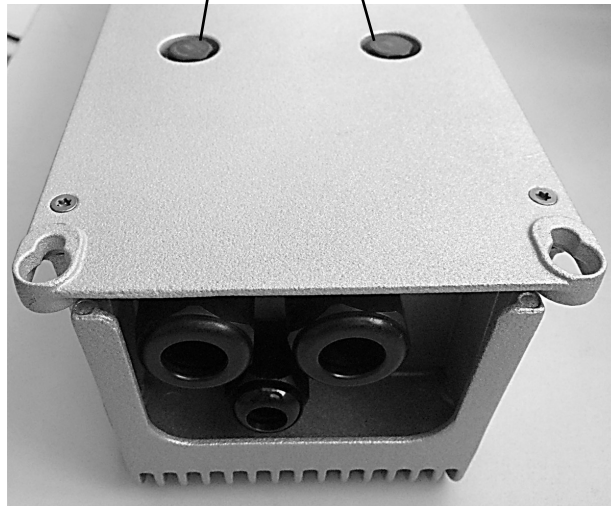



Maximum number of luminaires to be connected to standard circuit breakers (fuse)

BVP515	Mains voltage	Max Nr luminaires connected
MCB 16A A type	220V-230V	2
MCB 16A B type	220V-230V	2
MCB 32A A type	220V-230V	5
MCB 32A B type	220V-230V	5
MCB 16A A type	380V-400V	5
MCB 16A B type	380V-400V	5

BVP525	Mains voltage	Max Nr luminaires connected
MCB 16A A type	220V-230V	1
MCB 16A B type	220V-230V	1
MCB 32A A type	220V-230V	3
MCB 32A B type	220V-230V	3
MCB 16A A type	380V-400V	3
MCB 16A B type	380V-400V	3



© 2016 Philips Lighting Holding B.V.

All rights reserved. Reproduction in whole or in part is prohibited without consent of the copyright owner.

The information presented in this document does not form part of any quotation or contract and is believed to be accurate and reliable and may be changed without notice. No liability will be accepted by the publisher for any consequence of its use. Publication thereof does not convey nor imply any license under patent or other industrial or intellectual property rights.

Philips Lighting Holding B.V.  
The Netherlands