

# LED Highbay/LED高天棚灯

## BY2I8P

Mounting instruction/ 安装说明

444170097921

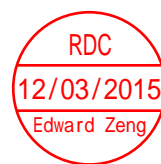

| Type Desc<br>型号描述 | Pmax.(W)<br>灯具功率(W) | Voltage/Frequency<br>电压/频率 | D<br>(mm) | H<br>(mm) | kg  | CCT<br>色温       |
|-------------------|---------------------|----------------------------|-----------|-----------|-----|-----------------|
| BY2I8P LED50 PSU  | 60                  | 220-240V 50/60Hz           | 231       | 124       | 1.6 | CW(冷白光)/NW(正白光) |
| BY2I8P LED90 PSU  | 100                 | 220-240V 50/60Hz           | 277       | 139       | 2.4 | CW(冷白光)/NW(正白光) |
| BY2I8P LED180 PSU | 200                 | 220-240V 50/60Hz           | 369       | 147       | 4.5 | CW(冷白光)/NW(正白光) |

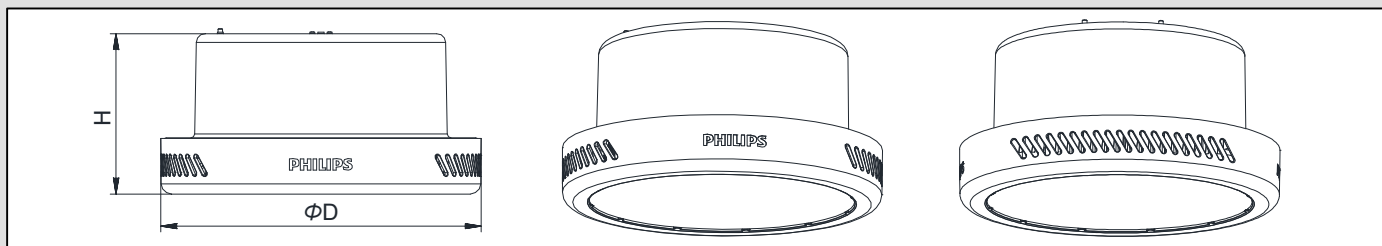

### 1 Hook Mounting 吊装

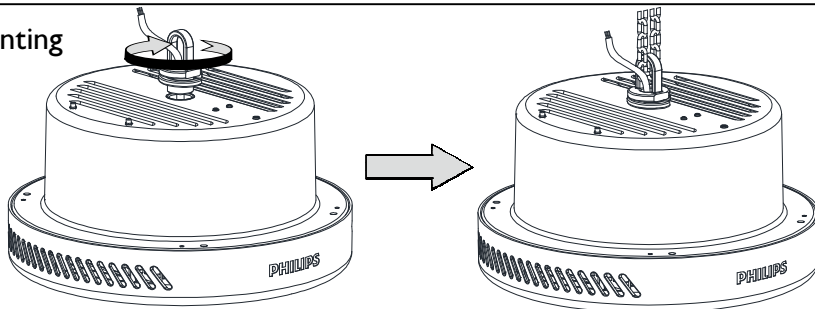

Hook mounting type(Hook&Washer): BY2I8Z Hook/911401561721  
吊装附件型号(吊钩&垫圈): BY2I8Z Hook/911401561721

1.1 Pull the power cable through washer and hook in sequence, then use wrench to fix them to housing.

将电源线依次穿过垫片和吊钩，并用扳手将它们紧固于灯壳上。

1.2 Pull pendant chain (end-user provided) through hook hole and fix it.

将吊链（用户提供）穿过吊钩悬吊孔，并固定。

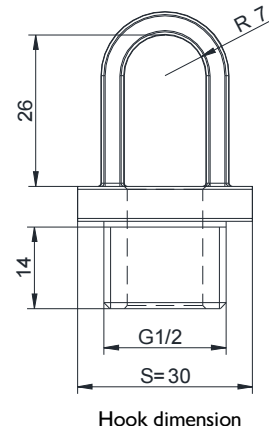

Hook dimension

### 2 Pipe Mounting 杆装

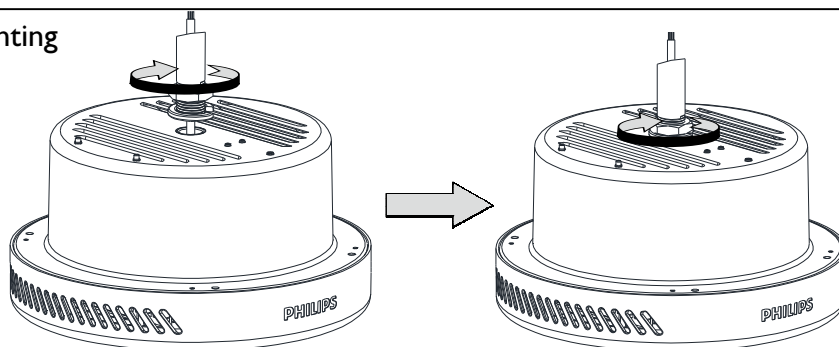

Pipe mounting type (Screw&Washer): BY2I8Z Pendant/911401561821  
杆装附件型号(螺母&垫圈): BY2I8Z Pendant/911401561821

2.1 Pull the power cable through Pipe (end-user provided), washer and screw in sequence, then use wrench to tighten pipe to housing.

将电源线依次穿过吊杆（用户提供），垫片和螺母，并用扳手将吊杆紧固于灯壳上。

2.2 Use screw and spring washer to double tighten pipe to housing.

用螺母和弹性垫圈双重紧固吊杆于灯壳上。

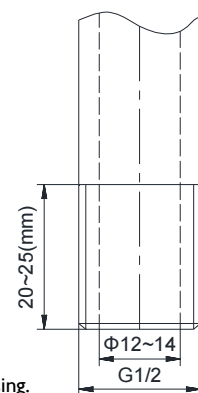

Pipe dimension

### 3 Connect Power Cable 连接电源线

Please use IP20 or above terminal box (dimension can't smaller than 10x20x25), it is not provided by Philips.  
请使用IP20以上的接线盒（接线端子尺寸不小于10x20x25mm），飞利浦不提供接线盒。

#### Luminaire cable/灯具出线:

60227 IEC53 3x0.75mm<sup>2</sup>

L: Brown/棕; N: Blue/蓝; G: Yellow+Green/黄绿;

### 4 Reflector Installation (optional) 反射器安装（可选）

- 4.1 将反射器从底部套入灯具，并确保开槽位置对准灯罩侧边开孔位置。

Insert reflector to luminaire, and please make sure the slots on reflector is aligned with holes on cover.

- 4.2 用螺钉和垫片将反射器固定于灯壳上。

Use screws and washers to fix reflector to housing.

注意：1. 反射器安装必须在灯具固定和电源线连接步骤之前完成。

2. 反射器安装过程中，请注意保护透光罩。

Attention: 1. Reflector installation must be completed before steps of luminaire fixing and power cable connection .

2. Please protect the diffuser during the steps of reflector installation.

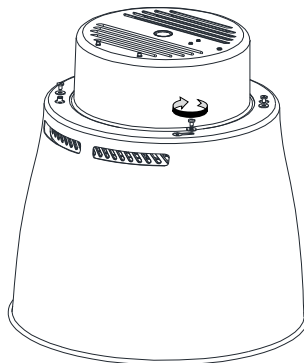

| 产品型号<br>Product Type | 反射器12NC/型号<br>Reflector 12NC/Type |
|----------------------|-----------------------------------|
| BY218P LED180        | 911401561421<br>BY218Z RL-L       |
| BY218P LED90         | 911401561521<br>BY218Z RL-M       |
| BY218P LED50         | 911401561621<br>BY218Z RL-S       |



- 1、The luminaire shall be installed by a qualified electrician and wired in accordance with the latest IEE electrical regulations or the national requirements .  
灯具应由有资格的电工安装，接线要符合IEE电气标准或国家标准。

- 2、Do not switch on before complete installation.

接线过程中，切勿通电。

- 3、The luminaires must be installed vertically to the ground, and must make sure the luminous surface is downward.

灯具必须垂直地面安装，并确保发光面朝下。

- 4、The height between luminous surface and ground must be more than 6m; and the height between bottom of luminaire and mounting surface must be more than 0.5m.

灯具发光面距离地面至少6m, 灯具底部距离安装面至少0.5m。

- 5、The cable of the luminaire should use “Z” type connection. The luminaire should be replaced if the wire and lighting source broken.

灯具电源线使用Z型连接，电源线和光源不可更换，损坏需替换整个灯具。

- 6、For Australia and New Zealand, this product is not suitable for household use.