

## Dimming Chronosense (CH)

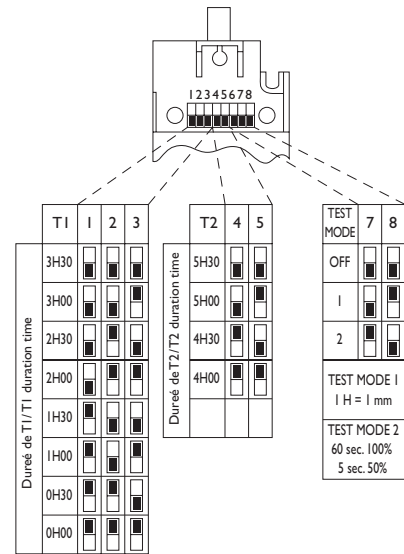

## Power Switch (SW)

Vollanlauf max. load starting      Leistungsreduzierung Power reduction

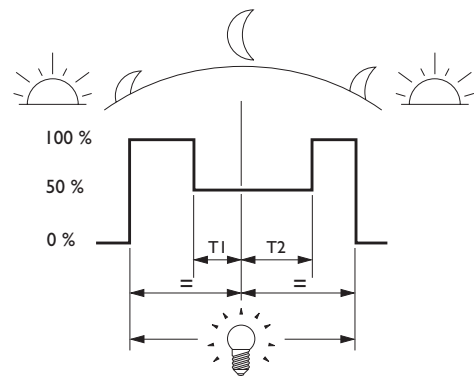
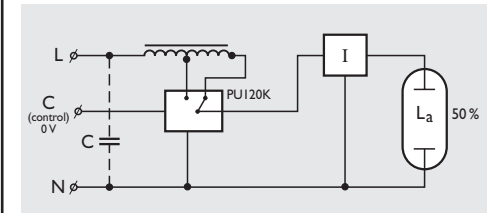

Power Switch PU120K, dimming 50%

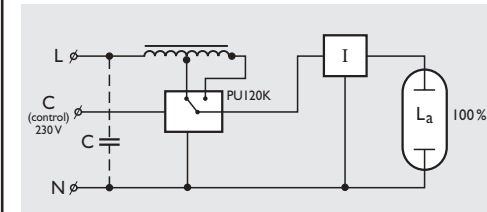

Power Switch PU120K, no dimming

\* integrierte Verzögerungszeit/integrated delay time:  $t \approx 5,5 \text{ min}$

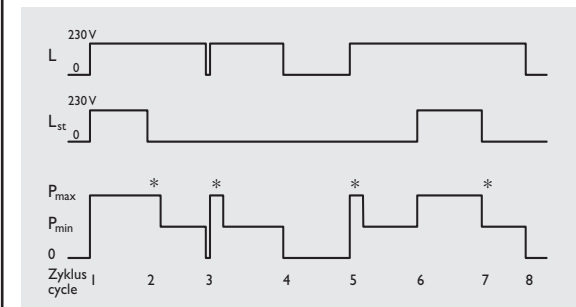

## Service

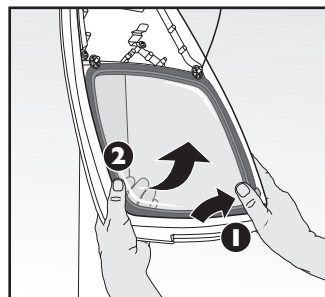

Lampen sind bei der Entsorgung als Sondermüll zu betrachten

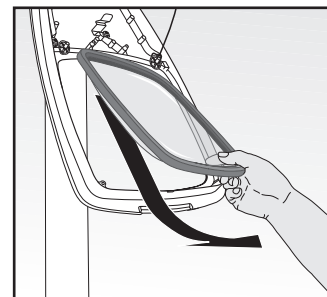

Lamps must be disposed of as Hazardous Waste

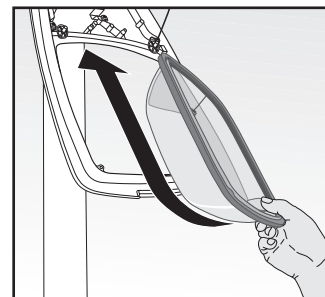

Philips Technologie GmbH  
Supply Center Leuchten  
Rathenaustraße 2-6  
31832 Springe  
Germany  
Telephone +49(0)5041 75 0

060.0905.794.00 10.06  
10/06

Printed in Germany  
Data subject to change

Bestes Betriebsergebnis mit Philips-Lampen.

Use Philips lamps for optimum performance.

### ACHTUNG · ATTENTION



Beim Einsatz von Halogen-Metallampfen darf die Leuchte nur mit ihren vollständigen Schutzabdeckungen betrieben werden!

Use metal halide lamps in luminaires only with complete protection covers (glasses)!

## Koffer<sup>2</sup> SGPI00

### Installation instructions

Instructions de montage  
Montageanleitung  
Montage instruktie  
Istruzioni di montaggio

Instrucciones de montaje  
Instruções de montagem  
Monteringsinstruktioner  
Monteringsvejledning

Kokoonpano- ja kiinnitysohjeet  
Montaj yönergesi  
Οδηγίες συναρμολόγησης  
Instrukcja montazu

Szerelési utasítások  
Návod k montázi  
ИНСТРУКЦИЯ ПО МОНТАЖУ  
Návod k montázi

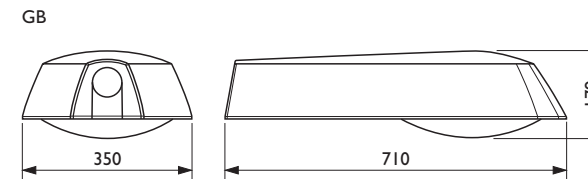
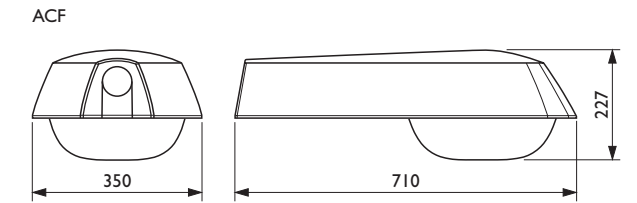
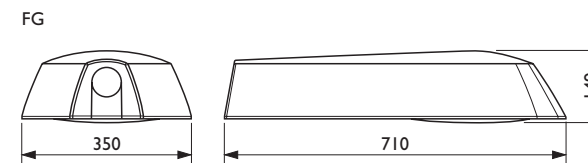
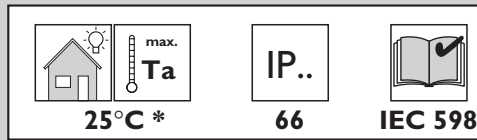

A = 0,06 m<sup>2</sup>

A = 0,11 m<sup>2</sup>

Light Type	W	FG	GB	ACF	PCF	⊕	□	kg max
SON-E/T	70	●	●	●	●	●	●	10,5
	50/70	●	●	●	●	●	●	10,7
	100	●	●	●	●	●	●	10,5
	70/100	●	●	●	●	●	●	10,9
	150	●	●	●	●	●	●	11,2
	100/150	●	●	●	●	●	●	12,0
	250	○	●			●	●	12,5
HPL	50/80	●	●	●	●	●	●	10,3
	80	●	●	●	●	●	●	10,3
	80/125	●	●	●	●	●	●	10,5
	125	●	●	●	●	●	●	10,5
CPO-TW	60	●	●	●	●	●	●	9,5
	90	●	●	●	●	●	●	9,5
	140	●	●	●	●	●	●	9,5
CDO-ET/TT	70	●	●			●	●	10,0
	100	●	●			●	●	10,0
	150	●	●			●	●	10,5
PL-L	2 x 18	●	●	●	●	●	●	10,0
QL	55		●	●	●	●		9,0
	85		●	●	●	●		9,1

○ = Nur SON-T/  
SON-T only

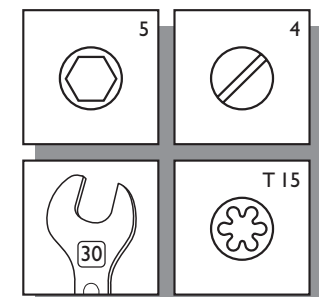
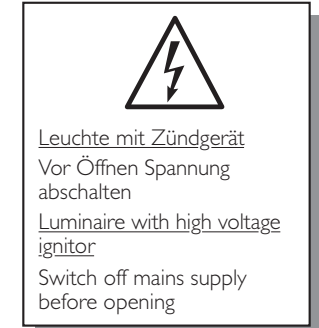

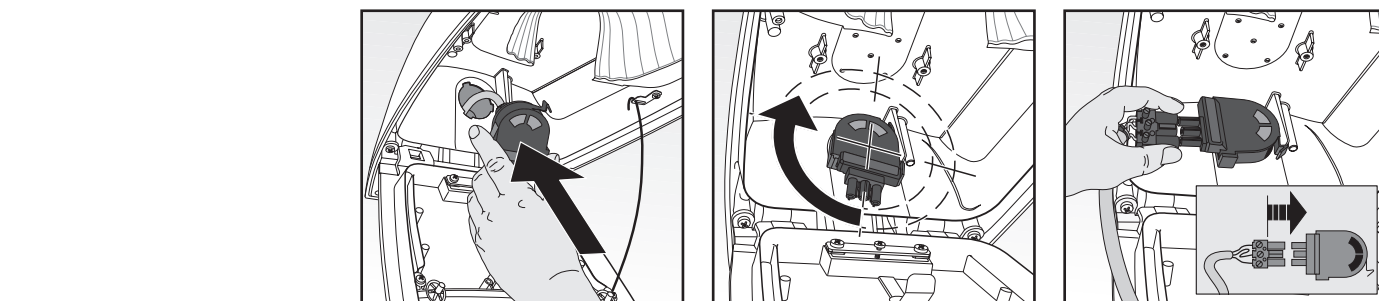
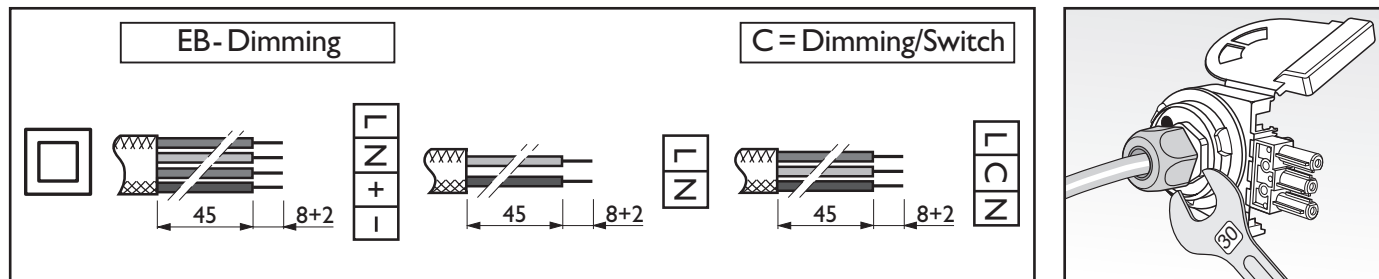
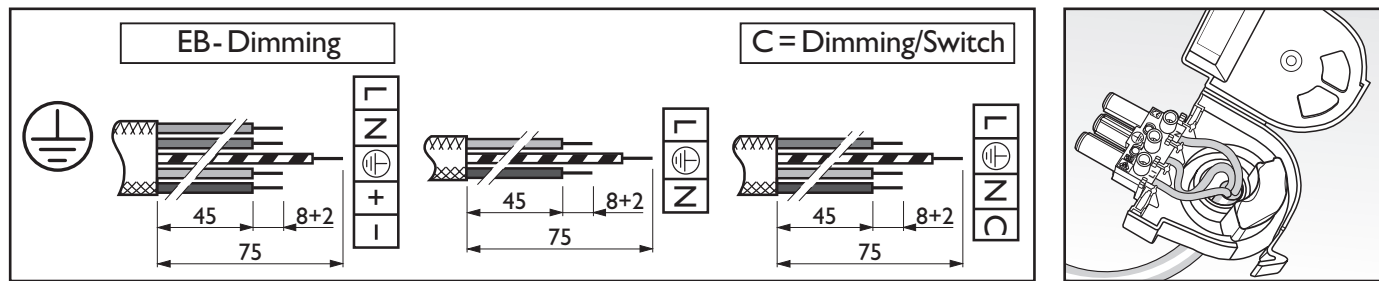
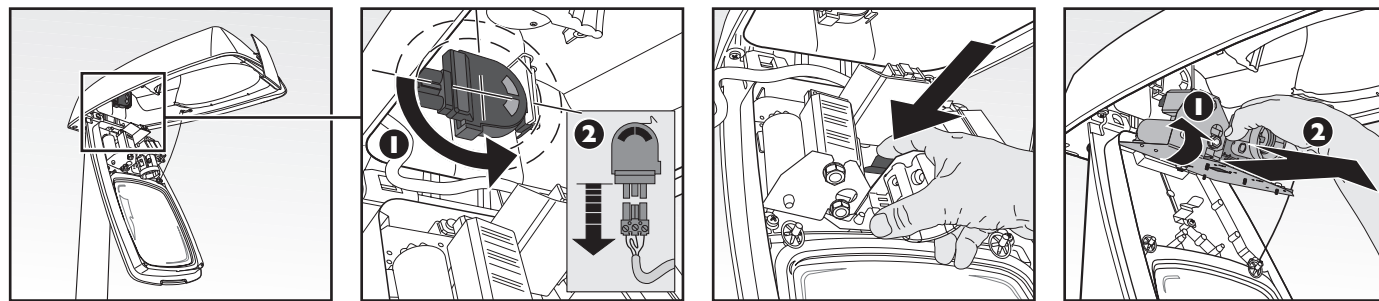
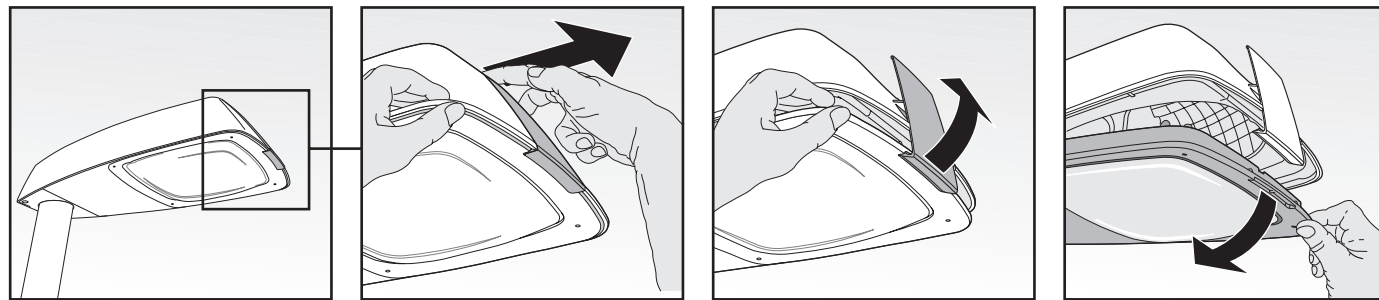
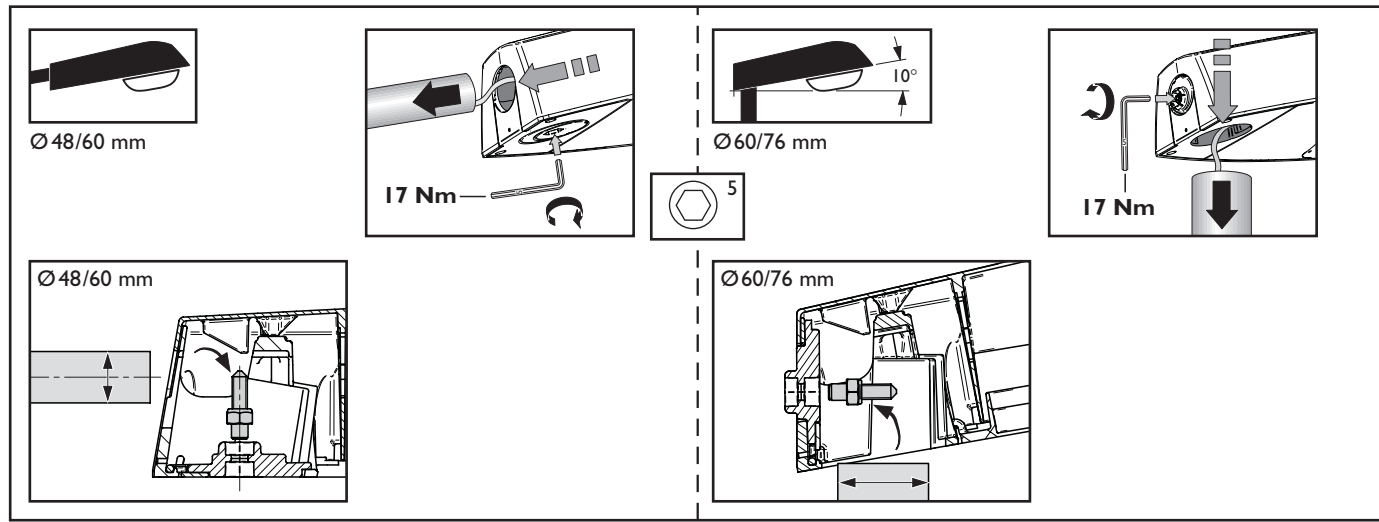

### E 27/E 40

### Cosmopolis

