



HDK472/473/474

HDK472 HPI-P400W-BU HGR 220V-60Hz

MASTER HPI Plus, 400 W, HPL/HPI gear, 220 V, 60 Hz

This modular range of high-bay industrial HDK luminaires is ideal for use in large indoor areas and is designed to work with 250 or 400 W sodium, metal-halide or mercury vapor lamps. Produced with high-quality materials, it offers two reflector options: open (GDK472) or closed (GDK473), and may be accompanied with a glass front (GDK472 PG or GDK473 PG), depending on the reflector. The HDK472/473 model features a tube suspension system (ZDK472 SPR), or track/rail (ZDKEH 473). The HDK474 model is made of cast aluminum, for use without ballast housing.

Product data

General Information	
Lamp family code	HPI-P [MASTER HPI Plus]
Gear	HGR [HPL/HPI gear]

Operating and Electrical	
Input Voltage	220 V
Line Frequency	60 Hz
Power Consumption	400 W

Product Data	
Order product name	HDK472 HPI-P400W-BU HGR 220V-60Hz

Full product name	HDK472 HPI-P400W-BU HGR 220V-60Hz
Full product code	820619226777
Order code	820619226777
Material Nr. (12NC)	820619226777
Numerator - Quantity Per Pack	1
EAN/UPC - Product/Case	7894400001377
Numerator - Packs per outer box	1
EAN/UPC - Case	7894400001377

HDK472/473/474

Dimensional drawing

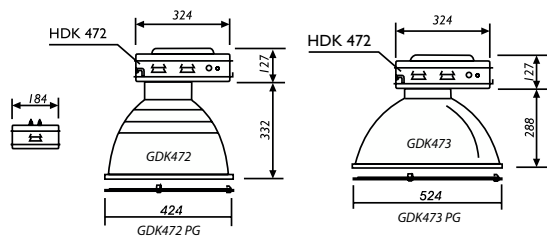

HDK 472 + GDK

