



X-tend TPS498 C

TPS498 C 2xTL-D36W HFP D M6 FTB

2, MASTER TL-D, 36 W, Electronic Primalume, Matt optic double parabolic louver closed, Fused terminal block

X-tend surface and suspended-mounted luminaires The Philips X-tend family of surface and suspended-mounted luminaires has the perfect combination of cutting-edge technology, functional brilliance and aesthetic appeal. The secret behind X-tend's superb lighting qualities lies in its optic - based on specially designed 3-dimensional curves that offer highly efficient light distribution. X-tend meets most ceiling void restrictions, allowing architects and engineers ultimate design flexibility. TPS498 These range of high-performance luminaires is suitable for TL-D or TL5 fluorescent lamps and a wide range of optics. Optics are supplied with the luminaire on request with a choice of direct, direct/indirect lighting. Optics for asymmetrical lighting can be used in combination with a top mirror for higher performance on request. Straight coupling pieces allow connection of luminaires in a line. There are two different top covers: cover-solid and PC-indirect (D/I version). The luminaire is developed with ease of installation in mind, it can be suspended without removing the optic and lamp during installation.

Product data

General Information	
Lamp family code	TL-D [MASTER TL-D]
Gear	EBP [Electronic Primalume]
Light Technical	
Number of light sources	2
Light source color	-
Optic type	Matt optic double parabolic louver closed

Operating and Electrical	
Power Consumption	36 W
Cable	-
Approval and Application	
Ingress protection code	IP20 [Finger-protected]
Product Data	
Order product name	TPS498 C 2xTL-D36W HFP D M6 FTB
Full product name	TPS498 C 2xTL-D36W HFP D M6 FTB

X-tend TPS498 C

Full product code	910403397101
Order code	910403397101
Material Nr. (12NC)	910403397101
Numerator - Quantity Per Pack	1

Numerator - Packs per outer box	1
---------------------------------	---

Dimensional drawing

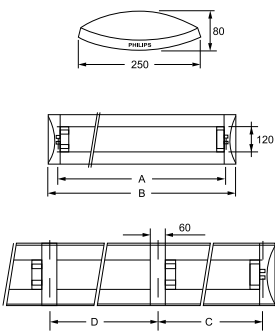

Product	A	B	C	D
TPS498 C 2xTL-D36W HFP D M6 FTB	1,240 mm	1,388 mm	1,260 mm	1,280 mm

