



# CoreLine Wall-mounted

## WL120V LED12S/830 PSU EL3 WH

CoreLine Wall-mounted, LED module, system flux 1200 lm, 830 warm white, Power supply unit (On/Off), Emergency lighting 3 hours duration, White

Whether for a new building or renovation of an existing space, customers want lighting solutions that provide quality of light and substantial energy and maintenance savings. The new CoreLine Wall-mounted range of LED products can be used to replace traditional wall-mounted luminaires incorporating compact fluorescent lamps. The process of selecting, installing and maintaining is so easy – it's a simple switch.

### Product data

General Information	
Lamp family code	LED12S [LED module, system flux 1200 lm]
Light source replaceable	No
Number of gear units	1 unit
Driver included	Yes
Remarks	*-Per Lighting Europe guidance paper “Evaluating performance of LED based luminaires – January 2018”: statistically there is no relevant difference in lumen maintenance between B50 and for example B10. Therefore, the median useful life (B50) value also represents the B10 value.
Product family code	WL120V [CoreLine Wall-mounted]
Lighting Technology	LED

Value ladder	Performance
Embedded control	-
CE mark	Yes
Warranty period	3 years + 2 years upon registration
Flammability mark	For mounting on normally flammable surfaces
ENEC mark	ENEC mark
Glow-wire test	Temperature 850 °C, duration 30 s
EU RoHS compliant	Yes
Light Technical	
Luminous Flux	1,200 lm
Correlated Color Temperature (Nom)	3000 K
Luminous Efficacy (rated) (Nom)	67 lm/W

## CoreLine Wall-mounted

Color rendering index (CRI)	80
Number of light sources	1
Beam angle of light source	120 degree(s)
Light source color	830 warm white
Optic type	Symmetrical
Luminaire light beam spread	180°

### Operating and Electrical

Input Voltage	220 to 240 V
Line Frequency	50 to 60 Hz
Inrush current	22 A
Inrush time	0.32 ms
Power Consumption	18 W
Power Factor (Fraction)	0.95
Connection	Push-in connector and pull relief
Cable	-
Number of products on MCB of 16 A type B	15

### Temperature

Ambient temperature range	0 to +25 °C
---------------------------	-------------

### Controls and Dimming

Dimmable	No
Driver/power unit/transformer	Power supply unit (On/Off)
Constant light output	No

### Mechanical and Housing

Housing Material	Composite materials
Reflector material	-
Optic material	Polycarbonate
Optical cover material	Polycarbonate
Fixation material	Polyamide

Housing Color	White
Optical cover finish	Opal
Overall height	120 mm
Overall diameter	344 mm

### Approval and Application

Ingress protection code	IP65 [Dust penetration-protected, jet-proof]
Mech. impact protection code	IK10 [20 J vandal-resistant]
Protection class IEC	Safety class I

### Initial Performance (IEC Compliant)

Luminous flux tolerance	+/-10%
Initial chromaticity	(0.43, 0.40) SDCM <3
Power consumption tolerance	+/-10%

### Application Conditions

Performance ambient temperature Tq	25 °C
Maximum dim level	Not applicable
Suitable for random switching	No

### Product Data

Order product name	WL120V LED12S/830 PSU EL3 WH
Full product name	WL120V LED12S/830 PSU EL3 WH
Full product code	871869624097700
Order code	24097700
Material Nr. (12NC)	910500454795
Numerator - Quantity Per Pack	1
EAN/UPC - Product/Case	8718696240977
Numerator - Packs per outer box	1
EAN/UPC - Case	8718696240977

## Dimensional drawing

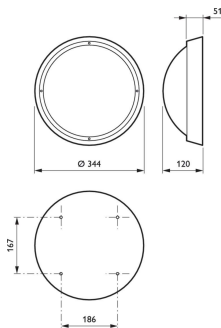

## CoreLine Wall-mounted

