



SmartForm TBS411

TBS411 1x35W/840 HFP C8-VH PIP

SmartForm recessed semi-modular, 1, 35 W, 840 neutral white, HF Performer, High-gloss optic 3D micro-lamellae very high reflectance, Push-in connector and pull relief

Reflecting Philips' drive for simplicity and sustainability, SmartForm recessed is a complete family of highly versatile modular and semi-modular luminaires. These luminaires are available with a choice of LED or MASTER TL5 light sources in very small, slender versions. Designed to fit in a wide range of ceiling types, this complete family can fulfill the majority of project requirements in most applications. As well as incorporating energy-efficient light sources and electronic ballasts, the SmartForm recessed family can be equipped with lighting controls. These include solutions for presence detection and daylight regulation (ActiLume) or daylight regulation only (Luxsense), thereby further reducing energy consumption (W/m² is very low). In this way, this Green Flagship range lowers overall cost of ownership as well as CO₂ levels, making SmartForm an environmentally friendly choice. These slender SmartForm recessed luminaires are designed for integration in variety of linear ceiling systems: exposed and concealed T-bar, plaster and the extended versions for bandraster ceilings. Micro-optics and covers (MLO-PC and Opal) in smallest concept, width 90 mm. Modular length 600, 900, 1200 and 1500 mm. To extend till 2400 mm. Micro-optics and covers in smallest concept with AIR function, width 100 mm. Modular length 600, 900, 1200 and 1500 mm. To extend till 2400 mm. Mini-optics, 2-lamps, width 115 mm. Modular length 600, 900, 1200 and 1500 mm. To extend till 2400 mm.

Product data

| General Information | | | |
|---------------------|--------------------|---------------------|--|
| Lamp family code | TL5 [TL5] | Feed-through wiring | - |
| Gear | HFP [HF Performer] | Product family code | TBS411 [SmartForm recessed semi-modular] |
| | | Embedded control | - |

SmartForm TBS411

| | |
|--------------------------|--|
| CE mark | Yes |
| Glow-wire test | Temperature 850 °C, duration 5 s |
| Light Technical | |
| Number of light sources | 1 |
| Light source color | 840 neutral white |
| Optic type | High-gloss optic 3D micro-lamellae very high reflectance |
| Optical cover type | - |
| Operating and Electrical | |
| Input Voltage | 220 to 240 V |
| Power Consumption | 35 W |
| Connection | Push-in connector and pull relief |
| Cable | - |
| Mechanical and Housing | |
| Housing Color | White |
| Overall length | 1,497 mm |

| | |
|---------------------------------|--------------------------------|
| Approval and Application | |
| Ingress protection code | IP20 [Finger-protected] |
| Mech. impact protection code | IK07 [2 J reinforced] |
| Protection class IEC | Safety class I |
| Application Conditions | |
| Suitable for random switching | Not applicable |
| Product Data | |
| Order product name | TBS411 1x35W/840 HFP C8-VH PIP |
| Full product name | TBS411 1x35W/840 HFP C8-VH PIP |
| Full product code | 871794398659000 |
| Order code | 910501887103 |
| Material Nr. (12NC) | 910501887103 |
| Numerator - Quantity Per Pack | 1 |
| EAN/UPC - Product/Case | 8717943986590 |
| Numerator - Packs per outer box | 1 |
| EAN/UPC - Case | 8717943986590 |

Dimensional drawing

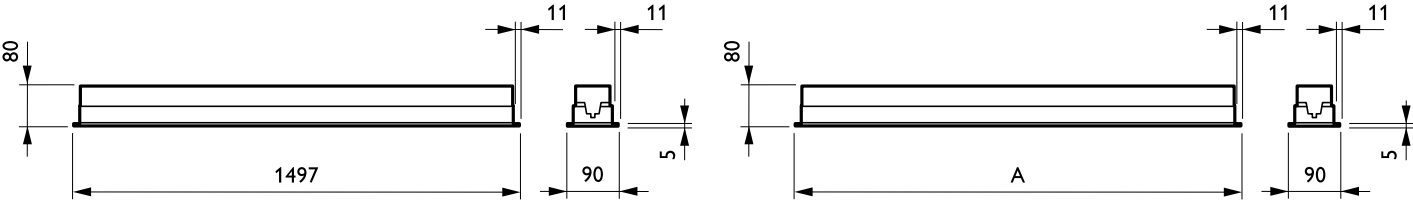

| | |
|--------------------------------|----------|
| Product | A |
| TBS411 1x35W/840 HFP C8-VH PIP | 1,497 mm |

