



ArchiPoint iColor Powercore



ArchiPoint iColor Powercore, Clear Flat Lens with Conduit Mounting Base, M25 (metric size conduit)

ArchiPoint iColor Powercore, Clear Flat Lens with Conduit Mounting Base, M25 (metric size conduit)

ArchiPoint iColor Powercore is a daylight-visible, exterior-rated LED point of light ideally suited for a range of direct-view and beacon applications, as well as for accent applications such as path and marker lighting. These versatile low-profile luminaires display large-scale video, graphics, and intricately designed effects in a host of settings, including architectural, retail, and entertainment installations. ArchiPoint iColor Powercore offers high-intensity output with the efficiency and cost-effectiveness of Powercore technology in a rugged, aluminium housing.

Product data

General information		Operating and electrical	
Lamp family code	LED-HB [LED High Brightness]	Input Voltage	100 to 240 V
Light source color	Red, green and blue	Input Frequency	50 to 60 Hz
Light source replaceable	No	Controls and dimming	
Driver included	Yes	Dimmable	No
Optical cover/lens type	Clear flat	Mechanical and housing	
Protection class IEC	Safety class I	Housing Material	Aluminum die cast
CE mark	CE mark	Optic material	Polycarbonate
UL mark	UL mark	Color	Silver
CCC mark	-		
Accessory PFC	ZCP780		

ArchiPoint iColor Powercore

Approval and application	
Ingress protection code	IP66 [Dust penetration-protected, jet-proof]
Energy Efficiency Class	G
Mech. impact protection code	IK10 [20 J vandal-resistant]
Vibration Standard	Complies with ANSI C136.31, 3G
FCC mark	FCC Class A
Vibration Rating	Complies with ANSI C136.31, 3G
EPREL Registration Number	953157
Initial performance (IEC compliant)	
Initial luminous flux (system flux)	774 lm
Initial LED luminaire efficacy	27.4 lm/W
Initial input power	25 W
Over time performance (IEC compliant)	
Lumen Maintenance 50% at 25°C Reported	100000
Lumen Maintenance 50% at 50°C Reported	70000
Lumen Maintenance 70% at 25°C Reported	70000
Lumen Maintenance 70% at 50°C Reported	40000

Application conditions	
Ambient temperature range	-40 to +50 °C
Product data	
Full product code	871829138150199
Order product name	BCP780 LED-HB/RGB 100-240V CLFT SI CE UL
EAN/UPC - Product	8718291381501
Order code	123-000022-01
Numerator - Quantity Per Pack	1
Numerator - Packs per outer box	4
Material Nr. (12NC)	910503702580
Net Weight (Piece)	1.500 kg
Catalog Number	123-000022-01
Catalog Number Description	ArchiPoint iColor Powercore, Clear Flat Lens with Conduit Mounting Base, M25 (metric size conduit)



Dimensional drawing

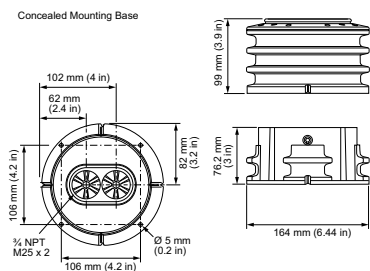

BCP780 LED-HB/RGB 100-240V CLFT SI CE UL

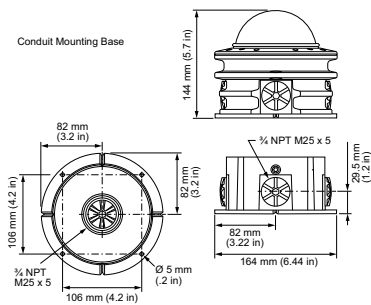

BCP780 LED-HB/RGB 100-240V CLFT SI CE UL

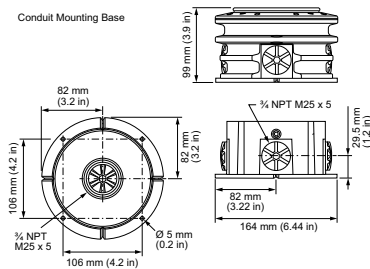

BCP780 LED-HB/RGB 100-240V CLFT SI CE UL

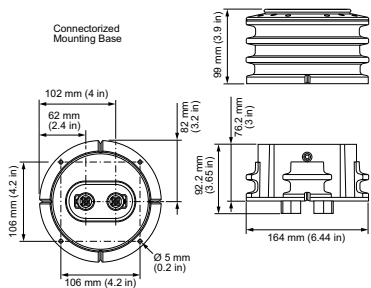

BCP780 LED-HB/RGB 100-240V CLFT SI CE UL

Dimensional drawing

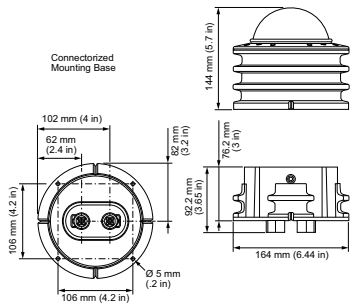

BCP780 LED-HB/RGB 100-240V CLFT SI CE UL

