



ColorGraz MX Powercore

ColorGraz MX Powercore, RGB, 15° x 30° Beam Angle, 305 mm (1 ft)

ColorGraz MX Powercore, RGB, 15° x 30° Beam Angle, 305 mm (1 ft)

Many architectural structures need a linear fixture capable of illuminating multiple storeys with minimal setback. Property owners/end users need a controllable product capable of dynamic illumination to draw attention to their establishments and emphasize their brands. Graze MX Powercore is capable of illuminating over 20 meters at very close setback distances. Powercore technology enables simple installation and long product run lengths.

Product data

General Information		Input frequency	
Lamp family code	LED-HB [LED High Brightness]	50 to 60 Hz	
Light source colour	RGB	Controls and Dimming	
Light source replaceable	No	Dimmable	Yes
Driver included	Yes	Mechanical and Housing	
Luminaire light beam spread	15° x 30°	Housing material	Aluminum extruded
Protection class IEC	Safety class I (I)	Optical cover/lens material	Polycarbonate
CE mark	CE mark	Length	305 mm
UL mark	UL and cUL mark	Colour	Aluminum
Lifetime to 70% luminous flux	100000 h		
Operating and Electrical			
Input Voltage	100 to 277 V		

ColorGraz e MX Powercore

Approval and Application

Ingress protection code	IP66 [Dust penetration-protected, jet-proof]
Mech. impact protection code	IK10 [20 J vandal-resistant]
Vibration standard	Complies with ANSI C136.31, 3G
Vibration rating	Complies with ANSI C136.31, 3G

Initial Performance (IEC Compliant)

Initial input power	20 W
---------------------	------

Over Time Performance (IEC Compliant)

Lumen Maintenance 50% at 25 °C Calculated	100000
Lumen Maintenance 50% at 25 °C Reported	100000
Lumen Maintenance 50% at 50 °C Calculated	80000
Lumen Maintenance 50% at 50 °C Reported	80000
Lumen Maintenance 70% at 25 °C Calculated	100000
Lumen Maintenance 70% at 25 °C Reported	80000
Lumen Maintenance 70% at 50 °C Calculated	91000
Lumen Maintenance 70% at 50 °C Reported	60000

Application Conditions

Ambient temperature range	-20 to +50 °C
---------------------------	---------------

Product Data

Full product code	871829160395599
Order product name	BCS459 15x30 RGB L305
EAN/UPC – product	8718291603955
Order code	123-000079-02
SAP numerator – quantity per pack	1
Numerator – packs per outer box	4
SAP material	910503703332
SAP net weight (piece)	1.200 kg
Commercial Code	123-000079-02
Catalogue number description	ColorGraz e MX Powercore, RGB, 15° x 30° Beam Angle, 305 mm (1 ft)



Dimensional drawing

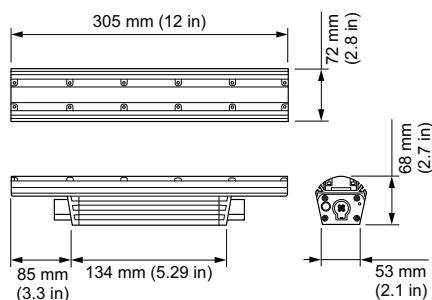

ColorGraz e MX Powercore

