



iW Graze EC Powercore

iW Graze EC Powercore, 90° x 90° Beam Angle, 305 mm (1 ft)

iW Graze EC Powercore, 90° x 90° Beam Angle, 305 mm (1 ft)

Some exterior architectural details require a soft-edged volume fill of light. Graze EC Powercore combines this output with the proven, durable design of the Graze Powercore product family and low power consumption.

Product data

General Information		Controls and Dimming	
Lamp family code	LED-HB [LED High Brightness]	Dimmable	Yes
Light source colour	Cool white and warm white		
Light source replaceable	No		
Driver included	Yes		
Optic type	90 [Beam angle 90°]		
Optical cover/lens type	PCF [Polycarbonate bowl/cover frosted]		
Luminaire light beam spread	90° x 90°		
Protection class IEC	Safety class I		
CE mark	CE mark		
UL mark	UL and cUL mark		
Lifetime to 70% luminous flux	100000 h		
Operating and Electrical		Mechanical and Housing	
Input Voltage	100 to 277 V	Housing material	Extruded aluminium
Input frequency	50 to 60 Hz	Optic material	Polycarbonate
		Optical cover/lens material	Polycarbonate
		Length	305 mm
		Colour	Aluminium
		Approval and Application	
		Ingress protection code	IP66 [Dust penetration-protected, jet-proof]
		Mech. impact protection code	IK08 [5 J vandal-protected]
		Vibration standard	Complies with ANSI C136.31, 3G
		Vibration rating	Complies with ANSI C136.31, 3G

iW Graze EC Powercore

Initial Performance (IEC Compliant)

Initial luminous flux (system flux)	412 lm
Initial LED luminaire efficacy	29.6 lm/W
Init. Colour rendering index	82
Initial input power	10 W

Over Time Performance (IEC Compliant)

Lumen Maintenance 50% at 25 °C	100000
Calculated	
Lumen Maintenance 50% at 25 °C Reported	36000
Lumen Maintenance 50% at 50 °C	80000
Calculated	
Lumen Maintenance 50% at 50 °C Reported	36000
Lumen Maintenance 70% at 25 °C Calculated	100000
Lumen Maintenance 70% at 25 °C Reported	36000
Lumen Maintenance 70% at 50 °C	60000
Calculated	
Lumen Maintenance 70% at 50 °C Reported	36000

Application Conditions

Ambient temperature range	-40 to +50 °C
---------------------------	---------------

Product Data

Full product code	871829160989699
Order product name	BCS438 2700-6500 L305
EAN/UPC – product	8718291609896
Order code	523-000079-40
SAP numerator – quantity per pack	1
Numerator – packs per outer box	4
SAP material	910503703684
SAP net weight (piece)	1.200 kg
Commercial Code	523-000079-40
Catalogue number description	iW Graze EC Powercore, 90° x 90° Beam Angle, 305 mm (1 ft)

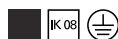

Dimensional drawing

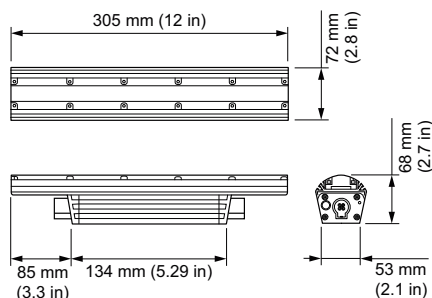

Graze

