



eW Graze MX Powercore

eW Graze MX Powercore, 2700 K, 10° x 60° Beam Angle, 305 mm (1 ft)

eW Graze MX Powercore, 2700 K, 10° x 60° Beam Angle, 305 mm (1 ft)

Many architectural structures need a linear fixture capable of illuminating multiple storeys with minimal setback. Property owners/end users need a controllable product capable of dynamic illumination to draw attention to their establishments and emphasize their brands. Graze MX Powercore is capable of illuminating over 20 meters at very close setback distances. Powercore technology enables simple installation and long product run lengths.

Product data

General information		Input frequency	
Lamp family code	LED-HB [LED High Brightness]	50 to 60 Hz	
Light source colour	Warm white	Controls and dimming	
Light source replaceable	No	Dimmable	
Driver included	Yes	Yes	
Luminaire light beam spread	10° x 60°	Mechanical and housing	
Protection class IEC	Safety class I (I)	Housing material	
CE mark	CE mark	Aluminum extruded	
UL mark	UL and cUL mark	Optical cover/lens material	
Lifetime to 70% luminous flux	60000 h	Polycarbonate	
Operating and electrical		Length	
Input Voltage	100 to 277 V	Approval and application	
		Ingress protection code	
		IP66 [Dust penetration-protected, jet-proof]	

eW Graze MX Powercore

Mech. impact protection code	IK10 [20 J vandal-resistant]
Vibration standard	Complies with ANSI C136.31, 3G
Vibration rating	Complies with ANSI C136.31, 3G
Initial performance (IEC compliant)	
Init. Corr. Colour Temperature	2700 K
Initial input power	15 W
Over time performance (IEC compliant)	
Lumen Maintenance 50% at 25 °C Reported	60000
Lumen Maintenance 50% at 50 °C Reported	60000
Lumen Maintenance 70% at 25 °C Reported	60000
Lumen Maintenance 70% at 50 °C Reported	60000
Application conditions	
Ambient temperature range	-20 to +50 °C

Product data	
Full product code	871829161016899
Order product name	BCS419 10x60/2700 L305
EAN/UPC – product	8718291610168
Order code	523-000080-03
SAP numerator – quantity per pack	1
Numerator – packs per outer box	4
SAP material	910503703690
Net Weight (Piece)	1.200 kg
Commercial Code	523-000080-03
Catalogue number description	eW Graze MX Powercore, 2700 K, 10° x 60° Beam Angle, 305 mm (1 ft)



Dimensional drawing

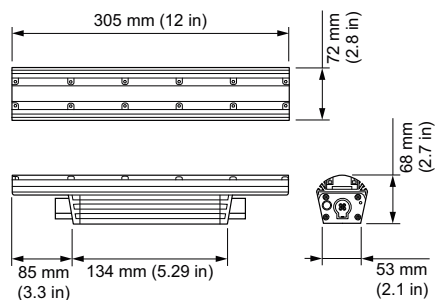

BCS419 10x60/2700 L305

