



# CoreLine Wall-mounted

## WL120V LED12S/830 PSU GR

LED module, system flux 1200 lm, 830 warm white, Power supply unit (On/Off), Grey

CoreLine wall-mounted solutions deliver on the CoreLine promise of innovative, easy-to-install and high quality luminaires. These circular-shaped, surface-mounted luminaires are suitable for both ceiling and wall installations and are easy to apply in circulation areas such as corridors, hallways and staircases. The modern, unobtrusive design, combined with a homogeneous light distribution, ensures this luminaire will blend into the architecture of most buildings. And thanks to the push-in connectors, installation of the CoreLine WL140V is fast and straightforward. This family includes Interact ready luminaires with integrated wireless communications, ready for use with Interact gateways, sensors and software.

### Product data

General Information		Lighting Technology	
Lamp family code	LED12S [LED module, system flux 1200 lm]	Glow-wire test	Temperature 850 °C, duration 30 s
Light source replaceable	No	Flammability mark	For mounting on normally flammable surfaces
Number of gear units	1 unit	CE mark	Yes
Driver included	Yes	ENEC mark	-
Remarks	*-Per Lighting Europe guidance paper "Evaluating performance of LED based luminaires - January 2018": statistically there is no relevant difference in lumen maintenance between B50 and for example B10. Therefore, the median useful life (B50) value also represents the B10 value.	Warranty period	3 years + 2 years upon registration
		EU RoHS compliant	Yes
		Value ladder	Performance
Light Technical			
		Luminous Flux	1,200 lm
		Correlated Color Temperature (Nom)	3000 K

## CoreLine Wall-mounted

Luminous Efficacy (rated) (Nom)	67 lm/W
Color rendering index (CRI)	>80
Number of light sources	1
Beam angle of light source	120 degree(s)
Light source color	830 warm white
Optic type	Symmetrical
Luminaire light beam spread	180°

### Operating and Electrical

Input Voltage	220 to 240 V
Line Frequency	50 to 60 Hz
Inrush current	22 A
Inrush time	0.32 ms
Power Consumption	18 W
Power Factor (Fraction)	0.9
Connection	Push-in connector and pull relief
Cable	-
Number of products on MCB of 16 A type B	15

### Temperature

Ambient temperature range	-20 to +35 °C
---------------------------	---------------

### Controls and Dimming

Dimmable	No
Driver/power unit/transformer	Power supply unit (On/Off)
Constant light output	No

### Mechanical and Housing

Housing Material	Composite materials
Reflector material	-
Optic material	Polycarbonate
Optical cover material	Polycarbonate

Fixation material	Polyamide
Housing Color	Grey
Optical cover finish	Opal
Overall height	120 mm
Overall diameter	344 mm

### Approval and Application

Ingress protection code	IP65 [Dust penetration-protected, jet-proof]
Mech. impact protection code	IK10 [20 J vandal-resistant]
Protection class IEC	Safety class I

### Initial Performance (IEC Compliant)

Luminous flux tolerance	+/-10%
Initial chromaticity	(0.47, 0.42) SDCM<3
Power consumption tolerance	+/-10%

### Application Conditions

Performance ambient temperature Tq	25 °C
Suitable for random switching	No

### Product Data

Order product name	WL120V LED12S/830 PSU GR
Full product name	WL120V LED12S/830 PSU GR
Full product code	871869606642399
Order code	910503910019
Material Nr. (12NC)	910503910019
Numerator - Quantity Per Pack	1
EAN/UPC - Product/Case	8718696066423
Numerator - Packs per outer box	6
EAN/UPC - Case	8718696066546

## Dimensional drawing

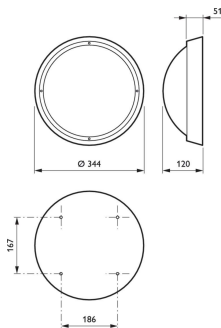

## CoreLine Wall-mounted

