



CoreLine Projector

ST120T LED24S-24-/840 PSU BK

LED module, system flux 2400 lm, 24 degree(s), 840 neutral white, Power supply unit (On/Off), Black

The CoreLine Projector range of luminaires is designed to replace halogen and CDM-standard-based projectors. Their clean lines and attractive TCO help customers to make the switch to LED. These luminaires create a natural lighting effect for use in accent lighting applications. They also deliver instant energy savings and have a much longer lifetime, creating a real value-for-money and environmentally friendly solution. They are easy to install on a standard track or by means of a surface-mount connector.

Product data

General Information			
Lamp family code	LED24S [LED module, system flux 2400 lm]	Flammability mark	-
Light source replaceable	No	ENEC mark	-
Number of gear units	1 unit	Glow-wire test	Temperature 650 °C, duration 5 s
Driver included	Yes	EU RoHS compliant	Yes
Remarks	*-Per Lighting Europe guidance paper "Evaluating performance of LED based luminaires - January 2018": statistically there is no relevant difference in lumen maintenance between B50 and for example B10. Therefore, the median useful life (B50) value also represents the B10 value.	Light Technical	
Lighting Technology	LED	Luminous Flux	2,400 lm
Value ladder	Value	Correlated Color Temperature (Nom)	4000 K
CE mark	Yes	Luminous Efficacy (rated) (Nom)	73 lm/W
Warranty period	3 years + 2 years upon registration	Color rendering index (CRI)	80
		Number of light sources	1
		Beam angle of light source	24 degree(s)
		Light source color	840 neutral white
		Optic type	Beam angle 24°
		Luminaire light beam spread	24°

CoreLine Projector

Operating and Electrical	
Input Voltage	220 to 240 V
Line Frequency	50 to 60 Hz
Inrush current	5.6 A
Inrush time	40 ms
Power Consumption	33 W
Power Factor (Fraction)	0.9
Connection	Feed-through connector 3-pole
Cable	-
Number of products on MCB of 16 A type 40 B	
Temperature	
Ambient temperature range	0 to +35 °C
Controls and Dimming	
Dimmable	No
Driver/power unit/transformer	Power supply unit (On/Off)
Constant light output	No
Mechanical and Housing	
Housing Material	Aluminum
Reflector material	-
Optic material	Polymethyl methacrylate
Optical cover material	Polymethyl methacrylate
Fixation material	-
Housing Color	Black
Optical cover finish	Textured
Overall length	107 mm
Overall width	102 mm

Dimensional drawing

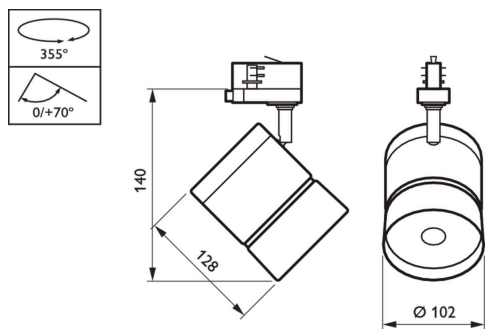

Overall height	160 mm
Overall diameter	102 mm
Dimensions (Height x Width x Depth)	160 x 102 x 107 mm
Approval and Application	
Ingress protection code	IP20 [Finger-protected]
Mech. impact protection code	IK02 [0.2 J standard]
Protection class IEC	Safety class I
Initial Performance (IEC Compliant)	
Luminous flux tolerance	+/-10%
Initial chromaticity	(0.38, 0.38) SDCM<3
Power consumption tolerance	+/-10%
Application Conditions	
Performance ambient temperature Tq	25 °C
Suitable for random switching	No
Product Data	
Order product name	ST120T LED24S-24-/840 PSU BK
Full product name	ST120T LED24S-24-/840 PSU BK
Full product code	871869606947999
Order code	06947999
Material Nr. (12NC)	910503910093
Numerator - Quantity Per Pack	1
EAN/UPC - Product/Case	8718696069479
Numerator - Packs per outer box	12
EAN/UPC - Case	8718696069554

