



SmartBalance Free Floor Standing

FS484F LED125S/840 PSD-T ACL WH

SmartBalance FFS - LED module, system flux 12500 lm - 840 neutral white - Power supply unit with DALI touch-switch & dimming interface - Micro-lens optic - ActiLume - White

Free floor-standing luminaires are loved by customers as the ideal solution for personally controlled, flexible and comfortable lighting. SmartBalance is the next step in free floor-standing luminaires. Thanks to the application of state-of-the-art LED technology, it offers not only increased energy efficiency, but also a compact and clean design that blends into any environment. SmartBalance is also available in recessed, surface-mounted and suspended versions.

Product data

General information			
Number of light sources	1 [1 pc]	Luminaire light beam spread	114°
Lamp family code	LED125S [LED module, system flux 12500 lm]	Embedded control	ACL [ActiLume]
Light source colour	840 neutral white	Control interface	DALI
Cap base	- [-]	Separate switching	-
Light source replaceable	No	Connection	Connection unit 3-pole
Number of gear units	2 units	Cable	Cable 3.0 m with Europlug connector 3-pole
Gear	-	Protection class IEC	Safety class I
Driver/power unit/transformer	PSD-T [Power supply unit with DALI touch-switch & dimming interface]	Glow-wire test	Temperature 650 °C, duration 30 s
Driver included	Yes	Flammability mark	F [For mounting on normally flammable surfaces]
Optic type	No [-]	CE mark	CE mark
Optical cover/lens type	MLO [Micro-lens optic]	ENEC mark	ENEC plus mark
		Warranty period	5 years

SmartBalance Free Floor Standing

Remarks	*-Per Lighting Europe guidance paper "Evaluating performance of LED based luminaires - January 2018": statistically there is no relevant difference in lumen maintenance between B50 and for example B10. Therefore the median useful life (B50) value also represents the B10 value.
Constant light output	No
Number of products on MCB	10
RoHS mark	RoHS mark
Accessory PFC	N/A
Product Family Code	FS484F [SmartBalance FFS]
Unified glare rating CEN	13

Operating and Electrical

Input voltage	220-240 V
Input frequency	50 to 60 Hz
Control signal voltage	0-16 V DC DALI
Inrush current	50 A
Inrush time	2 ms
Power factor (min.)	0.9

Controls and Dimming

Dimmable	Yes
----------	-----

Mechanical and Housing

Housing material	Aluminium
Reflector material	Aluminium
Optic material	-
Gear tray material	Steel
Fixation material	-
Optical cover/lens finish	Opal
Overall length	700 mm
Overall width	250 mm
Overall height	2000 mm
Colour	White

Approval and Application

Ingress protection code	IP40 [Wire-protected]
Mech. impact protection code	IK02 [0.2 J standard]

Initial Performance (IEC Compliant)

Initial luminous flux	12500 lm
Luminous flux tolerance	+/-10%
Initial LED luminaire efficacy	137 lm/W
Init. Corr. colour temperature	4000 K
Init. colour rendering index	≥80
Initial chromaticity	(0.43, 0.40) SDCM <3
Initial input power	91 W
Power consumption tolerance	+/-10%

Over Time Performance (IEC Compliant)

Control gear failure rate at median useful life 50000 h	5 %
Lumen maintenance at median useful life* 50000 h	L85

Application Conditions

Ambient temperature range	+10 to +40 °C
Performance ambient temperature Tq	25 °C
Maximum dimming level	1%

Product Data

Full product code	871794310539700
Order product name	FS484F LED125S/840 PSD-T ACL WH
EAN/UPC – product	8717943105397
Order code	10539700
Numerator – quantity per pack	1
Numerator – packs per outer box	1
Material no. (12NC)	910504094503
Net weight (piece)	16.900 kg

Dimensional drawing

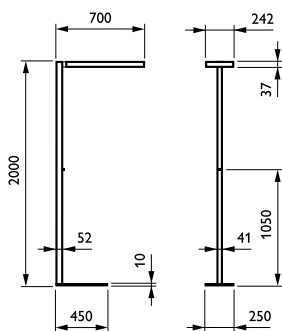

SmartBalance FS484F

SmartBalance Free Floor Standing

Photometric data

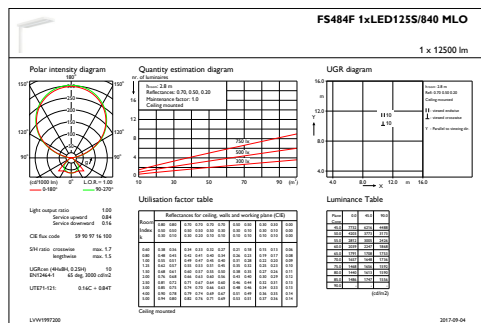

IFGU1_FS484F1xLED125S840MLO

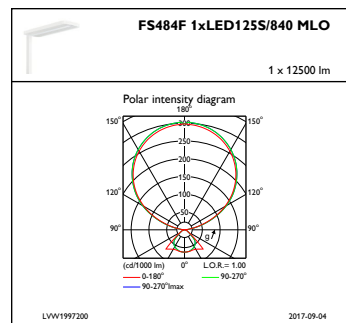

IFPC1_FS484F1xLED125S840MLO

