



# Maxos TL-D, trapeze reflectors and optics

4MX092 2 36 T IP64 WH

MAXOS R T8, 2, 36 W

The sturdy trapeze reflectors for TL-D are designed primarily for applications in industry, supermarkets and shops. They are made of steel with a white or silver finish. The reflectors are optimized for electrical units holding 1 or 2 TL-D lamps and provide an excellent light output ratio. There are basic trapeze reflectors without an additional mirror inlay and trapeze reflectors with dedicated aluminum mirror inlays. These are designed for wide-beam, narrow-beam and asymmetrical wall-washing light distributions. Moreover, perforated and slotted trapeze reflectors (without mirror inlays) can be ordered for design reasons or to create an indirect uplighting effect. For glare reduction, the trapeze reflector can be equipped with a steel louver (L-T) that has a white or silver finish. If emergency lighting by means of separately connected orientation light units (E27-sockets) is required, special trapeze reflectors with a bigger cut-off must be used. The length of this reflector corresponds to that of the 58 W trunking length. A 36 W electrical unit plus the orientation light unit will fill this length. The reflectors are fixed to the electrical units via a simple click-in. The reflectors can be connected to each other in a line by means of an integrated connection at one end of the reflector. End plates for the beginning and end of the light line are available as accessories.

## Product data

| General Information |                     | Light Technical         |   |
|---------------------|---------------------|-------------------------|---|
| Accessory color     | White               | Number of light sources | 2 |
| Product family code | 4MX092 [MAXOS R T8] |                         |   |

# Maxos TL-D, trapeze reflectors and optics

|                          |                         |
|--------------------------|-------------------------|
| Operating and Electrical |                         |
| Power Consumption        | 36 W                    |
| Approval and Application |                         |
| Ingress protection code  | IP20 [Finger-protected] |
| Product Data             |                         |
| Order product name       | 4MX092 2 36 T IP64 WH   |
| Full product name        | 4MX092 2 36 T IP64 WH   |

|                                 |                 |
|---------------------------------|-----------------|
| Full product code               | 403073254088499 |
| Order code                      | 910690062026    |
| Material Nr. (12NC)             | 910690062026    |
| Numerator - Quantity Per Pack   | 1               |
| EAN/UPC - Product/Case          | 4030732540884   |
| Numerator - Packs per outer box | 6               |
| EAN/UPC - Case                  | 4030732110438   |

## Dimensional drawing

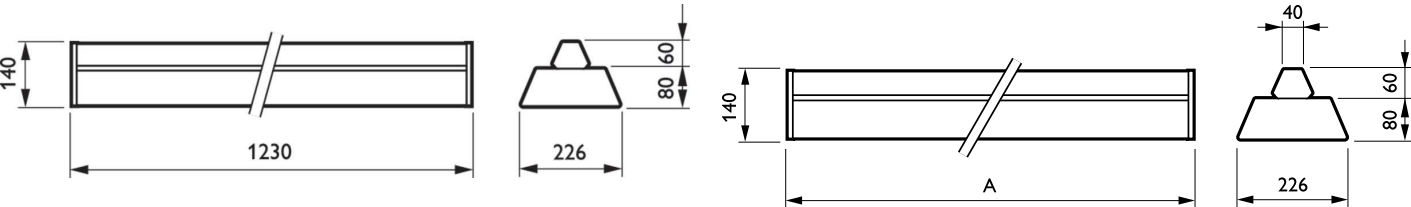

|                       |
|-----------------------|
| Product               |
| 4MX092 2 36 T IP64 WH |

