



Maxos TL-D, facet reflectors and optics

4MX092 1/2 58 F-WB WH

MAXOS R T8, 58 W

The design-orientated facettted reflectors for TL-D are ideal for applications focusing on trade (such as supermarkets and shops) and for offices. They are made of steel, with a white or silver finish, and are available for electrical units holding 1 or 2 TL-D lamps. The 2-lamp versions of the facettted reflectors must be used with special electrical units (lamp holder F32 mm). A facettted reflector comes without a pre-mounted mirror inlay and can be integrated with a semi-high-gloss (D6) OLC optic of high-quality aluminum. This optic has parabolic side reflectors and parabolic lamellae, and it can create either a medium beam (with an integrated white top reflector) or a narrow beam (with an integrated mirror top reflector). A prismatic acrylic screen to cover the facettted reflector is also available. For basic glare reduction, the facettted reflector can be equipped with a white-coated steel louver. The reflector is fixed on the electrical units via a simple click-in. The facettted reflectors must be connected to each other with additional coupling pieces. End plates for the beginning and end of the light line are available as accessories.

Product data

General Information	
Accessory color	White
Product family code	4MX092 [MAXOS R T8]
Operating and Electrical	
Power Consumption	58 W

Approval and Application	
Ingress protection code	IP20 [Finger-protected]
Product Data	
Full product code	403073259964699
Order product name	4MX092 1/2 58 F-WB WH
Order code	910690144126
Numerator - Quantity Per Pack	1

Maxos TL-D, facet reflectors and optics

Numerator - Packs per outer box	6
Material Nr. (12NC)	910690144126
Full product name	4MX092 1/2 58 F-WB WH
EAN/UPC - Case	4030732202089

EAN/UPC - Product/Case	4030732599646
------------------------	---------------

Dimensional drawing

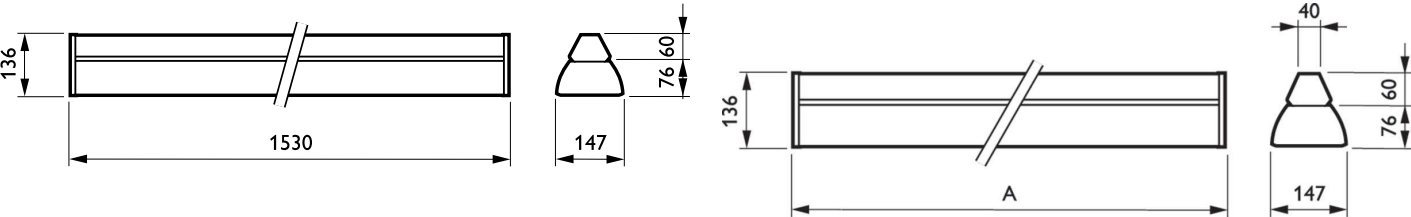

Product
4MX092 1/2 58 F-WB WH

