



Maxos TL5, facet reflectors and optics

4MX692 1/2 54 F WH

MAXOS R T5, 54 W

Facetted reflectors for TL5 give shops and offices a high-class appearance. They are made of steel, with a white or silver finish, and are available for electrical units holding 1 or 2 TL5 lamps. The facetted reflector can be integrated with a semi-high-gloss (D6) OLC optic of high-quality aluminum and has parabolic side reflectors and parabolic lamellae. There are two versions: medium beam with an integrated white top reflector and narrow beam with an integrated mirror top reflector. Moreover, a prismatic acrylic cover (P) and a white steel louver (L-F) are available. The reflectors do not require the use of tools and are firmly fixed to the electrical units via a simple click-in and must be connected to each other in a light line with additional coupling pieces. End plates for the beginning and end of the light line are available as accessories.

Product data

General Information		Approval and Application	
Accessory color	White	Ingress protection code	IP20 [Finger-protected]
Product family code	4MX692 [MAXOS R T5]		
Operating and Electrical		Product Data	
Power Consumption	54 W	Order product name	4MX692 1/2 54 F WH
		Full product name	4MX692 1/2 54 F WH
		Full product code	403073258417899
		Order code	58417899
		Material Nr. (12NC)	910691142026
		Numerator - Quantity Per Pack	1
		EAN/UPC - Product/Case	4030732584178
Mechanical and Housing			
Overall length	1,179 mm		

Maxos TL5, facet reflectors and optics

Numerator - Packs per outer box	6
EAN/UPC - Case	4030732198924

Dimensional drawing

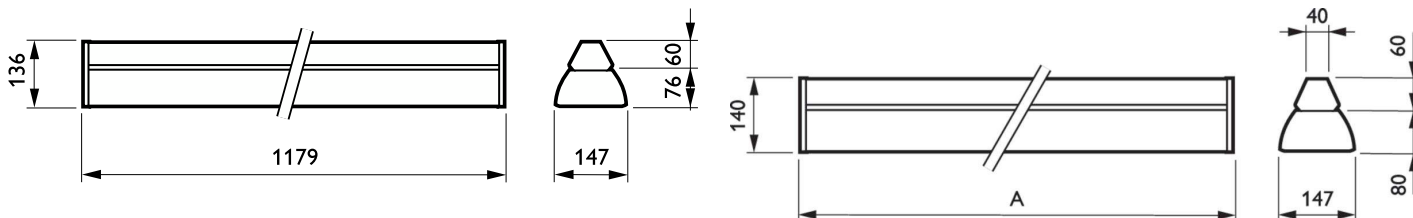

Product

4MX692 1/2 54 F WH

