



Luma Micro

BGP615 GRN13/NW PSU I OFR1 GR 62

LUMA MICRO, 12, LED GreenLine 1300 lm, Power supply unit (On/Off), Optiflux version R1, Spigot for diameter 62 mm

Luma is a REVOLED™ road-lighting luminaire with a clear design identity, offering a perfectly cooled, fit-and-forget solution for all streets and roads. The lumen package, lifetime and energy profile can be tuned to create the desired solution in terms of energy and cost savings. Luma can be programmed to keep the flux of the LEDs at a predefined constant level over the lifetime of the luminaire – by increasing the operating current over time to compensate for the LED lumen depreciation. This eliminates over-lighting at the beginning, enabling additional extra energy savings. Luma’s truly flat design prevents upward light, and the OPTIFLUX™ lens optics meet current lighting standards. To optimize the light distribution for varying road geometries and/or glare restrictions, the tilt angle can easily be adjusted on installation.

Product data

| General Information | |
|--------------------------|--|
| Lamp family code | GRN13 [LED GreenLine 1300 lm] |
| Light source replaceable | Yes |
| Number of gear units | 1 unit |
| Driver included | Yes |
| Remarks | * At extreme ambient temperatures the luminaire might automatically dim down to protect components |
| Light source engine type | LED |
| Product family code | BGP615 [LUMA MICRO] |
| Lighting Technology | LED |
| Embedded control | - |

| CE mark | Yes |
|--------------------------------|----------------------------------|
| Warranty period | 5 years |
| Flammability mark | - |
| ENEC mark | ENEC mark |
| Glow-wire test | Temperature 850 °C, duration 5 s |
| EU RoHS compliant | No |
| Light Technical | |
| Upward light output ratio | 0 |
| Luminous Flux | 1,144 lm |
| Standard tilt angle posttop | 0° |
| Standard tilt angle side entry | 0° |

Luma Micro

| | |
|------------------------------------|---------------------|
| Correlated Color Temperature (Nom) | 4000 K |
| Luminous Efficacy (rated) (Nom) | 95.3 lm/W |
| Color rendering index (CRI) | 70 |
| Number of light sources | 12 |
| Light source color | Neutral white |
| Optical cover type | Flat glass |
| Luminaire light beam spread | 154° |
| Optic type outdoor | Optiflux version R1 |

Operating and Electrical

| | |
|---|-------------------------------|
| Input Voltage | 220 to 240 V |
| Line Frequency | 50 to 60 Hz |
| Inrush current | 22 A |
| Inrush time | 0.29 ms |
| Power Consumption | 10 W |
| Power Factor (Fraction) | 0.9 |
| Connection | Screw connection block 3-pole |
| Cable | - |
| Number of products on MCB of 16 A type B 20 | |

Temperature

| | |
|---------------------------|---------------|
| Ambient temperature range | -40 to +50 °C |
|---------------------------|---------------|

Controls and Dimming

| | |
|-------------------------------|----------------------------|
| Dimmable | No |
| Driver/power unit/transformer | Power supply unit (On/Off) |
| Constant light output | No |

Mechanical and Housing

| | |
|------------------------|---------------------------|
| Housing Material | Aluminum |
| Reflector material | Polycarbonate |
| Optic material | Polycarbonate |
| Optical cover material | Tempered glass |
| Fixation material | Aluminum |
| Housing Color | Grey |
| Mounting device | Spigot for diameter 62 mm |

| | |
|-------------------------------------|--------------------|
| Optical cover shape | Flat |
| Optical cover finish | Clear |
| Overall length | 622 mm |
| Overall width | 290 mm |
| Overall height | 130 mm |
| Effective projected area | 0.049 m² |
| Dimensions (Height x Width x Depth) | 130 x 290 x 622 mm |

Approval and Application

| | |
|--|--|
| Ingress protection code | IP66 [Dust penetration-protected, jet-proof] |
| Mech. impact protection code | IK09 [10 J] |
| Surge Protection (Common/Differential) | Philips standard surge protection level |
| Protection class IEC | Safety class I |

Initial Performance (IEC Compliant)

| | |
|---------------------------------------|------------------------|
| Luminous flux tolerance | +/-7% |
| Initial chromaticity | (0.381, 0.379) SDCM <5 |
| Power consumption tolerance | +/-10% |
| Init. Color Rendering Index Tolerance | +/-2 |

Over Time Performance (IEC Compliant)

| | |
|-------------------------------|-------|
| Driver failure rate at 5000 h | 0.5 % |
|-------------------------------|-------|

Product Data

| | |
|---------------------------------|----------------------------------|
| Order product name | BGP615 GRN13/NW PSU I OFR1 GR 62 |
| Full product name | BGP615 GRN13/NW PSU I OFR1 GR 62 |
| Full product code | 871869634005900 |
| Order code | 34005900 |
| Material Nr. (12NC) | 910925439722 |
| Numerator - Quantity Per Pack | 1 |
| EAN/UPC - Product/Case | 8718696340059 |
| Numerator - Packs per outer box | 1 |
| EAN/UPC - Case | 8718696340059 |

Dimensional drawing

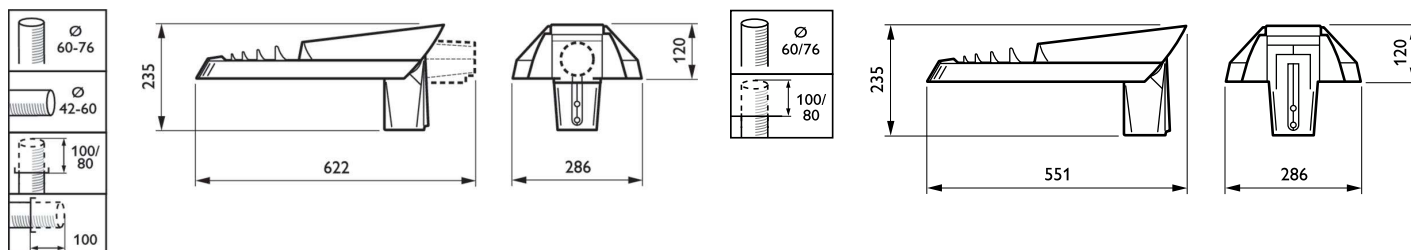

Luma Micro

Dimensional drawing

