



Luma Micro

BGP615 GRN29/NW PSU I OFR1 GR 62

LUMA MICRO, 20, LED GreenLine 2900 lm, Power supply unit (On/Off), Optiflux version R1, Spigot for diameter 62 mm

Luma is a REVOLED™ road-lighting luminaire with a clear design identity, offering a perfectly cooled, fit-and-forget solution for all streets and roads. The lumen package, lifetime and energy profile can be tuned to create the desired solution in terms of energy and cost savings. Luma can be programmed to keep the flux of the LEDs at a predefined constant level over the lifetime of the luminaire – by increasing the operating current over time to compensate for the LED lumen depreciation. This eliminates over-lighting at the beginning, enabling additional extra energy savings. Luma's truly flat design prevents upward light, and the OPTIFLUX™ lens optics meet current lighting standards. To optimize the light distribution for varying road geometries and/or glare restrictions, the tilt angle can easily be adjusted on installation.

Product data

General Information	
Lamp family code	GRN29 [LED GreenLine 2900 lm]
Light source replaceable	Yes
Number of gear units	1 unit
Driver included	Yes
Remarks	* At extreme ambient temperatures the luminaire might automatically dim down to protect components
Light source engine type	LED
Product family code	BGP615 [LUMA MICRO]
Lighting Technology	LED
Embedded control	-

CE mark	Yes
Warranty period	5 years
Flammability mark	-
ENEC mark	ENEC mark
Glow-wire test	Temperature 850 °C, duration 5 s
EU RoHS compliant	No
Light Technical	
Upward light output ratio	0
Luminous Flux	2,552 lm
Standard tilt angle posttop	0°
Standard tilt angle side entry	0°

Luma Micro

Correlated Color Temperature (Nom)	4000 K
Luminous Efficacy (rated) (Nom)	106.3 lm/W
Color rendering index (CRI)	70
Number of light sources	20
Light source color	Neutral white
Optical cover type	Flat glass
Luminaire light beam spread	154°
Optic type outdoor	Optiflux version R1

Operating and Electrical

Input Voltage	220 to 240 V
Line Frequency	50 to 60 Hz
Inrush current	22 A
Inrush time	0.29 ms
Power Consumption	21 W
Power Factor (Fraction)	0.96
Connection	Screw connection block 3-pole
Cable	-
Number of products on MCB of 16 A type B 20	

Temperature

Ambient temperature range	-40 to +50 °C
---------------------------	---------------

Controls and Dimming

Dimmable	No
Driver/power unit/transformer	Power supply unit (On/Off)
Constant light output	No

Mechanical and Housing

Housing Material	Aluminum
Reflector material	Polycarbonate
Optic material	Polycarbonate
Optical cover material	Glass
Fixation material	Aluminum
Housing Color	Grey
Mounting device	Spigot for diameter 62 mm

Optical cover shape	Flat
Optical cover finish	Clear
Overall length	622 mm
Overall width	290 mm
Overall height	130 mm
Effective projected area	0.049 m²
Dimensions (Height x Width x Depth)	130 x 290 x 622 mm

Approval and Application

Ingress protection code	IP66 [Dust penetration-protected, jet-proof]
Mech. impact protection code	IK09 [10 J]
Surge Protection (Common/Differential)	Philips standard surge protection level
Protection class IEC	Safety class I

Initial Performance (IEC Compliant)

Luminous flux tolerance	+/-7%
Initial chromaticity	(0.381, 0.379) SDCM <5
Power consumption tolerance	+/-10%
Init. Color Rendering Index Tolerance	+/-2

Over Time Performance (IEC Compliant)

Driver failure rate at 5000 h	0.5 %
-------------------------------	-------

Product Data

Order product name	BGP615 GRN29/NW PSU I OFR1 GR 62
Full product name	BGP615 GRN29/NW PSU I OFR1 GR 62
Full product code	871869634010300
Order code	34010300
Material Nr. (12NC)	910925439727
Numerator - Quantity Per Pack	1
EAN/UPC - Product/Case	8718696340103
Numerator - Packs per outer box	1
EAN/UPC - Case	8718696340103

Dimensional drawing

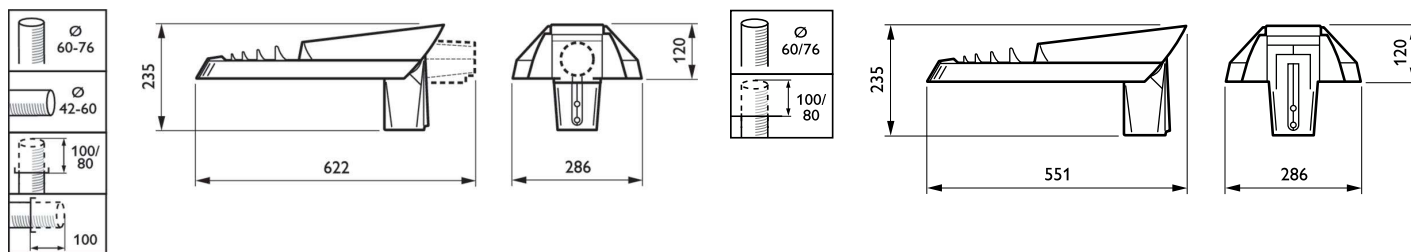

Luma Micro

Dimensional drawing

