



Luma Micro

BGP615 ECO39/NW PSU II OFR1 GR 62

LUMA MICRO, 20, LED EconomyLine 3900 lm, Power supply unit (On/Off), Optiflux version R1, Spigot for diameter 62 mm

Luma is a REVOLED™ road-lighting luminaire with a clear design identity, offering a perfectly cooled, fit-and-forget solution for all streets and roads. The lumen package, lifetime and energy profile can be tuned to create the desired solution in terms of energy and cost savings. Luma can be programmed to keep the flux of the LEDs at a predefined constant level over the lifetime of the luminaire – by increasing the operating current over time to compensate for the LED lumen depreciation. This eliminates over-lighting at the beginning, enabling additional extra energy savings. Luma's truly flat design prevents upward light, and the OPTIFLUX™ lens optics meet current lighting standards. To optimize the light distribution for varying road geometries and/or glare restrictions, the tilt angle can easily be adjusted on installation.

Product data

General Information			
Lamp family code	ECO39 [LED EconomyLine 3900 lm]	CE mark	Yes
Light source replaceable	Yes	Warranty period	5 years
Number of gear units	1 unit	Flammability mark	-
Driver included	Yes	ENEC mark	ENEC mark
Remarks	* At extreme ambient temperatures the luminaire might automatically dim down to protect components	Glow-wire test	Temperature 850 °C, duration 5 s
Light source engine type	LED	EU RoHS compliant	No
Product family code	BGP615 [LUMA MICRO]	Light Technical	
Lighting Technology	LED	Upward light output ratio	0
Embedded control	-	Luminous Flux	3,432 lm
		Standard tilt angle posttop	0°
		Standard tilt angle side entry	0°

Luma Micro

Correlated Color Temperature (Nom)	4000 K
Luminous Efficacy (rated) (Nom)	100.9 lm/W
Color rendering index (CRI)	70
Number of light sources	20
Light source color	Neutral white
Optical cover type	Flat glass
Luminaire light beam spread	154°
Optic type outdoor	Optiflux version R1

Operating and Electrical

Input Voltage	220 to 240 V
Line Frequency	50 to 60 Hz
Inrush current	22 A
Inrush time	0.29 ms
Power Consumption	29 W
Power Factor (Fraction)	0.98
Connection	Screw connection block 3-pole
Cable	-
Number of products on MCB of 16 A type B 20	

Temperature

Ambient temperature range	-40 to +50 °C
---------------------------	---------------

Controls and Dimming

Dimmable	No
Driver/power unit/transformer	Power supply unit (On/Off)
Constant light output	No

Mechanical and Housing

Housing Material	Aluminum
Reflector material	Polycarbonate
Optic material	Polycarbonate
Optical cover material	Glass
Fixation material	Aluminum
Housing Color	Grey
Mounting device	Spigot for diameter 62 mm

Optical cover shape	Flat
Optical cover finish	Clear
Overall length	622 mm
Overall width	290 mm
Overall height	130 mm
Effective projected area	0.049 m²
Dimensions (Height x Width x Depth)	130 x 290 x 622 mm

Approval and Application

Ingress protection code	IP66 [Dust penetration-protected, jet-proof]
Mech. impact protection code	IK09 [10 J]
Surge Protection (Common/Differential)	Philips standard surge protection level
Protection class IEC	Safety class II

Initial Performance (IEC Compliant)

Luminous flux tolerance	+/-7%
Initial chromaticity	(0.381, 0.379) SDCM <5
Power consumption tolerance	+/-10%
Init. Color Rendering Index Tolerance	+/-2

Over Time Performance (IEC Compliant)

Driver failure rate at 5000 h	0.5 %
-------------------------------	-------

Product Data

Order product name	BGP615 ECO39/NW PSU II OFR1 GR 62
Full product name	BGP615 ECO39/NW PSU II OFR1 GR 62
Full product code	871869634028800
Order code	34028800
Material Nr. (12NC)	910925439745
Numerator - Quantity Per Pack	1
EAN/UPC - Product/Case	8718696340288
Numerator - Packs per outer box	1
EAN/UPC - Case	8718696340288

Dimensional drawing

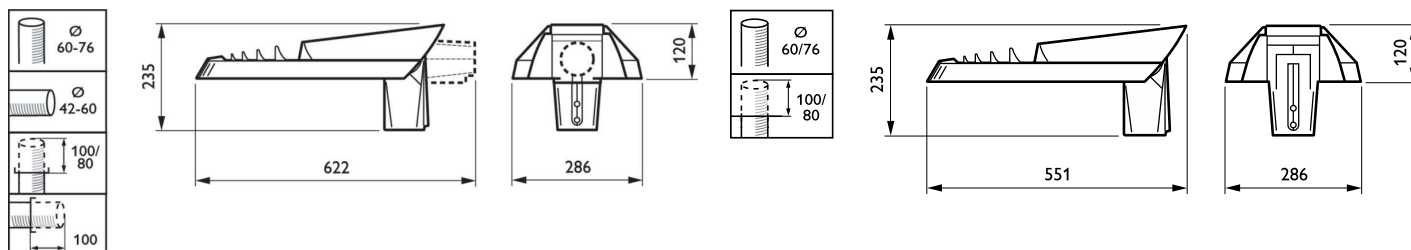

Luma Micro

Dimensional drawing

