



X-tend TPS498 C

TPS498 C 2xTL5-28W HFE D/I M6 FTB

2, TL5, 28 W, HF Standard, Matt optic double parabolic louver closed, Fused terminal block

X-tend surface and suspended-mounted luminaires The Philips X-tend family of surface and suspended-mounted luminaires has the perfect combination of cutting-edge technology, functional brilliance and aesthetic appeal. The secret behind X-tend's superb lighting qualities lies in its optic - based on specially designed 3-dimensional curves that offer highly efficient light distribution. X-tend meets most ceiling void restrictions, allowing architects and engineers ultimate design flexibility. TPS498 These range of high-performance luminaires is suitable for TL-D or TL5 fluorescent lamps and a wide range of optics. Optics are supplied with the luminaire on request with a choice of direct, direct/indirect lighting. Optics for asymmetrical lighting can be used in combination with a top mirror for higher performance on request. Straight coupling pieces allow connection of luminaires in a line. There are two different top covers: cover-solid and PC-indirect (D/I version). The luminaire is developed with ease of installation in mind, it can be suspended without removing the optic and lamp during installation.

Product data

| General Information | |
|-------------------------|---|
| Lamp family code | TL5 [TL5] |
| Gear | HFE [HF Standard] |
| Light Technical | |
| Number of light sources | 2 |
| Light source color | - |
| Optic type | Matt optic double parabolic louver closed |

| Operating and Electrical | |
|--------------------------|-----------------------------------|
| Power Consumption | 28 W |
| Cable | - |
| Approval and Application | |
| Ingress protection code | IP20 [Finger-protected] |
| Product Data | |
| Order product name | TPS498 C 2xTL5-28W HFE D/I M6 FTB |
| Full product name | TPS498 C 2xTL5-28W HFE D/I M6 FTB |

X-tend TPS498 C

| | |
|-------------------------------|---------------|
| Full product code | 911400630780 |
| Order code | 911400630780 |
| Material Nr. (12NC) | 911400630780 |
| Numerator - Quantity Per Pack | 1 |
| EAN/UPC - Product/Case | 8718291994657 |

| | |
|---------------------------------|---------------|
| Numerator - Packs per outer box | 1 |
| EAN/UPC - Case | 8718291994657 |

Dimensional drawing

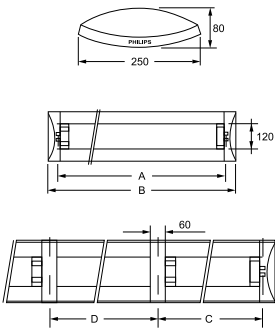

| Product | A | B | C | D |
|-----------------------------------|----------|----------|----------|----------|
| TPS498 C 2xTL5-28W HFE D/I M6 FTB | 1,188 mm | 1,286 mm | 1,208 mm | 1,228 mm |

