



X-tend TPS498 C

TPS498 C 2xTL-D36W HFP D/I C6

2, MASTER TL-D, 36 W, Electronic Primalume, High-gloss optic double parabolic closed

X-tend surface and suspended-mounted luminaires The Philips X-tend family of surface and suspended-mounted luminaires has the perfect combination of cutting-edge technology, functional brilliance and aesthetic appeal. The secret behind X-tend's superb lighting qualities lies in its optic - based on specially designed 3-dimensional curves that offer highly efficient light distribution. X-tend meets most ceiling void restrictions, allowing architects and engineers ultimate design flexibility. TPS498 These range of high-performance luminaires is suitable for TL-D or TL5 fluorescent lamps and a wide range of optics. Optics are supplied with the luminaire on request with a choice of direct, direct/indirect lighting. Optics for asymmetrical lighting can be used in combination with a top mirror for higher performance on request. Straight coupling pieces allow connection of luminaires in a line. There are two different top covers: cover-solid and PC-indirect (D/I version). The luminaire is developed with ease of installation in mind, it can be suspended without removing the optic and lamp during installation.

Product data

| General Information | | Operating and Electrical | |
|-------------------------|--|--------------------------|-------------------------------|
| Lamp family code | TL-D [MASTER TL-D] | Power Consumption | 36 W |
| Gear | EBP [Electronic Primalume] | Cable | - |
| Light Technical | | Approval and Application | |
| Number of light sources | 2 | Ingress protection code | IP20 [Finger-protected] |
| Light source color | - | Product Data | |
| Optic type | High-gloss optic double parabolic closed | Order product name | TPS498 C 2xTL-D36W HFP D/I C6 |
| | | Full product name | TPS498 C 2xTL-D36W HFP D/I C6 |

X-tend TPS498 C

| | |
|-------------------------------|--------------|
| Full product code | 911400638880 |
| Order code | 911400638880 |
| Material Nr. (12NC) | 911400638880 |
| Numerator - Quantity Per Pack | 1 |

| | |
|---------------------------------|---|
| Numerator - Packs per outer box | 1 |
|---------------------------------|---|

Dimensional drawing

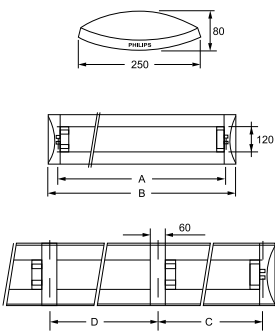

| Product | A | B | C | D |
|-------------------------------|----------|----------|----------|----------|
| TPS498 C 2xTL-D36W HFP D/I C6 | 1,240 mm | 1,388 mm | 1,260 mm | 1,280 mm |

