



SmartBright Highbay

BY218P LED180/NW PSU

Neutral white, Power supply unit (On/Off)

SmartBright Essential Highbay is a high efficient and reliable LED luminaire, designed for industrial application without humid and dust protection requirements. It enables point to point replacement of HID conventional luminaires, and delivers significant energy savings of up to 64% as compared to HID lamp system. With the innovation of micro prism structure optical plate, it provides an excellent glare control and smooth uniform lighting surface, which effectively improve the comfort of your environment.

Product data

General Information		Light source color	
Light source replaceable	No		Neutral white
Number of gear units	2 units	Optic type	Wide beam
Gear	-	Optical cover type	Micro-lens optic in polycarbonate cover
Driver included	Yes	Luminaire light beam spread	105°
Glow-wire test	Temperature 650 °C, duration 30 s	Operating and Electrical	
Flammability mark	-	Input Voltage	220-240 V
CE mark	CE mark	Line Frequency	50 to 60 Hz
ENEC mark	-	Inrush current	65 A
Warranty period	3 years	Inrush time	0.39 ms
EU RoHS compliant	No	Power Consumption	200 W
		Power Factor (Fraction)	0.9
		Connection	Flying leads/wires
		Cable	Cable 0.3 m without plug
		Number of products on MCB of 16 A type B	5
Light Technical			
Luminous Flux	18,000 lm		
Correlated Color Temperature (Nom)	4000 K		
Luminous Efficacy (rated) (Nom)	90 lm/W		
Color rendering index (CRI)	>75		
Beam angle of light source	120 degree(s)		

SmartBright Highbay

Temperature

Ambient temperature range	-20 to +40 °C
---------------------------	---------------

Controls and Dimming

Dimmable	No
Driver/power unit/transformer	Power supply unit (On/Off)
Constant light output	No

Mechanical and Housing

Housing Material	Steel
Reflector material	-
Optic material	Polycarbonate
Optical cover material	Polycarbonate
Fixation material	-
Housing Color	Gray and gray
Optical cover finish	Frosted
Overall height	147 mm
Overall diameter	369 mm

Approval and Application

Ingress protection code	IP20 [Finger-protected]
Mech. impact protection code	IK03 [0.3 J]
Protection class IEC	Safety class I

Initial Performance (IEC Compliant)

Luminous flux tolerance	+/-7.5%
-------------------------	---------

Initial chromaticity	(0.38, 0.38) SDCM <5
Power consumption tolerance	+/-10%

Over Time Performance (IEC Compliant)

Driver failure rate at 5000 h	1%
Median useful life L70B50	25,000 hour(s)
Median useful life L80B50	20,000 hour(s)
Median useful life L90B50	15,000 hour(s)

Application Conditions

Suitable for random switching	No
-------------------------------	----

Product Data

Order product name	BY218P LED180/NW PSU
Full product name	BY218P LED180/NW PSU
Full product code	697013372997700
Order code	911401560321
Material Nr. (12NC)	911401560321
Numerator - Quantity Per Pack	1
EAN/UPC - Product/Case	6970133729977
Numerator - Packs per outer box	1
EAN/UPC - Case	6970133729977

Dimensional drawing

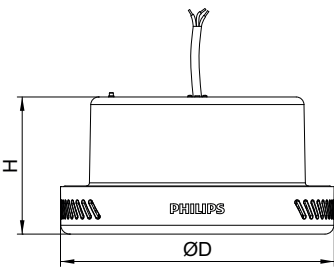

	D	H
BY218P LED180	369	147
BY218P LED90	277	139
BY218P LED50	231	124
BY258P LED180	369	147
BY258P LED90	277	139
BY258P LED50	231	124

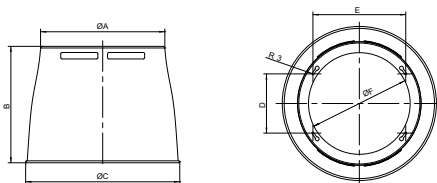
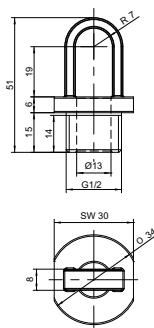

Type	A	B	C	D	E	F
BY218Z RL-L	385	361	478	183.5	287.6	315
BY218Z RL-M	292	283	372	141.5	210.4	230
BY218Z RL-S	246	233	317	114.9	175.7	193

