



Vaya Flood LP Small

BCP432 4000 100-240 10 CE CQC PSE

Narrow beam angle 10°

With budgets under pressure, property owners and developers are looking, more than ever, for value for money when it comes to capital expenditures. Vaya Flood is an affordable and reliable LED solution that minimizes the initial investment, while providing exceptional flexibility to create eye-catching, dynamic and colourful lighting effects that can bring a property to life. The robust Vaya Flood offers a wide choice of mono colours with a simple on-off switch and changing colours with a standard DMX512 controller. It is also extremely easy to install and aim.

Product data

General Information		Controls and Dimming	
Lamp family code	LED-HB [LED High Brightness]	Dimmable	yes
Light source colour	Neutral white	Mechanical and Housing	
Light source replaceable	No	Housing material	Aluminium die-cast
Driver included	Yes	Optic material	Glass
Optical cover/lens type	GT [Tempered glass]	Optical cover/lens material	Tempered glass
Luminaire light beam spread	10°	Optical cover/lens shape	Flat
Protection class IEC	Safety class I	Optical cover/lens finish	Clear
CE mark	CE mark	Colour	Dark Grey
CQC mark	CQC-mark	Approval and Application	
Outdoor optic type	Narrow beam angle 10°	Ingress protection code	IP66 [Dust penetration-protected, jet-proof]
PSE mark	PSE mark	Mech. impact protection code	IK06 [1 J]
Angle	10°	Vibration standard	Complies with ANSI C136.31
Operating and Electrical			Complies with ANSI C136.31
Input voltage	100 to 240 V		
Input frequency	50 to 60 Hz		

Vaya Flood LP Small

Initial Performance (IEC Compliant)

Initial luminous flux	3797 lm
Initial luminous flux at color temperature of 4000 K	3797 lm
Initial LED luminaire efficacy	87.9 lm/W
Init. Corr. colour temperature	4000 K
Init. colour rendering index	82
Initial input power	44 W

Over Time Performance (IEC Compliant)

Lumen Maintenance 70% at 25°C Calculated	71000
Lumen Maintenance 70% at 25°C Reported	60000
Lumen Maintenance 70% at 40°C Calculated	71000
Lumen Maintenance 70% at 40°C Reported	60000
Lumen Maintenance 80% at 25°C Calculated	45000
Lumen Maintenance 80% at 25°C Reported	45000
Lumen Maintenance 80% at 40°C Calculated	45000
Lumen Maintenance 80% at 40°C Reported	45000
Lumen Maintenance 90% at 25°C Calculated	23000

Lumen Maintenance 90% at 25°C Reported	23000
Lumen Maintenance 90% at 40°C Calculated	23000
Lumen Maintenance 90% at 40°C Reported	23000

Application Conditions

Ambient temperature range	-40 to +40 °C
---------------------------	---------------

Product Data

Full product code	871829164739399
Order product name	BCP432 4000 100-240 10 CE CQC PSE
EAN/UPC – product	8718291647393
Order code	64739399
Numerator – quantity per pack	1
Numerator – packs per outer box	4
Material no. (12NC)	912400133927
Net weight (piece)	2.770 kg



Dimensional drawing

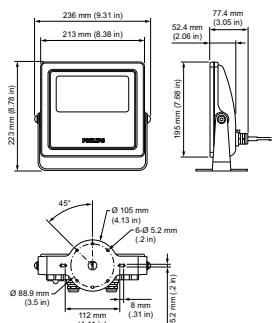

Vaya

