



Vaya Flood LP

BCP431 RGB 100-240 40 UL

Medium beam angle 40°

Vaya Flood LP (gen2) is a reliable and cost effective LED flood lighting solution for both interior and exterior use that minimizes the initial investment, while providing exceptional flexibility to create eye-catching flood, wash and accent lighting effects. A wide choice of beam angles and color options let you bring a property to life with either static or dynamically changing colors. Extended light throw and high efficacy set this compact & robust luminaire apart. Its integrated power and adjustable tilt angle make this product versatile and easy to use.

Product data

General Information		Controls and Dimming	
Lamp family code	LED-HB [LED High Brightness]	Dimmable	Yes
Light source color	Red, green and blue	Mechanical and Housing	
Light source replaceable	No	Housing Material	Aluminum die cast
Driver included	Yes	Optic material	Glass
Optical cover/lens type	Tempered glass	Optical cover/lens material	Tempered glass
Protection class IEC	Safety class I	Optical cover/lens shape	Flat
UL mark	UL and cUL mark	Optical cover/lens finish	Clear
Optic type outdoor	Medium beam angle 40°	Color	Dark gray
PSE mark	No	Approval and Application	
FCC mark	FCC Class A	Ingress protection code	IP66 [Dust penetration-protected, jet-proof]
Angle	40°	Mech. impact protection code	IK06 [1 J]
Operating and Electrical		Vibration Standard	Complies with ANSI C136.31
Input Voltage	100 to 240 V	Vibration Rating	Complies with ANSI C136.31
Input Frequency	50 to 60 Hz		

Vaya Flood LP

Initial Performance (IEC Compliant)

Initial luminous flux (system flux)	1400 lm
Initial LED luminaire efficacy	34.7 lm/W
Initial input power	45 W

Over Time Performance (IEC Compliant)

Lumen Maintenance 50% at 25°C Calculated	100000
Lumen Maintenance 50% at 25°C Reported	60000
Lumen Maintenance 50% at 40°C Calculated	100000
Lumen Maintenance 50% at 40°C Reported	60000
Lumen Maintenance 70% at 25°C Calculated	100000
Lumen Maintenance 70% at 25°C Reported	60000
Lumen Maintenance 70% at 40°C Calculated	100000
Lumen Maintenance 70% at 40°C Reported	60000

Application Conditions

Ambient temperature range	-40 to +40 °C
---------------------------	---------------

Product Data

Full product code	871829164711999
Order product name	BCP431 RGB 100-240 40 UL
EAN/UPC - Product	8718291647119
Order code	912400133976
Numerator - Quantity Per Pack	1
Numerator - Packs per outer box	4
Material Nr. (12NC)	912400133976
Net Weight (Piece)	2.800 kg



Dimensional drawing

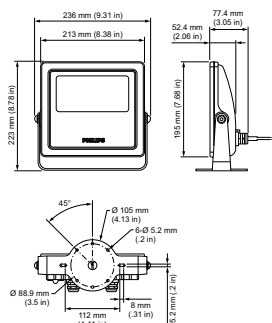

Vaya

