



eW Graze MX Powercore

eW Graze MX Powercore, 3000 K, 10° x 60° Beam Angle, 305 mm (1 ft)

eW Graze MX Powercore, 3000 K, 10° x 60° Beam Angle, 305 mm (1 ft)

eW Graze MX Powercore is a high-performance, exterior linear luminaire that features the most light output in our line of solid white light grazing luminaires. It is designed to highlight architectural features ranging from surface textures and molding details to archways and windows. Graze Essential White luminaires offer a single channel of white light. Available in 2700 K, 3000 K, 3500 K, 4000 K, and 5500 K. Multiple luminaire lengths, beam angles, output levels, and power consumption levels support a large range of façade or surface illumination applications. Low-profile housing, connectorized cabling, a universal power input range, and direct line voltage operation make Graze luminaires easy to install and operate.

Product data

General information	
Lamp family code	LED-HB [LED High Brightness]
Light source color	White
Light source replaceable	No
Luminaire light beam spread	10° x 60°
Protection class IEC	Safety class I
CE mark	CE mark
UL mark	UL and cUL mark
Lifetime to 70% luminous flux	60000 h

Operating and electrical	
Input Voltage	100 to 277 V
Input Frequency	50 to 60 Hz
Mechanical and housing	
Housing Material	Aluminum extruded
Optical cover/lens material	Polycarbonate
Approval and application	
Ingress protection code	IP66 [Dust penetration-protected, jet-proof]

eW Graze MX Powercore

Mech. impact protection code	IK10 [20 J vandal-resistant]
Vibration Standard	Complies with ANSI C136.31, 3G
Corrosion Resistance	Complies with ASTM B117 standard with special order. Please contact your Color Kinetics Lighting Sales rep for custom configurations.
FCC mark	FCC Class A
Vibration Rating	Complies with ANSI C136.31, 3G

Initial performance (IEC compliant)

Init. Corr. Color Temperature	3000 K
Initial input power	15 W

Over time performance (IEC compliant)

Lumen Maintenance 50% at 25°C Reported	60000
Lumen Maintenance 50% at 50°C Reported	60000
Lumen Maintenance 70% at 25°C Reported	60000
Lumen Maintenance 70% at 50°C Reported	60000

Application conditions

Ambient temperature range	-20 to +50 °C
---------------------------	---------------

Product data

Full product code	871829139459499
Order product name	BCS419 10x60-3000 L305
EAN/UPC - Product	8718291394594
Order code	523-000080-61
Numerator - Quantity Per Pack	1
Numerator - Packs per outer box	4
Material Nr. (12NC)	912400135114
Net Weight (Piece)	1.200 kg
Catalog Number	523-000080-61
Catalog Number Description	eW Graze MX Powercore, 3000 K, 10° x 60° Beam Angle, 305 mm (1 ft)



Dimensional drawing

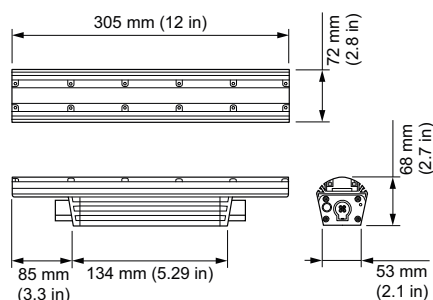

BCS419 10x60-3000 L305

