



# eW Graze QLX Powercore

BCS427 15x30-3500 L305

eW Graze QLX Powercore, 3500 K, 15° x 30° Beam Angle, 305 mm (1 ft)

Many architectural structures need a linear fixture capable of illuminating several storeys with minimal setback and reduced power consumption. Property owners/end users need a controllable product capable of dynamic illumination to draw attention to their establishments and emphasise their brands. Graze QLX Powercore is capable of illuminating over 10 metres at very close setback distances. Powercore technology enables simple installation and long product run lengths.

## Product data

General Information	
Lamp family code	LED-HB [ LED High Brightness]
Light source colour	White
Light source replaceable	No
Driver included	Yes
Optical cover/lens type	PCC [ Polycarbonate bowl/cover clear]
Luminaire light beam spread	15° x 30°
Protection class IEC	Safety class I
CE mark	CE mark
UL mark	UL and cUL mark
Controls and Dimming	
Dimmable	Yes

Mechanical and Housing	
Housing material	Extruded aluminium
Optical cover/lens material	Polycarbonate
Length	305 mm
Colour	Aluminium
Approval and Application	
Ingress protection code	IP66 [ Dust penetration-protected, jet-proof]
Mech. impact protection code	IK10 [ 20 J vandal-resistant]
Vibration standard	Complies with ANSI C136.31, 3G
Vibration rating	Complies with ANSI C136.31, 3G
Initial Performance (IEC Compliant)	
Init. Corr. Colour Temperature	3500 K

eW Graze QLX Powercore

Initial input power	15 W
<b>Over Time Performance (IEC Compliant)</b>	
Lumen Maintenance 50% at 25 °C Reported	60000
Lumen Maintenance 50% at 50 °C Reported	60000
Lumen Maintenance 70% at 25 °C Reported	60000
Lumen Maintenance 70% at 50 °C Reported	60000
<b>Application Conditions</b>	
Ambient temperature range	-40 to +50 °C
<b>Product Data</b>	
Full product code	871869921058899

Order product name	BCS427 15x30-3500 L305
EAN/UPC – product	8718699210588
Order code	523-000081-82
SAP numerator – quantity per pack	1
Numerator – packs per outer box	4
SAP material	912400135288
SAP net weight (piece)	1.200 kg
Commercial Code	523-000081-82
Catalogue number description	eW Graze QLX Powercore, 3500 K, 15° x 30° Beam Angle, 305 mm (1 ft)



Dimensional drawing

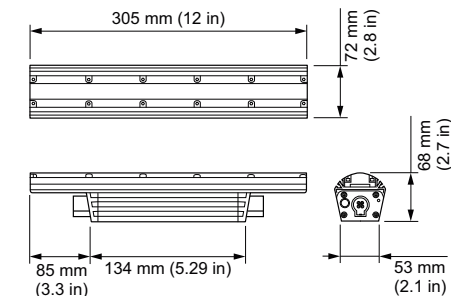

BCS427 15x30-3500 L305

