



FastSet, Surface Mounted

SM150C LED24S/830 PSU TW3 PI5 L602

830 warm white, Power supply unit (On/Off), Connection unit 5-pole

Upgrading to LED is a key trend in office applications. Recognizing the need for an easy to use luminaire that can work as the perfect 1:1 replacement of conventional office lighting, we developed FastSet. This luminaire is an ideal choice to quickly achieve the benefits of LED lighting since being the perfect 1:1 replacement, no additional lighting calculation is needed prior to the LED lighting installation. The luminaire simply fits into all different indoor applications. Moreover, it is available in both standalone and through-wiring versions, which makes the luminaires ready-to-connect at a later stage.

Product data

| General Information | | | |
|--------------------------|----------------------------------------------------------------------------------------------------------------------------------------------------------------------------------------------------------------------------------------------------------------------------------------|------------------------------------|---------------------------------------------|
| Light source replaceable | No | CE mark | Yes |
| Number of gear units | 1 unit | Warranty period | 5 years |
| Driver included | Yes | Flammability mark | For mounting on normally flammable surfaces |
| Remarks | *-Per Lighting Europe guidance paper "Evaluating performance of LED based luminaires - January 2018": statistically there is no relevant difference in lumen maintenance between B50 and for example B10. Therefore, the median useful life (B50) value also represents the B10 value. | ENEC mark | - |
| Lighting Technology | LED | Glow-wire test | Temperature 850 °C, duration 30 s |
| Value ladder | Performance | EU RoHS compliant | Yes |
| | | Light Technical | |
| | | Luminous Flux | 2,400 lm |
| | | Correlated Color Temperature (Nom) | 3000 K |
| | | Luminous Efficacy (rated) (Nom) | 120 lm/W |
| | | Color rendering index (CRI) | ≥80 |

FastSet, Surface Mounted

| | |
|-----------------------------|----------------|
| Beam angle of light source | 116 degree(s) |
| Light source color | 830 warm white |
| Optic type | Wide beam |
| Luminaire light beam spread | 100° |
| Unified glare rating CEN | 25 |

Operating and Electrical

| | |
|------------------------------------------|------------------------|
| Input Voltage | 220-240 V |
| Line Frequency | 50 to 60 Hz |
| Inrush current | 8 A |
| Inrush time | 0.06 ms |
| Power Consumption | 20 W |
| Power Factor (Fraction) | 0.9 |
| Connection | Connection unit 5-pole |
| Cable | - |
| Number of products on MCB of 16 A type B | 24 |

Temperature

| | |
|---------------------------|-------------|
| Ambient temperature range | 0 to +35 °C |
|---------------------------|-------------|

Controls and Dimming

| | |
|-------------------------------|----------------------------|
| Dimmable | No |
| Driver/power unit/transformer | Power supply unit (On/Off) |
| Constant light output | No |

Mechanical and Housing

| | |
|------------------------|---------------|
| Housing Material | Metal |
| Reflector material | - |
| Optic material | Polycarbonate |
| Optical cover material | Polycarbonate |
| Fixation material | Steel |
| Housing Color | White |
| Optical cover finish | Opal |
| Overall length | 602 mm |
| Overall width | 160 mm |

Dimensional drawing

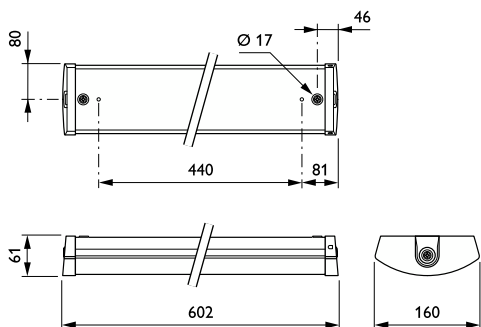

| | |
|-------------------------------------|-------------------|
| Overall height | 61 mm |
| Dimensions (Height x Width x Depth) | 61 x 160 x 602 mm |

Approval and Application

| | |
|------------------------------|-------------------------------------|
| Ingress protection code | IP44 [Wire-protected, splash-proof] |
| Mech. impact protection code | IK03 [0.3 J] |
| Sustainability rating | - |
| Protection class IEC | Safety class I |

Initial Performance (IEC Compliant)

| | |
|-----------------------------|------------------------|
| Luminous flux tolerance | +/-10% |
| Initial chromaticity | (0.4344, 0.4032) 5SDCM |
| Power consumption tolerance | +/-10% |

Over Time Performance (IEC Compliant)

| | |
|---------------------------------------------------------|-----|
| Control gear failure rate at median useful life 50000 h | 5 % |
| Lumen maintenance at median useful life* 50000 h | L80 |

Application Conditions

| | |
|------------------------------------|----------------|
| Performance ambient temperature Tq | 25 °C |
| Suitable for random switching | Not applicable |

Product Data

| | |
|---------------------------------|------------------------------------|
| Order product name | SM150C LED24S/830 PSU TW3 PI5 L602 |
| Full product name | SM150C LED24S/830 PSU TW3 PI5 L602 |
| Full product code | 871869938124099 |
| Order code | 38124099 |
| Material Nr. (12NC) | 912401483056 |
| Numerator - Quantity Per Pack | 1 |
| EAN/UPC - Product/Case | 8718699381240 |
| Numerator - Packs per outer box | 6 |
| EAN/UPC - Case | 8718699381301 |

FastSet, Surface Mounted

