

HID-HeavyDuty BHL for HPL/HPI

BHL 250 L40 230V 50Hz HD2-126

Encapsulated electromagnetic copper/iron ballasts for HPL and HPI (Plus) lamps

Product data

| | | | | |
|---------------------------------|----------------------------------|--|--|-------------------------------|
| Operating and Electrical | | Full product name | | BHL 250 L40 230V 50Hz HD2-126 |
| Input Voltage | 230 V | Full product code | | 871150091950230 |
| Line Frequency | 50 Hz | Order code | | 91950230 |
| Input Frequency | 50 Hz | Material Nr. (12NC) | | 913603920426 |
| | | Numerator - Quantity Per Pack | | 1 |
| | | EAN/UPC - Product/Case | | 8711500919502 |
| | | Numerator - Packs per outer box | | 6 |
| | | EAN/UPC - Case | | 8711500934604 |
| | | | | |
| Wiring | | | | |
| Connector Type | Screw | | | |
| | | | | |
| Approval and Application | | | | |
| Approval Marks | CE marking ENEC certificate | | | |
| | | | | |
| Product Data | | | | |
| Order product name | BHL 250 L40-A2 230V 50Hz HD2-126 | | | |

HID-HeavyDuty BHL for HPL/HPI

Dimensional drawing

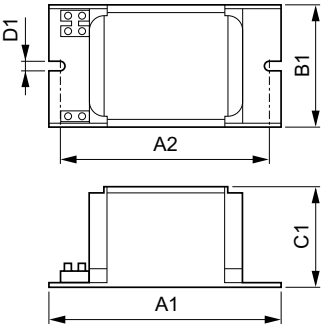

| Product | D1 | C1 | A1 | A2 | B1 |
|--------------------------|--------|---------|----------|----------|---------|
| BHL 250 L40-A2 230V 50Hz | 6.2 mm | 66.0 mm | 126.0 mm | 107.5 mm | 81.0 mm |
| HD2-126 | | | | | |

