



HID-HighPower for SON/MH/HPL/HPI

BHL 1000 L78 230/240V 50HZ HP-207

Encapsulated ballasts for use with SON (T) (Plus), HPL, HPI and MH lamps with rated wattages of 1000 W and above

Product data

Operating and Electrical	
Input Voltage	230 V (default) or 240 V
Line Frequency	50 Hz
Input frequency	50 Hz
Wiring	
Connector type	Screw
Approval and Application	
Approval marks	CE marking ENEC certificate
Product Data	
Order product name	BHL 1000 L78-A2 230/240V 50Hz HP-207

Full product name	BHL 1000 L78 230/240V 50HZ HP-207
Full EOC	871150006237600
Order code	06237600
Material no. (12 NC)	913700217303
Local order code	BHL1000L78
SAP numerator – quantity per pack	1
EAN/UPC — Product/Case	8711500996657
Numerator – packs per outer box	1
EAN/UPC - Case	8711500062376

HID-HighPower for SON/MH/HPL/HPI

Dimensional drawing

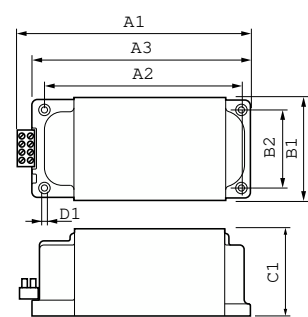

Product	D1	C1	A1	A2	A3	B1	B2
BHL 1000 L78-A2	6.5	102.0	207.0	172.0	196.0	117.0	88.0
230/240V 50Hz	mm	mm	mm	mm	mm	mm	mm
HP-207							

