



HID-HighPower for SON/MH/HPL/HPI

BHL 1000 L02-A2 220V 50Hz HP-207

Encapsulated ballasts for use with SON (T) (Plus), HPL, HPI and MH lamps with rated wattages of 1000 W and above

Product data

| | | | | | |
|---------------------------------|----------------------------------|--|--|----------------------------------|--|
| Operating and Electrical | | Full product name | | BHL 1000 L02-A2 220V 50Hz HP-207 | |
| Input Voltage | 220 V | Full product code | | 871150006231400 | |
| Line Frequency | 50 Hz | Order code | | 913700218403 | |
| Input Frequency | 50 Hz | Material Nr. (12NC) | | 913700218403 | |
| Wiring | | Numerator - Quantity Per Pack | | 1 | |
| Connector Type | Screw | EAN/UPC - Product/Case | | 8711500996626 | |
| Approval and Application | | Numerator - Packs per outer box | | 1 | |
| Approval Marks | CE marking ENEC certificate | EAN/UPC - Case | | 8711500062314 | |
| Product Data | | | | | |
| Order product name | BHL 1000 L02-A2 220V 50Hz HP-207 | | | | |

HID-HighPower for SON/MH/HPL/HPI

Dimensional drawing

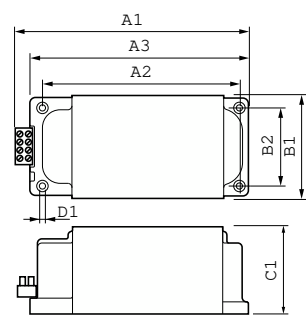

| Product | D1 | C1 | A1 | A2 | A3 | B1 | B2 |
|-----------------|--------|-------|-------|-------|-------|-------|------|
| BHL 1000 L02-A2 | 6.5 mm | 102.0 | 207.0 | 172.0 | 196.0 | 117.0 | 88.0 |
| 220V 50Hz | | mm | mm | mm | mm | mm | mm |
| HP-207 | | | | | | | |

