



# HID-Basic BHL MK4 for HPL/HPI

## BHL 250 K327-A2 230/240V 50Hz BC2-134

Impregnated electromagnetic copper/iron ballasts for HPL, HPI (Plus) and SON-H lamps

### Product data

<b>Operating and Electrical</b>		<b>Full product name</b>		BHL 250 K327-A2 230/240V 50Hz BC2-134
Input Voltage	230 V (default) or 240 V	<b>Full product code</b>		872790088917800
Line Frequency	50 Hz	<b>Order code</b>		913700278127
Input Frequency	50 Hz	<b>Material Nr. (12NC)</b>		913700278127
		<b>Numerator - Quantity Per Pack</b>		1
		<b>EAN/UPC - Product/Case</b>		8711500998996
		<b>Numerator - Packs per outer box</b>		415
		<b>EAN/UPC - Case</b>		8727900889178
<b>Approval and Application</b>				
Approval Marks	CE marking ENEC certificate			
<b>Product Data</b>				
Order product name	BHL 250 K327-A2 230/240V 50Hz BC2-134			

# HID-Basic BHL MK4 for HPL/HPI

## Dimensional drawing

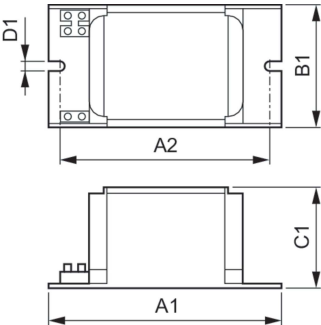

Product	D1	C1	A1	A2	B1
BHL 250 K327-A2 230/240V 50Hz	6.2 mm	65.0 mm	134.0 mm	113.0 mm	76.0 mm
BC2-134					

