

HID-Basic BHL MK4 for HPL/HPI

BHL 80/125 K407 230/240V 50Hz BC1-118

Impregnated electromagnetic copper/iron ballasts for HPL, HPI (Plus) and SON-H lamps

Product data

Operating and Electrical	
Input Voltage	230 V (default) or 240 V
Line Frequency	50 Hz
Input Frequency	50 Hz
Wiring	
Connector Type	Screw
Approval and Application	
Approval Marks	CE marking ENEC certificate
Product Data	
Order product name	BHL 80/125 K407 230/240V 50Hz BC1-118

Full product name	BHL 80/125 K407 230/240V 50Hz BC1-118
Full product code	872790094013800
Order code	913700280226
Material Nr. (12NC)	913700280226
Numerator - Quantity Per Pack	1
EAN/UPC - Product/Case	8727900940138
Numerator - Packs per outer box	6
EAN/UPC - Case	8727900940145

HID-Basic BHL MK4 for HPL/HPI

Dimensional drawing

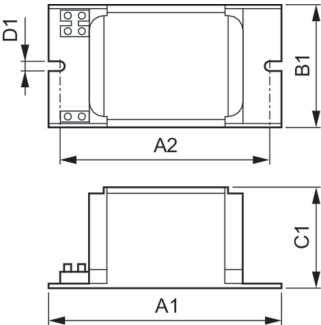

Product	D1	C1	A1	A2	B1
BHL 80/125 K407 230/240V 50Hz	6.2 mm	52.0 mm	118.0 mm	94.0 mm	61.0 mm
BC1-118					

