



HID-Basic BSN/BMH semi-parallel for SON/CDO/CDM/MH/ HPI

BSN 150 K302-I 230V 50Hz BC2-126

Impregnated electromagnetic copper ballasts for use with an external semi-parallel ignitor for CDM, CDO, MH, HPI (Plus) and SON lamps

Product data

Operating and Electrical	
Input Voltage	230 V
Line Frequency	50 Hz
Input Frequency	50 Hz
Wiring	
Connector Type	Screw
Approval and Application	
Approval Marks	CE marking ENEC certificate
Product Data	
Order product name	BSN 150 K302-I 230V 50Hz BC2-126

Full product name	BSN 150 K302-I 230V 50Hz BC2-126
Full product code	872790092827300
Order code	913700283026
Material Nr. (12NC)	913700283026
Numerator - Quantity Per Pack	1
EAN/UPC - Product/Case	8727900928273
Numerator - Packs per outer box	6
EAN/UPC - Case	8727900928280

HID-Basic BSN/BMH semi-parallel for SON/CDO/CDM/MH/HPI

Dimensional drawing

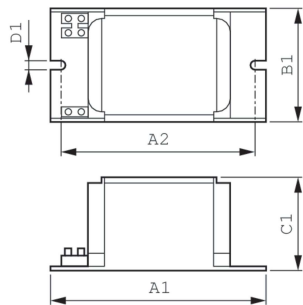

Product	C1	A1	B1
BSN 150 K302-I 230V 50Hz BC2-126	65.0 mm	126.0 mm	76.0 mm

